

## UCP

Cylindrical bore (with set screws)  
d (45) ~ (75) mm

With Pressed Steel Cover

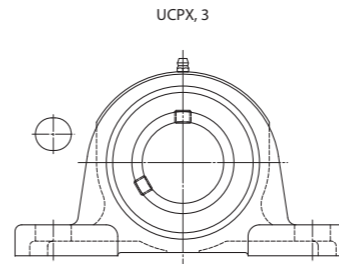
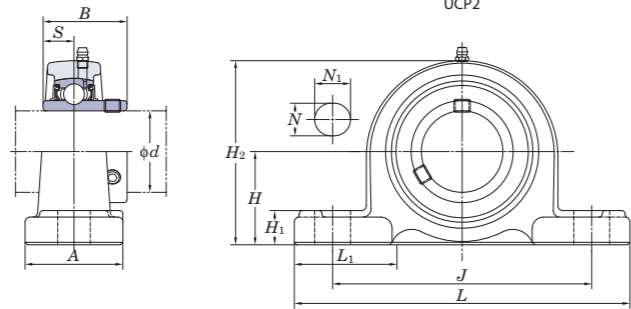
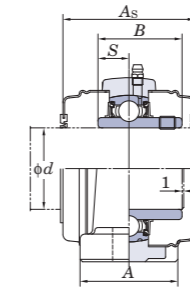

With Cast Iron Cover

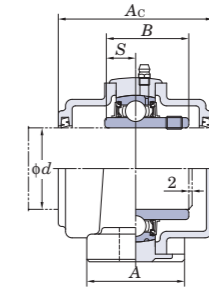
Variations of tolerance of distance from mounting bottom to center of spherical bore ( $\Delta H_B$ )

Housing No.		$\Delta H_B$
P203~P210	PX05~PX10	+0.15
P211~P218	PX11~PX18	+0.2
P219~P228	PX19~PX28	+0.3

Forms and dimensions of  $H_{2c}$  of P204JE3 and P205JE3 (housing with cast iron cover) are shown below.

Shaft Dia. mm inch	Dimensions inch mm											Bolt Size inch mm	Standard			Basic Load Ratings kN	Factor	With Pressed Steel Cover				With Cast Iron Cover																						
	H	L	A	J	N	N <sub>1</sub>	H <sub>1</sub>	H <sub>2</sub>	L <sub>1</sub>	B	S		Unit No.	Housing No.	Bearing No.			Mass	C <sub>r</sub>	C <sub>0r</sub>	f <sub>0</sub>	Unit No.	Dimension	Mass	Unit No.	Dimension	Mass																	
d															kg					Open Type	One Side Closed Type	mm	inch	kg	Open Type	One Side Closed Type	mm	inch	kg															
45	1 3/4	2 41/64 67	9 21/32 245	2 5/8 67	7 15/32 190	25/32 20	1 3/16 30	13/16 21	5 3/16 132	2 15/16 75	2.244 57	0.866 22	5/8 M16	UCP309-28 UCP309	P309	UC309-28 UC309	4.9 4.9	48.9	29.5	13.3	-	-	-	-	-	-	-	-	-	-	-	-	-	-										
50	1 7/8	-	-	-	-	-	-	-	-	-	-	-	-	-	-	-	-	-	-	-	-	-	-	-	-	-	-	-	-	-	-	-	-											
	1 15/16	2 1/4	8 1/8	2 3/8	6 1/4	25/32	7/8	13/16	4 7/16	2 3/8	2.031	0.748	5/8	UCP210-30 UCP210-31 UCP210 UCP210-32	P210	UC210-30 UC210-31 UC210 UC210-32	2.9 2.9 2.9 2.9	35.1	23.3	14.4	-	-	-	-	-	-	-	-	-	-	-	-	-	-	-									
	2	-	-	-	-	-	-	-	-	-	-	-	-	-	-	-	-	-	-	-	-	-	-	-	-	-	-	-	-	-	-	-	-	-										
	1 15/16	2 1/2	9 1/2	2 7/8	6 23/32	25/32	1 13/32	7/8	4 31/32	3	2.189	0.874	5/8	UCPX10-31 UCPX10 UCPX10-32	PX10	UCX10-31 UCX10 UCX10-32	4.6 4.6 4.6	43.4	29.4	14.4	UCPX10C	UCPX10CD	74	2 29/32	2.9	UCP210FC	UCP210FCD	97	3 13/16	3.9	-	-	-	-	-	-								
55	2	2 61/64	10 13/16	2 15/16	8 11/32	25/32	1 3/8	15/16	5 13/16	3 15/32	2.402	0.866	5/8	UCP310	P310	UC310	6.6	62.0	38.3	13.2	-	-	-	-	-	-	-	-	-	-	-	-	-	-										
	2 1/8	2 1/2	8 5/8	2 3/8	6 23/32	25/32	7/8	29/32	4 29/32	2 9/16	2.189	0.874	5/8	UCP211-32 UCP211-34 UCP211 UCP211-35	P211	UC211-32 UC211-34 UC211 UC211-35	3.6 3.6 3.6 3.6	43.4	29.4	14.4	UCP211C	UCP211CD	76	3	3.6	UCP211FC	UCP211FCD	99	3 29/32	4.8	-	-	-	-	-	-	-	-						
	2 3/16	-	-	-	-	-	-	-	-	-	-	-	-	-	-	-	-	-	-	-	-	-	-	-	-	-	-	-	-	-	-	-	-	-	-									
	2 1/4	2 3/4	10 1/4	3 1/8	7 1/4	31/32	1 13/32	1 3/32	5 15/32	3 9/32	2.563	1.000	3/4	UCPX11 UCPX11-35 UCPX11-36	PX11	UCX11 UCX11-35 UCX11-36	6.5 6.5 6.5	52.4	36.2	14.4	UCPX11C	UCPX11CD	89	3 1/2	6.5	-	-	-	-	-	-	-	-	-	-	-	-	-	-	-	-			
60	2 1/4	3 5/32	12 7/32	3 5/32	9 9/32	25/32	1 1/2	1 1/16	6 7/32	3 17/32	2.598	0.984	5/8	UCP311-32 UCP311 UCP311-35	P311	UC311-32 UC311 UC311-35	7.9 7.9 7.9	71.6	45.0	13.2	-	-	-	-	-	-	-	-	-	-	-	-	-	-	-	-	-	-	-					
	2 3/8	2 3/4	9 1/2	2 3/4	7 1/4	25/32	31/32	31/32	5 7/16	2 7/8	2.563	1.000	5/8	UCP212-36 UCP212 UCP212-38 UCP212-39	P212	UC212-36 UC212 UC212-38 UC212-39	4.9 4.9 4.9 4.9	52.4	36.2	14.4	UCP212C	UCP212CD	89	3 1/2	4.9	UCP212FC	UCP212FCD	114	4 1/2	6.4	-	-	-	-	-	-	-	-	-	-	-	-	-	
	2 7/16	3	11 1/4	3 1/4	8	31/32	1 9/16	1 3/32	5 31/32	3 15/32	2.563	1.000	3/4	UCPX12 UCPX12-39	PX12	UCX12 UCX12-39	7.7 7.7	57.2	40.1	14.4	UCPX12C	UCPX12CD	89	3 1/2	7.7	-	-	-	-	-	-	-	-	-	-	-	-	-	-	-	-	-		
	2 7/8	3 11/32	13	3 11/32	9 27/32	31/32	1 1/2	1 5/32	6 9/16	4 1/16	2.795	1.024	3/4	UCP312 UCP312-39	P312	UC312 UC312-39	9.5 9.5	81.9	52.2	13.2	-	-	-	-	-	-	-	-	-	-	-	-	-	-	-	-	-	-	-	-	-	-		
65	2 1/2	3	10 7/16	2 3/4	8	31/32	1 3/16	1 1/16	5 29/32	3 1/16	2.563	1.000	3/4	UCP213-40 UCP213	P213	UC213-40 UC213	5.9 5.9	57.2	40.1	14.4	-	-	-	-	-	-	-	-	-	-	-	-	-	-	-	-	-	-	-	-	-			
	2 1/2	3	11 1/4	3 1/4	8	31/32	1 9/16	1 3/32	6 3/32	3 15/32	2.937	1.189	3/4	UCPX13-40 UCPX13	PX13	UCX13-40 UCX13	8.1 8.1	62.2	44.1	14.5	-	-	-	-	-	-	-	-	-	-	-	-	-	-	-	-	-	-	-	-				
	2 7/8	3 35/64	13 3/8	3 17/32	10 1/4	31/32	1 1/2	1 1/4	6 15/16	4 11/32	2.953	1.181	3/4	UCP313-40 UCP313	P313	UC313-40 UC313	10.7 10.7	92.7	59.9	13.2	-	-	-	-	-	-	-	-	-	-	-	-	-	-	-	-	-	-	-	-	-			
70	2 3/4	3 1/8	10 15/32	2 27/32	8 9/32	31/32	1 3/16	1 1/16	6 3/16	2 15/16	2.937	1.189	3/4	UCP214-44 UCP214	P214	UC214-44 UC214	6.8 6.8	62.2	44.1	14.5	-	-	-	-	-	-	-	-	-	-	-	-	-	-	-	-	-	-	-	-				
	2 3/4	3 1/2	13	3 1/2	9	1 1/16	1 31/32	1 1/4	6 23/32	3 27/32	3.063	1.331	7/8	UCPX14-44 UCPX14	PX14	UCX14-44 UCX14	10.2 10.2	67.4	48.3	14.5	UCPX14C	UCPX14CD	99	3 29/32	10.2	-	-	-	-	-	-	-	-	-	-	-	-	-	-	-	-	-		
	2 3/4	3 47/64	14 3/16	3 17/32	11 1/32	1 1/16	1 9/16	1 3/8	7 5/16	4 11/32	3.071	1.299	7/8	UCP314-44 UCP314	P314	UC314-44 UC314	12.4 12.4	104	68.2	13.2	-	-	-	-	-	-	-	-	-	-	-	-	-	-	-	-	-	-	-	-	-			
75	2 15/16	3 1/4	10 13/16	2 29/32	8 17/32	31/32	1 3/16	1 3/32	6 3/8	3 1/16	3.063	1.311	3/4	UCP215-47 UCP215 UCP215-48	P215	UC215-47 UC215 UC215-48	7.4 7.4 7.4	67.4	48.3	14.5	UCP215C	UCP215CD	99	3 29/32	7.4	UCP215FC	UCP215FCD	124	4 7/8	9.3	-	-	-	-	-	-	-	-	-	-	-	-	-	-
	3	-	-	-	-	-	-	-	-	-	-	-	-	-	-	-	-	-	-	-	-	-	-	-	-	-	-	-	-	-	-	-	-	-	-	-	-							
	2 15/16	3 1/2	13	3 1/2	9	1 1/16	1 31/32	1 1/4	6 7/8	3 29/32	3.252	1.311	7/8	UCPX15-47 UCPX15 UCPX15-48	PX15	UCX15-47 UCX15 UCX15-48	10.8 10.8 10.8	72.7	53.0	14.6	UCPX15C	UCPX15CD	109	4 9/32	10.8	-	-	-	-	-	-	-	-	-	-	-	-	-	-	-	-	-	-	-

Remarks 1. In Part No. of unit and units with covers, fitting codes follow bore diameter numbers. (See Table 10.5 in P.62.)

2. Part No. of applicable grease fittings are shown below.

A-1/4-28UNF ..... 201~210, X05~X09, 305~308

A-R1/8..... 211~218, X10~X20, 309~328

3. As for the triple seal type product (from 201 to 205 are the double seal type products), suffix code L3 (or L2) follows the Part No. of unit or bearing.

(Example of Part No.: UCP206JL3, UC206L3)

4. For the dimensions and forms of applicable bearings, see the dimensional tables of ball bearing for unit.

5. Representative examples of the forms of housing are indicated.

6. Housings of nodular graphite cast iron are also available.