

UCP
Cylindrical bore (with set screws)
d (75) ~ 140 mm

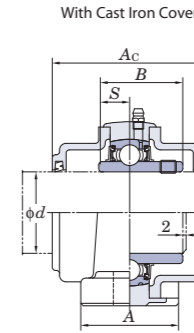
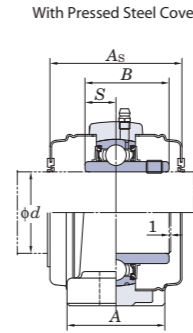
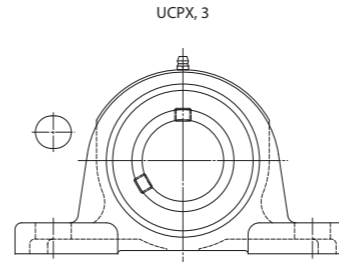
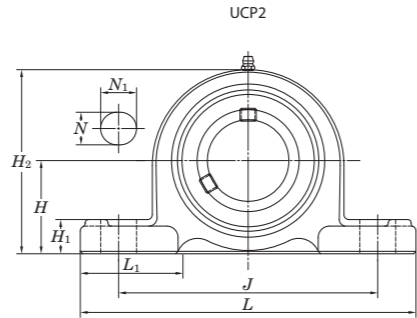
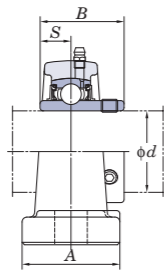

Variations of tolerance of distance from mounting bottom to center of spherical bore (ΔH_{2c})

| Housing No. | | | ΔH_{2c} |
|-------------|-----------|-----------|-----------------|
| P203~P210 | PX05~PX10 | P305~P310 | ±0.15 |
| P211~P218 | PX11~PX18 | P311~P318 | ±0.2 |
| | PX20 | P319~P328 | ±0.3 |

Forms and dimensions of H_{2c} of P204JE3 and P205JE3 (housing with cast iron cover) are shown below.

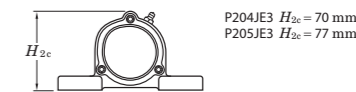

| Shaft Dia. mm inch | Dimensions inch mm | Bolt Size inch mm | Standard | | | Basic Load Ratings kN | Factor | With Pressed Steel Cover | | | | With Cast Iron Cover | | | | | | |
|--------------------------|---|---|-----------|-------------|-------------|--------------------------|-----------------|--------------------------|--------------|----------------------|--------------------------|----------------------|-----------|----------------------|--------------------------|-------------|------|---|
| | | | Unit No. | Housing No. | Bearing No. | | | Unit No. | Dimension mm | Mass kg | Unit No. | Dimension mm | Mass kg | | | | | |
| d | H L A J N N ₁ H ₁ H ₂ L ₁ B S | | Unit No. | Housing No. | Bearing No. | C _r | C _{0r} | f ₀ | Open Type | One Side Closed Type | Dimension A _s | Mass kg | Open Type | One Side Closed Type | Dimension A _c | Mass kg | | |
| 75 3 | 2 15/16 | | UCP315-47 | P315 | UC315-47 | 14.8 | | | - | - | - | - | - | - | - | - | | |
| | 3 | 3 15/16 14 31/32 3 15/16 11 13/32 1 1/16 1 9/16 1 3/8 7 25/32 4 7/32 3.228 1.260 | UCP315 | | UC315 | 14.8 | 113 | 77.2 | 13.2 | - | - | - | - | UCP315C | UCP315CD | 134 5 9/32 | 17.3 | |
| | | 100 380 100 290 27 40 35 198 107 82 32 | UCP315-48 | | UC315-48 | 14.8 | | | | - | - | - | - | - | - | - | - | |
| 80 | 3 1/8 | 3 1/2 11 1/2 3 1/16 9 1/8 3 1/32 1 3/8 1 3/16 6 27/32 3 9/32 3.252 1.311 | UCP216-50 | P216 | UC216-50 | 9.0 | 72.7 | 53.0 | 14.6 | UCP216C | UCP216CD | 109 4 9/32 | 9.0 | UCP216FC | UCP216FCD | 138 5 7/16 | 11.4 | |
| | | 88.9 292 78 232 25 30 174 83 82.6 33.3 | UCP216 | | UC216 | 9.0 | | | | - | - | - | - | - | - | - | - | |
| | | 4 15 4 11 1/8 1 1/16 2 9/32 1 11/32 7 11/16 4 9/16 3.374 1.343 | UCPX16 | PX16 | UCX16 | 15.3 | 84.0 | 61.9 | 14.5 | UCPX16C | UCPX16CD | 113 4 7/16 | 15.3 | - | - | - | - | - |
| 85 | 3 1/4 | 4 11/64 15 3/4 4 11/32 11 13/16 1 1/16 1 9/16 1 3/8 8 7/32 4 23/32 3.386 1.339 | UCP316 | P316 | UC316 | 18.5 | 123 | 86.7 | 13.3 | - | - | - | - | UCP316C | UCP316CD | 138 5 7/16 | 21.4 | |
| | | 106 400 110 300 27 40 35 209 120 86 34 | UCP316 | | UC316 | 18.5 | | | | - | - | - | - | - | - | - | - | |
| | | 3 3/4 12 7/32 3 9/32 9 23/32 3 1/32 1 3/8 1 1/4 7 9/32 3 7/16 3.374 1.343 | UCP217-52 | P217 | UC217-52 | 10.8 | 84.0 | 61.9 | 14.5 | - | - | - | - | - | - | - | - | - |
| 90 | 3 7/16 | 4 15 4 11 1/8 1 1/16 2 3/8 1 11/32 7 7/8 4 9/16 3.780 1.563 | UCPX17 | PX17 | UCX17 | 16.1 | 96.1 | 71.5 | 14.5 | UCPX17C | UCPX17CD | 123 4 27/32 | 16.1 | - | - | - | - | - |
| | | 101.6 381 102 283 27 60 34 200 116 96 39.7 | UCP317 | P317 | UC317 | 20.3 | 133 | 96.8 | 13.3 | - | - | - | - | UCP317C | UCP317CD | 146 5 3/4 | 23.6 | |
| | | 4 13/32 16 17/32 4 11/32 12 19/32 1 5/16 1 25/32 1 9/16 8 21/32 4 23/32 3.780 1.575 | UCP218-56 | P218 | UC218-56 | 13.9 | 96.1 | 71.5 | 14.5 | - | - | - | - | - | - | - | - | - |
| 95 | 3 1/2 | 4 12 7/8 3 15/32 10 5/16 1 1/16 1 9/16 1 5/16 7 25/32 3 11/16 3.780 1.563 | UCP218 | | UC218 | 13.9 | | | | UCP218C | UCP218CD | 123 4 27/32 | 13.9 | UCP218FC | UCP218FCD | 152 6 | 17.0 | |
| | | 101.6 327 88 262 27 40 33 198 94 96 39.7 | UCP218 | | UC218 | 13.9 | | | | - | - | - | - | - | - | - | - | |
| | | 4 15 4 3/8 11 1/8 1 1/16 2 3/8 1 1/2 8 1/32 4 9/16 4.094 1.689 | UCPX18 | PX18 | UCX18 | 19.1 | 109 | 81.9 | 14.4 | - | - | - | - | UCPX18C | UCPX18C | 158 6 7/32 | 22.5 | |
| 100 | 3 1/2 | 4 41/64 16 15/16 4 11/32 13 1 5/16 1 25/32 1 9/16 9 7/32 4 23/32 3.780 1.575 | UCP318-56 | P318 | UC318-56 | 22.8 | 143 | 107 | 13.3 | - | - | - | - | - | - | - | - | |
| | | 118 430 110 330 33 45 40 234 120 96 40 | UCP318 | | UC318 | 22.8 | | | | - | - | - | - | UCP318C | UCP318CD | 150 5 29/32 | 26.6 | |
| | | 4 59/64 18 1/2 4 23/32 14 3/16 1 13/32 1 31/32 1 13/16 9 3/4 4 29/32 4.055 1.614 | UCP319 | P319 | UC319 | 29.0 | 153 | 119 | 13.3 | - | - | - | - | - | - | - | - | |
| 105 | 3 15/16 | 5 17 4 3/4 13 1/4 1 5/16 2 9/16 1 25/32 9 21/32 4 31/32 4.626 1.937 | UCPX20 | PX20 | UCX20 | 30.4 | 133 | 105 | 14.4 | - | - | - | - | UCPX20C | UCPX20CD | 186 7 5/16 | 34.9 | |
| | | 127 432 121 337 33 65 45 245 126 117.5 49.2 | UCPX20-63 | | UCX20-63 | 30.4 | | | | - | - | - | - | - | - | - | - | |
| | | 5 33/64 19 9/32 4 23/32 14 31/32 1 13/32 1 31/32 1 13/16 10 3/4 5 1/2 4.252 1.654 | UCP320 | P320 | UC320 | 35.1 | 173 | 141 | 13.2 | - | - | - | - | UCP320C | UCP320CD | 174 6 27/32 | 40.7 | |
| 110 | 3 15/16 | 140 490 120 380 36 50 46 273 140 108 42 | UCP320-63 | | UC320-63 | 35.1 | | | | - | - | - | - | - | - | - | - | |
| | | 5 33/64 19 9/32 4 23/32 14 31/32 1 13/32 1 31/32 1 13/16 10 15/16 5 1/2 4.409 1.732 | UCP320-64 | | UC320-64 | 35.1 | | | | - | - | - | - | - | - | - | - | |
| | | 140 490 120 380 36 50 46 273 140 108 42 | UCP321 | P321 | UC321 | 37.6 | 184 | 153 | 13.2 | - | - | - | - | UCP321C | UCP321CD | 178 7 | 43.6 | |
| 120 | 3 1/2 | 5 29/32 20 15/32 5 1/2 15 3/4 1 9/16 2 5/32 1 31/32 11 21/32 5 29/32 4.606 1.811 | UCP322 | P322 | UC322 | 44.0 | 205 | 180 | 13.2 | - | - | - | - | UCP322C | UCP322CD | 188 7 13/32 | 50.8 | |
| | | 150 520 140 400 40 55 50 296 150 117 46 | UCP322 | | UC322 | 44.0 | | | | - | - | - | - | - | - | - | - | |
| | | 6 19/64 22 7/16 5 1/2 17 23/32 1 9/16 2 5/32 1 31/32 12 7/16 6 5/16 4.961 2.008 | UCPX324 | PX324 | UCX324 | 55.4 | 207 | 185 | 13.5 | - | - | - | - | - | - | - | - | |
| 130 | 3 1/2 | 7 3/32 23 5/8 5 1/2 18 29/32 1 9/16 2 5/32 1 31/32 13 21/32 7 11/16 5.315 2.126 | UCP324 | | UC324 | 55.4 | | | | - | - | - | - | UCP324C | UCP324CD | 196 7 23/32 | 64.9 | |
| | | 160 570 140 450 40 55 50 316 160 126 51 | UCP324 | | UC324 | 55.4 | | | | - | - | - | - | - | - | - | - | |
| | | 7 3/32 23 5/8 5 1/2 18 29/32 1 9/16 2 5/32 1 31/32 13 21/32 7 11/16 5.315 2.126 | UCP326 | P326 | UC326 | 72.1 | 229 | 214 | 13.6 | - | - | - | - | - | - | - | - | |
| 140 | 3 1/2 | 180 600 140 480 40 55 50 355 195 135 54 | UCP326 | | UC326 | 72.1 | | | | - | - | - | - | UCP326C | UCP326CD | 214 8 7/16 | 84.2 | |
| | | 7 7/8 24 13/32 5 1/2 19 11/16 1 9/16 2 5/32 2 3/8 15 15/32 7 9/32 5.709 2.323 | UCP328 | P328 | UC328 | 92.5 | 253 | 246 | 13.6 | - | - | - | - | - | - | - | - | |
| | | 200 620 140 500 40 55 60 393 185 145 59 | UCP328 | | UC328 | 92.5 | | | | - | - | - | - | UCP328C | UCP328CD | 222 8 3/4 | 108 | |

Remarks 1. In Part No. of unit and units with covers, fitting codes follow bore diameter numbers. (See Table 10.5 in P.62.)
2. Part No. of applicable grease fittings are shown below.
A-1/4-28UNF 201~210, X05~X09, 305~308
A-R1/8 211~218, X10~X20, 309~328

3. As for the triple seal type product (from 201 to 205 are the double seal type products), suffix code L3 (or L2) follows the Part No. of unit or bearing. (Example of Part No.: UCP206JL3, UC206L3)
4. For the dimensions and forms of applicable bearings, see the dimensional tables of ball bearing for unit.
5. Representative examples of the forms of housing are indicated.
6. Housings of nodular graphite cast iron are also available.