

Section 08 Ultrafiltration Instruction

Ultrafiltration Module List

NO.	KKS Code	Equipment Name	Qty.	Specification	Model	Remark
1	00GBK30AT011 00GBK30AT012 00GBK30AT013 00GBK30AT014	Ultra filtration skid A/B/C/D	4 set	Q=330m ³ /h	NA	
1.1		Ultrafiltration modules 72 modules per UF skid	288 pieces	NA	UNA-620AB	

2. Spec

2.1 Module Standard Specification

Item	UNA-600A	UNA-660A	UNA-620A	UNA-620AB
Membrane Material	High-bonding network structured polyvinylidene fluoride			
Effective membrane area (outer surface (m ²))	23	40	50	65
Performance				
Nominal pore size (micrometer)	0.1	0.1	0.1	0.1
Use Conditions				
Max. feed pressure (kPa)	300 *1	300 *1	300 *1	300 *1
Max. TMP (kPa)	300	300	300	200
Max. Temperature (°C)	40	40	40	40
pH Range	1 - 10*2	1 - 10 *2	1 - 10 *2	1 - 10 *2
Parts Material				
Housing	ABS resin	ABS resin	ABS resin	ABS resin
Potting resin	Polyurethane	Polyurethane	Polyurethane	Polyurethane
Gasket, O-ring	EPDM	EPDM	EPDM	EPDM
Dimensions (mm)				
Use of End cap B at both ends	1,314L × φ165	2,018L × φ165	2,418L × φ165	2,418L × φ165
Use of End caps B and A at upper and lower ends respectively	1,234L × φ165	1,938L × φ165	2,338L × φ165	2,338L × φ165
Weight (kg)				
Filled with water	30	50	60	60
Without water	15	25	30	30

*1 Consult Asahi Kasei for system operation under a pressure of up to 400kPa.

*2 See Section 9.1.1 "Contaminants and Applicable Cleaning and/or Disinfecting Agents" for chemical cleaning.

See Section 7. "STANDARD OPERATING PARAMETERS FOR THE UNA SERIES" for the details of operating parameters.

2.2 Module and Parts Shipped as Standard

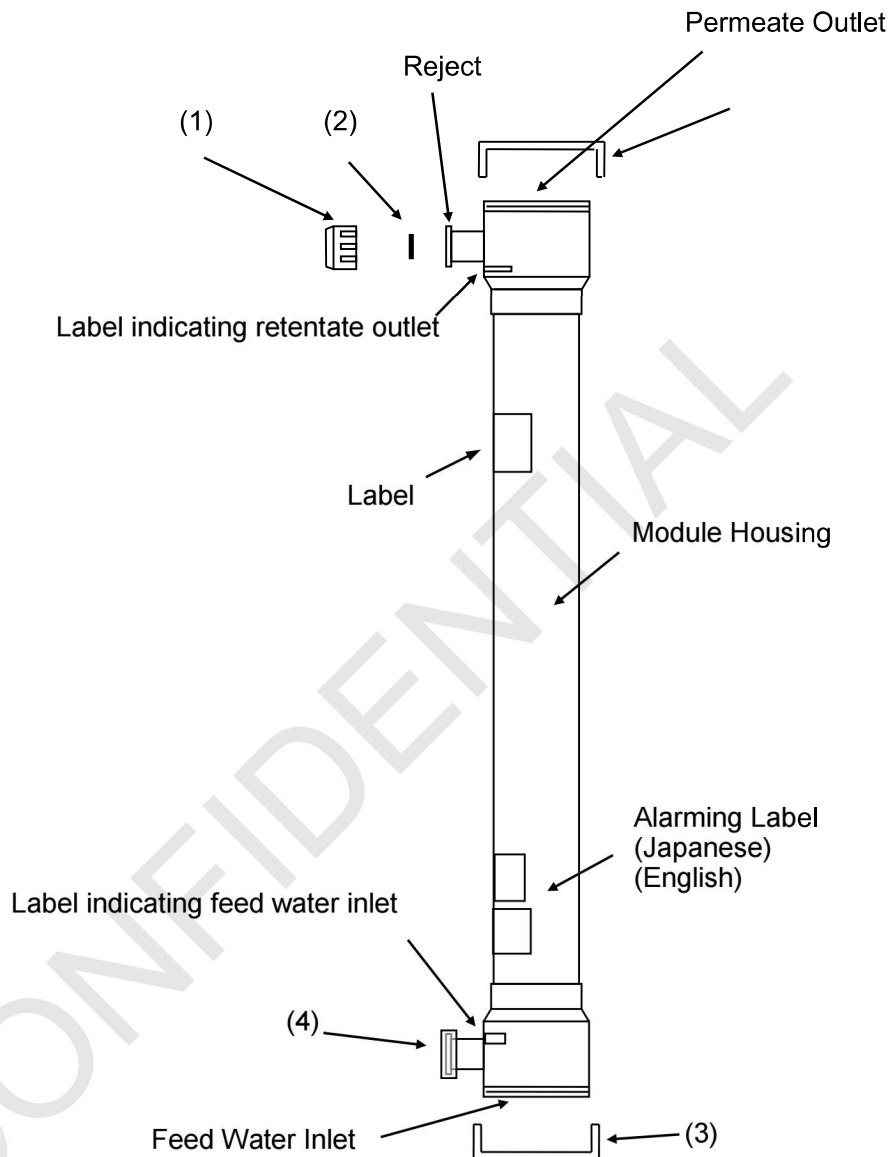

No.	Description	Qty.
(1)	Blind cap	1
(2)	Gasket	1
(3)	End cap	2
(4)	Protection cap	1

2.3.3 Connection of Module Upper Part

The permeate outlet on top of the module is connected to a rack permeate pipe through a combination of End cap B and an expansion joint.

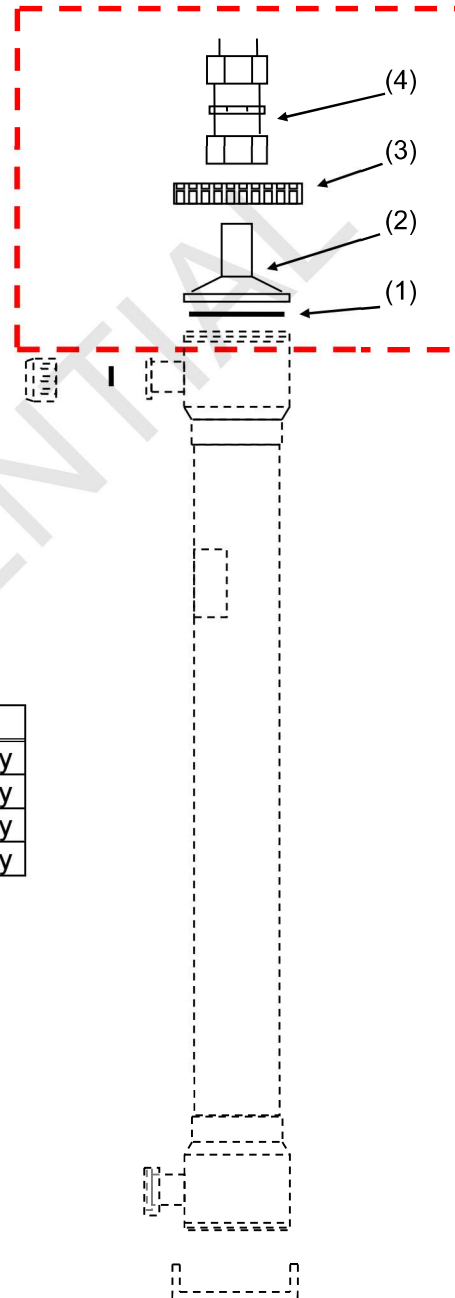

No.	Parts	Qty.	Remark
(1)	O-ring	1	Sold separately
(2)	End cap B	1	Sold separately
(3)	Nut	1	Sold separately
(4)	Expansion joint	1	Sold separately

2.3.4 Connection of Module Lower Part, Using Cap A

The feed water inlet at the bottom of the module is connected to a rack feed pipe through a combination of End cap A, a ferrule, and a clamp.

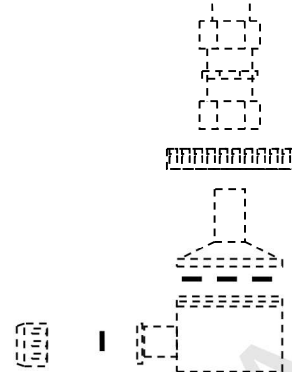

No.	Parts	Qty.	Remark
(1)	O-ring	1	Sold separately
(2)	End cap A	1	Sold separately
(3)	Nut	1	Sold separately
(4)	Sanitary gasket	1	Sold separately
(5)	Clamp	1	Sold separately

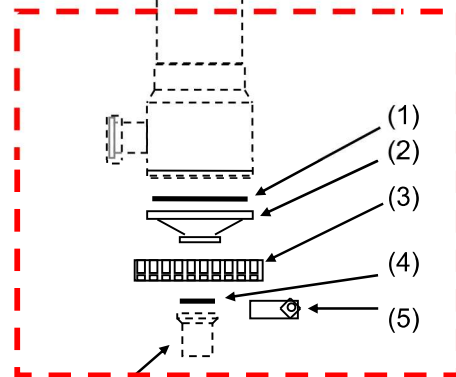

(2.5S ferrule: Connected to a rack feed pipe)

2.3.5 Connection of Module Lower Part, Using Cap B

The feed water inlet at the bottom of the module is connected to a rack feed pipe through a combination of End cap B and an expansion joint.

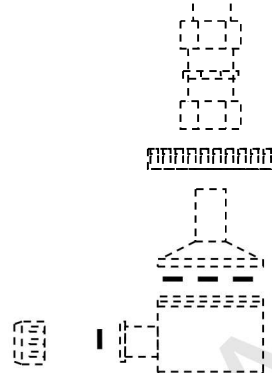

No.	Parts	Qty.	Remark
(1)	O-ring	1	Sold separately
(2)	End cap B	1	Sold separately
(3)	Nut	1	Sold separately
(4)	Expansion joint	1	Sold separately

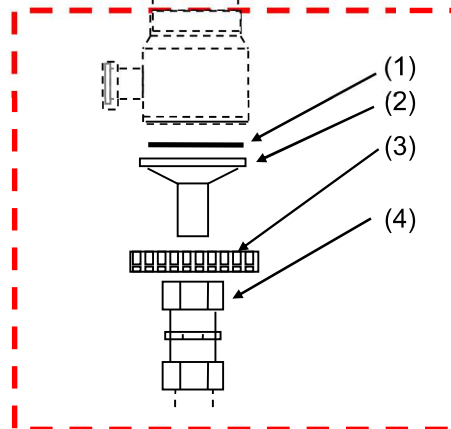

2.3.6 Connection of Module Side Nozzles

The reject nozzle on the side of the module is connected to a rack discharge pipe through a union socket.

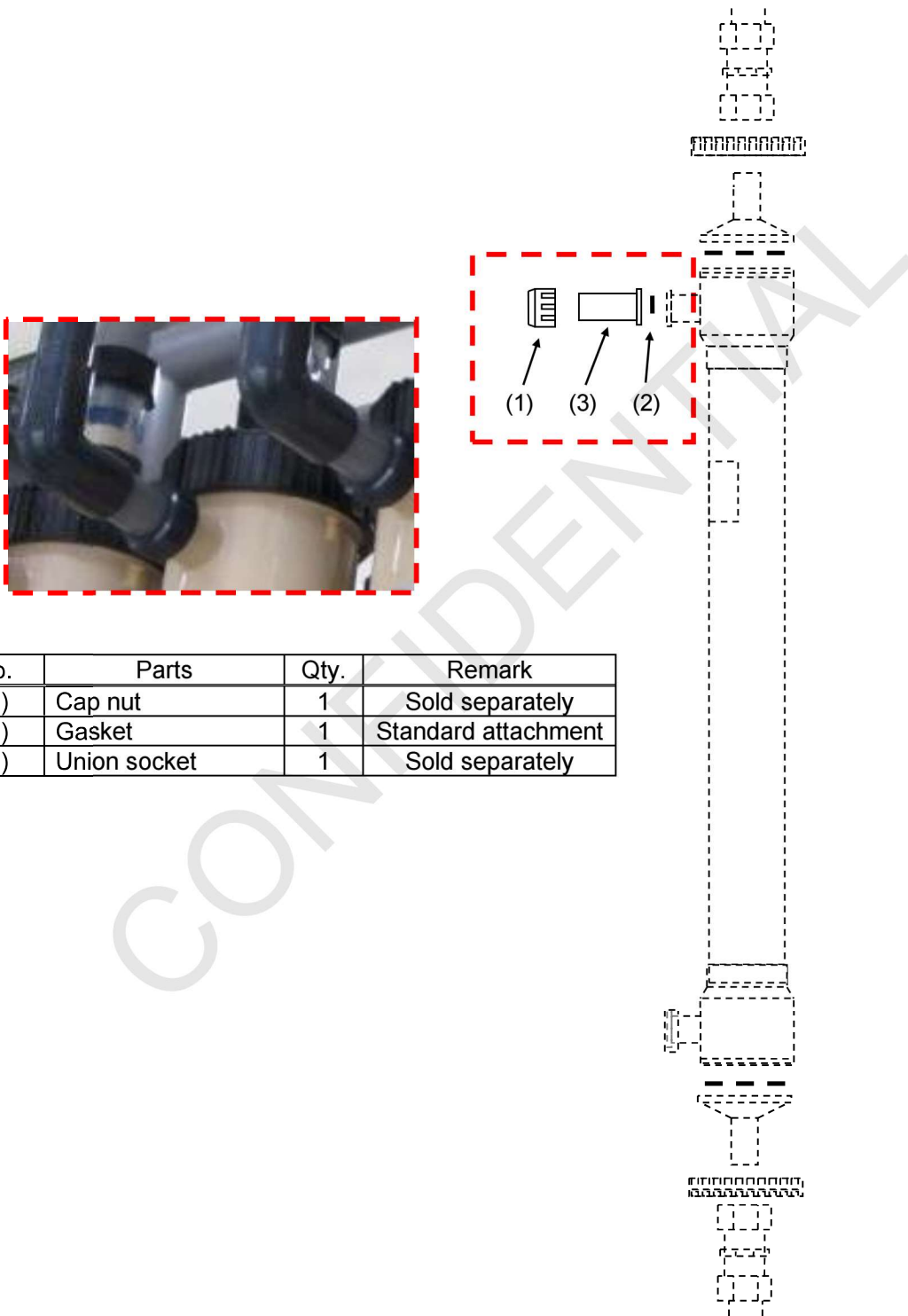

No.	Parts	Qty.	Remark
(1)	Cap nut	1	Sold separately
(2)	Gasket	1	Standard attachment
(3)	Union socket	1	Sold separately