

Section 17 Metering Pump Instruction

Metering Pump List

NO.	KKS Code	Equipment Name	Qty.	Specification	Pump Model	Motor Power	Remark
1	00GBN10AP011 00GBN10AP012 00GBN10AP013 00GBN10AP014	Coagulant dosing pump A/B/C/D	4	Q=50L/h, P=10bar	GM0050P	0.25kW	Attachment 01
2	00GBN20AP001 00GBN20AP002 00GBN20AP003 00GBN20AP004	Flocculant dosing pump A/B/C/D	4	Q=464L/h, P=7bar	GB0500P	0.55kW	Attachment 02
3	00GBN30AP011 00GBN30AP012	Raw seawater NaClO dosing pump A/B	2	Q=15.1L/h, P=12.1bar	C766-368TI	44W	Attachment 03
4	00GKB50AP001 00GKB50AP002	Living water NaClO dosing pump A/B	2	Q=3.8L/h, P=7.6bar	P756-368TI	22W	Attachment 03
5	00GBN30AP021 00GBN30AP022	UF EFM / CIP NaClO dosing pump A/B	2	Q=1000L/h, P=11bar	MBH402-8M	1.5kW	Attachment 04
6	00GFP10AP001 00GFP10AP002 00GFP10AP003	SWRO antiscalant dosing pump A/B/C	3	Q=25L/h, P=12bar	GM0025P	0.25kW	Attachment 01
7	00GFP20AP001 00GFP20AP002	BWRO antiscalant dosing pump A/B	2	Q=6.1L/h, P=10.3bar	B716-368TI	29W	Attachment 03
8	00GFP30AP001 00GFP30AP002	Sodium bisulfite dosing pump A/B	2	Q=50L/h, P=10bar	GM0050P	0.25kW	Attachment 01

FIGURE 7 GM DRIVE END VIEW

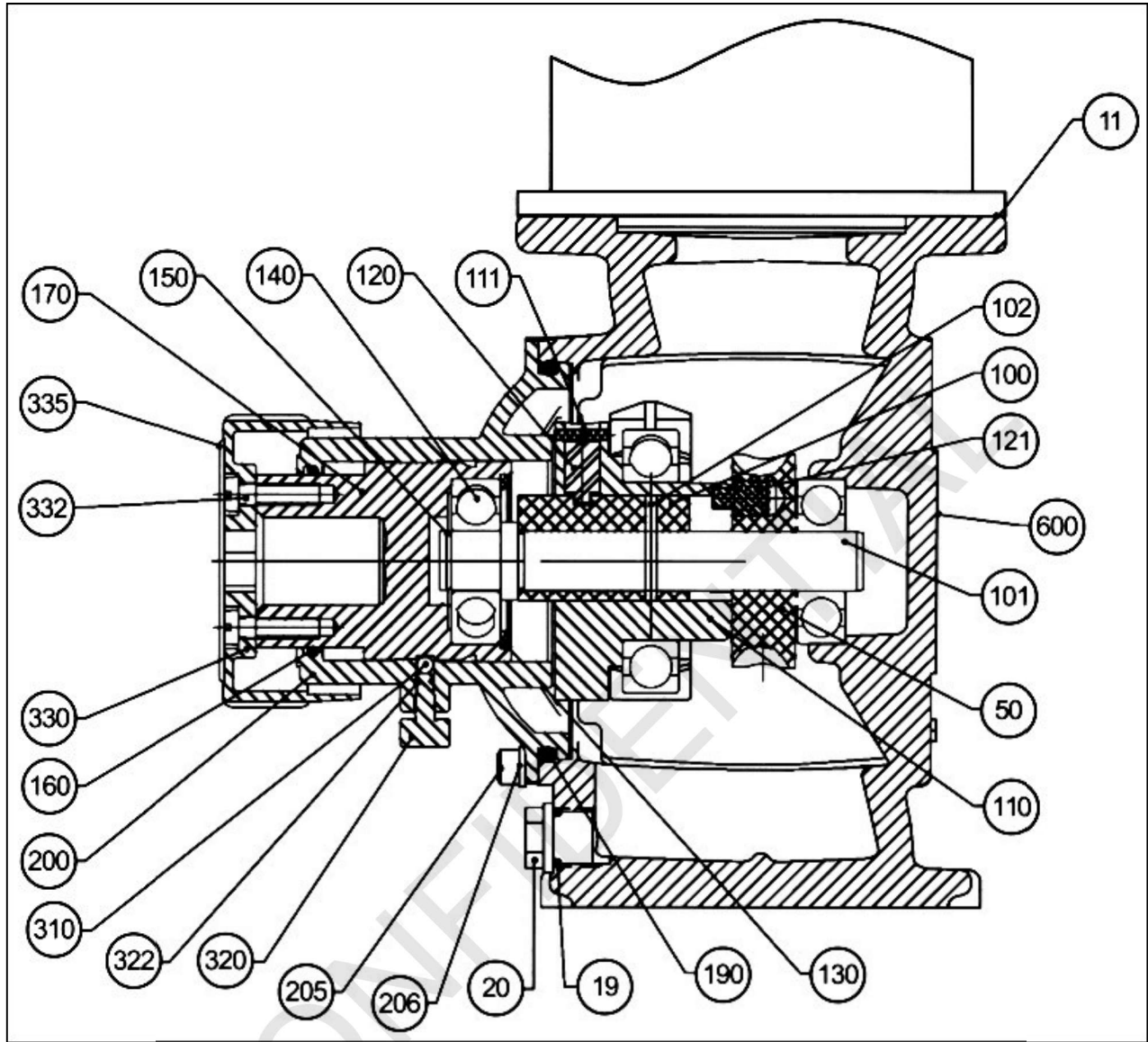

5.2 PARTS LIST FOR GM DRIVE END VIEW (REFERRING TO FIGURE 7)

Item Number	Description	Part Number	Qty.
11	Gasket Motor (IEC 71,Flange)	H60731	1
	Gasket Motor (NEMA 56C,Flange)	S2250115099	1
19	O-Ring GB3452, 1-82-14 x 2.65	S4080068031	1
20	Oil Drain Plug	S60086	1
50	Gear, 8:1, 180SPM	S05203091085N	1
	Gear, 10:1, 173SPM/144SPM	S05203092085N	1
	Gear, 20:1, 86SPM/72SPM	S05203093085N	1
	Gear, 40:1, 43SPM/36SPM	S05203094085N	1
100	Male Eccentric Assembly, 10mm (GM0400-GM0500)	H60625	1
	Male Eccentric Assembly, 8mm (GM120-GM330)	H60626	1
	Male Eccentric Assembly, 6mm (GM0025-GM170)	H60627	1
	Male Eccentric Assembly, 4mm (GM0002-GM0010)	H60628	1
	Male Eccentric Assembly, 1.2mm Stroke Length	H60629	1
110	Female Eccentric	S01600260071N	1
111	Spring Pin	S4310006455N	1
120	Stroke Adjust Key	3701310039	1
121	Gear Pin	61108	1
130	Retaining Ring, Stroke Adjusting	S4340020471N	1
160	Oil Seal, Stroke Screw	60766	1
170	Stroke Adjusting Screw	61331	1
190	O-Rings	S4380024051N	1
200	Side Cover	60729	1
205	Socket Head Screw, GB70-85-M6×16	S4350003375N	3
206	Washer	S4340009065N	3
310	Stroke Lock Ball, 3/16"	4370040050N	1
320	Stroke Lock Screw	S05600400022N	1
322	O-Ring	S4380249031N	1
330	Stroke Adjusting Knob	S70066	1
332	Pan Screw	H65525	2
335	Knob Sticker, 316SS	H60020	1

Note:

1. Replacement of male eccentric assembly (100), only as assembly of item male eccentric (100), drive shaft (101), spring pin (102), bearing (140) & retaining ring (150).