

SPECIFICATION TABLE OF 3-PHASE SQUIRREL CAGE INDUCTION MOTOR	CUSTOMER	USER
	INQ. NO.	EQUIPMENT
	JOB NO.	MACHINE
	TOTAL SETS	ITEM NO.

AD193002B1
1

Item	Terms	Description
1	Model	TEXJ(AFJKXD)
2	Code or Standard	Dimensions Frame Assignment Performance Test IEC IEC IEC IEC
3	Rating	250 kW 8 Pole 3000 Volt 3 Phase 50 Hz
4	Service Duty	Continuous Rating (S1) Service Factor 1.0
5	Starting Method	D.O.L.(Direct On Line)
6	Rotation	Facing The Drive End : CW(ClockWise), Available for Bi-Direction
7	Drive Method	Direct Coupling
8	Environment	Amb. Temp. : -20 ~ 40 °C Humidity : Less Than 90 %RH Altitude : Up to 1000 M
9	Enclosure & Protection	IP65 : Totally Enclosed Outdoor
10	Cooling	IC411 : Self External Fan, Surface Cooling
11	Mounting	IM1001 : HS, Foot
12	Dimensions	Di# 3W041W014(REV.02) Frame No : 355
13	Frame & Bracket	Frame : Cast Iron Bracket : Cast Iron
14	Fan & Fan Cover	Fan :Aluminium Fan Cover :Steel Plate
15	Terminal Box	Cast Iron
16	Lead Terminals	
17	Lubricant	Shell Alvania RL3
18	Painting	Color : RAL7040(佐敦)
19	Stator Winding	Insulation Class: F
20	Rotor Conductor	Cu-Alloy
21	Starting Performance	LRC/FLC=550 % LRT/FLT 80 %
22	Operating Performance	Hz/V 50/3000 Break Down Torque %Load 100 220 %FLT Amp. 68.3 Eff.% 95.0 Temp. Rise Limit. (Resistance) P.F.% 74.1 Stator 80 °C R.P.M. 741
23	Approximate Weight	
24	Note	1.Rated Torque : Tf= 328.3 kg-m 2.With space heater : 1 φ 220V 200W. 3. With Winding RTD : PT 100Ω/0°C 6pcs. 4. With Bearing RTD : PT 100Ω/0°C 2pcs. 5. Ex tb IIIC T135°C IP65 . Accessories : Refer to motor outline drawing Note : [*] at the end represent revised item

APPD.	Hsj Hu	OCT. 17 2018	DWG NO.	3W057H186-48814
CHKD.			REV.02	1/1
DWN.	Tommy Hua	OCT. 17 2018	TECO ELEC. & MACH. CO., LTD.	

TYPE	OUTPUT		POLE	TIME RATING	VOLTAGE V	Hz	SYN. SPEED R. P. M
	HP.	kW.					
TEX J (AFJKXD)		160	4	CONT	3000	50	1500
		200					
		250					
		250	8	CONT	3000	50	750

TOTALLY ENCLOSED FAN-COOLED TYPE. SQUIRREL-CAGE ROTOR.

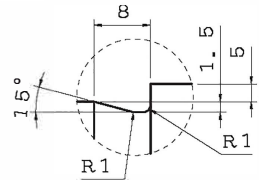
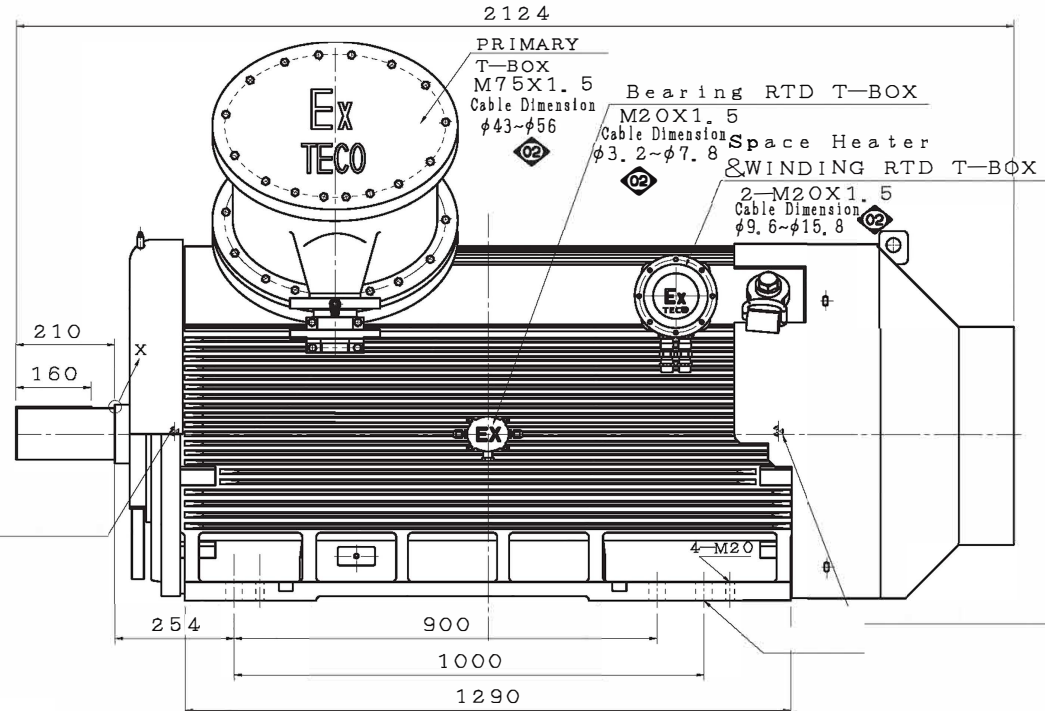
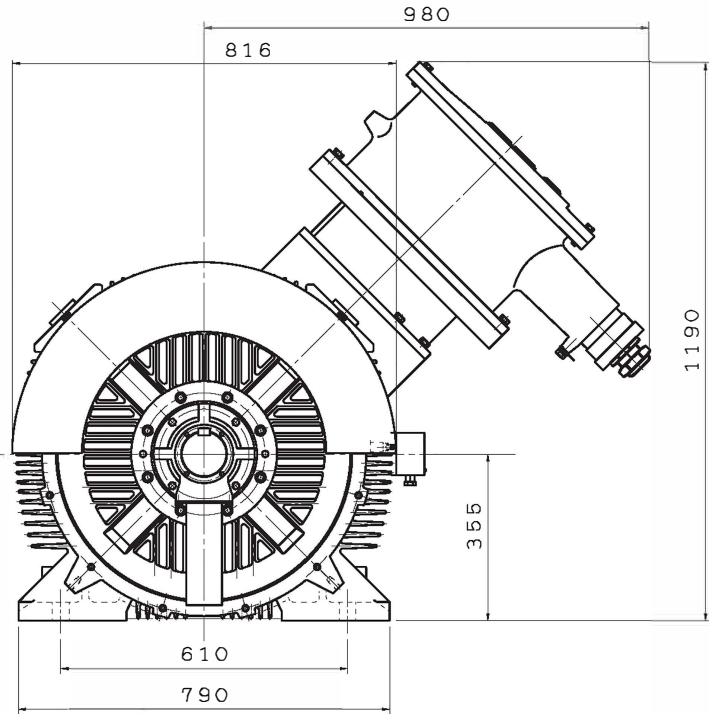

ENLARGED VIEW OF X

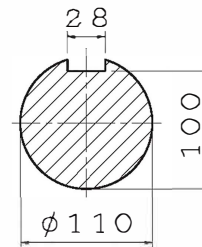

NOTE:

1. DIMENSIONS IN mm.
2. FRAME NO. 355.
3. F CLASS INSULATION.
4. FOR DIRECT COUPLING.
5. ENCLOSURE: IP65
6. BEARING SIZE: DRIVE END: 6224
OPP. DRIVE END: 6220
7. Extb IIIC T135C IP65

TECO		OUTLINE DIMENSIONS	
DATE		3-PHASE INDUCTION MOTOR	
DWN. T. HUA OCT 09 2018		DWG NO. 3WO41WO15	
CHKD. A. HU OCT 09 2018		REV: 02	
APPD. B. H. WANG OCT 09 2018		東元電機股份有限公司 TECO Elec. & Mach. Co., Ltd.	