

Drive Unit

Standard and explosion-proof

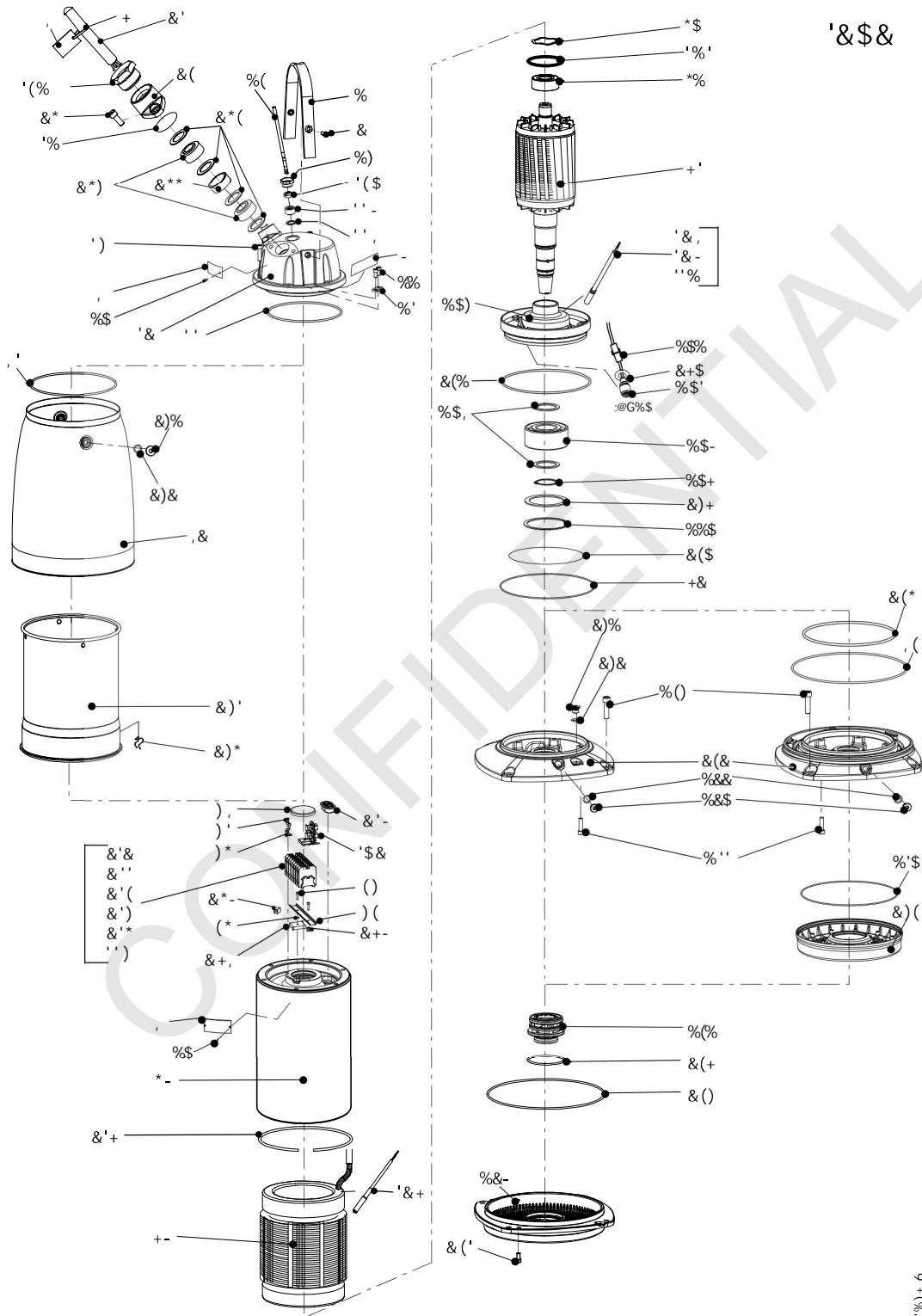

Drive Unit

Pos. No	Part. No	Type	Denomination	Qty/Version			
				090	095	180	185
130	82 76 66		O-ring 329.79X3.53 NBR	1	1	1	1
133	83 04 53		Hex.socket hd screw M12X45-A4-80	6	6	6	6
141	631 37 30		Mechanical seal DIAM.60 PLUGIN, WCCR/WCCR	1	1	1	1
141	631 37 31		Mechanical seal DIAM.60 PLUGIN, WCCR/RSIC	1	1	1	1
228	663 85 00		Connection plate	1	1	1	1
229	667 40 01		Sticker	2	2	2	2
231	93 00 77		Shrink hose ID=6.4 MM	*	*	*	*
231	93 00 78		Shrink hose ID=9.5 MM	*	*	*	*
232	83 53 58		Terminal clamp WDU6/10	3	3	3-4	3-4
233	83 53 61		Terminal clamp WDU16,1000V	6-8	6-8	6-8	6-8
233	83 53 17		Terminal clamp WDU35/IK/ZA	6-9	6-9	6-9	6-9
233	83 53 62		Terminal clamp WEIDMÜLLER WDU 70N	8-9	8-9	8-9	8-9
234	83 53 67		Cross connection WQV16/2	3-4	3-4	3-4	3-4
234	650 20 01		Cross connection	1			
234	650 20 02		Cross connection	1	1	1	1
234	83 53 49		Cross connection WQW35/2	3-4	3-4	3-4	3-4
234	650 20 03		Cross connection	1	1	1	1
234	83 53 63		Cross connection WEIDMÜLLER WQV 70N/2	4	4	4	4
235	83 53 54		End support WEW 35/2	2	2	2	2
236	83 53 50		Partition	1	1	1	1
237	750 84 00		Ring		1		1
239	650 84 00		El.lead through unit	1	1	1	1
			Sealed housing leads = 10 - 10 mm2				
239	650 84 01		El.lead through unit	1	1	1	1
			Sealed housing leads = 2,50 - 6 mm2				
239	650 84 03		El.lead through unit	1	1	1	1
			Sealed housing leads = 16 - 25 mm2				
240	607 48 01		Spring	1	1	1	1
241	82 75 00		O-ring 269.3X5.7 NBR	1	1	1	1
241	82 81 14		O-ring 269.3X5.7 FPM	1	1	1	1
242	607 79 01	(Ex)	Adapter	1	1		
242	607 91 11	(Ex)	Adapter	1	1		
			Cooling jacket				
242	607 79 00		Adapter			1	1
242	607 91 10		Adapter			1	1
			Cooling jacket				
243	83 04 61		Hex.socket hd screw M12X25-A4-80	2	2	2	2
245	82 75 08		O-ring 399.3X5.7 NBR	1	1	1	1
245	82 80 93		O-ring 399.3X5.7 FPM	1	1	1	1
246	82 76 66		O-ring 329.79X3.53 NBR	1	1	1	1
247	82 81 72		O-ring 119.3X5.7 FPM	1	1	1	1
251	642 13 00		Plug	2	2	2	2
252	82 76 85		O-ring 17X3 NBR	2	2	2	2
252	82 79 15		O-ring 17X3 FPM	2	2	2	2