

No.	TAG No.	Nominal Size (DN)	Rating	Type	Operation	Seal	Q'ty	Material of Body	Connection	Design Press (bar.g)	Design Temp (deg.C)	Drawing		Reference Drawing	Description	Remarks
												No.	Page			
1	50QFB01AA010	50	150	BALL	MANUAL	NA	1	A182 Gr. F304	PLAIN END	12	55	Q1HA1PPP1P-d	60	①	UNIT 5 IA TURBINE RING MAIN HEADER VALVE	
2	50QFB02AA005	15	150	BALL	MANUAL	NA	1	A182 Gr. F304	PLAIN END	12	55	Q1HA1PPP1P-d	60	①	UNIT 5 IA TO LOT2 EQUIPMENT FOR OXYGEN INJECTION (B) LINE VALVE	
3	50QFB03AA005	15	150	BALL	MANUAL	NA	1	A182 Gr. F304	PLAIN END	12	55	Q1HA1PPP1P-d	60	①	UNIT 5 IA TO LOT2 EQUIPMENT FOR OXYGEN INJECTION (C) LINE VALVE	
4	50QFB04AA005	25	150	BALL	MANUAL	NA	1	A182 Gr. F304	PLAIN END	12	55	Q1HA1PPP1P-d	60	①	UNIT 5 IA TO CPP POLISHING SYSTEM AREA LINE VALVE	
5	50QFB05AA005	50	150	BALL	MANUAL	NA	1	A182 Gr. F304	PLAIN END	12	55	Q1HA1PPP1P-d	60	①	UNIT 5 IA TO CONDENSER VACUUM PUMP AREA LINE VALVE	
6	50QFB07AA005	50	150	BALL	MANUAL	NA	1	A182 Gr. F304	PLAIN END	12	55	Q1HA1PPP1P-d	60	①	UNIT 5 IA TO MAIN OIL TANK AREA LINE VALVE	
7	50QFB09AA005	50	150	BALL	MANUAL	NA	1	A182 Gr. F304	PLAIN END	12	55	Q1HA1PPP1P-d	60	①	UNIT 5 IA TO TURBINE AREA LINE VALVE	
8	50QFB10AA005	15	150	BALL	MANUAL	NA	1	A182 Gr. F304	PLAIN END	12	55	Q1HA1PPP1P-d	60	①	UNIT 5 IA TO LOT2 EQUIPMENT FOR CHEMICAL INJECTION LINE VALVE	
9	50QFB11AA005	50	150	BALL	MANUAL	NA	1	A182 Gr. F304	PLAIN END	12	55	Q1HA1PPP1P-d	60	①	UNIT 5 IA TO CCGWP AREA LINE VALVE	
10	50QFB12AA005	50	150	BALL	MANUAL	NA	1	A182 Gr. F304	PLAIN END	12	55	Q1HA1PPP1P-d	60	①	UNIT 5 IA TO BFP & HEATER AREA LINE VALVE	
11	50QFB13AA005	15	150	BALL	MANUAL	NA	1	A182 Gr. F304	PLAIN END	12	55	Q1HA1PPP1P-d	60	①	UNIT 5 IA TO LOT2 EQUIPMENT FOR OXYGEN INJECTION (A) LINE VALVE	
12	50QFB14AA005	50	150	BALL	MANUAL	NA	1	A182 Gr. F304	PLAIN END	12	55	Q1HA1PPP1P-d	60	①	UNIT 5 IA TO GENERATOR AUX. AREA LINE VALVE	
13	50QJA10AA005	25	150	BALL	MANUAL	NA	1	ASTM A105	PLAIN END	9	40	Q1HA1PPP1C-d	59	②	N2 SEALING TO UNIT 5 DESUPERHEATER A LINE VALVE	
14	50QJA10AA010	25	150	BALL	MANUAL	NA	1	ASTM A105	PLAIN END	9	40	Q1HA1PPP1C-d	59	②	N2 SEALING TO UNIT 5 DESUPERHEATER B LINE VALVE	
15	50QJA10AA015	25	150	BALL	MANUAL	NA	1	ASTM A105	PLAIN END	9	40	Q1HA1PPP1C-d	59	②	N2 SEALING TO UNIT 5 LP HEATER 2 LINE VALVE	
16	50QJA10AA020	25	150	BALL	MANUAL	NA	1	ASTM A105	PLAIN END	9	40	Q1HA1PPP1C-d	59	②	N2 SEALING TO UNIT 5 LP HEATER 4 LINE VALVE	
17	50QJA10AA025	25	150	BALL	MANUAL	NA	1	ASTM A105	PLAIN END	9	40	Q1HA1PPP1C-d	59	②	N2 SEALING TO UNIT 5 LP HEATER 3 LINE VALVE	
18	50QJA10AA030	50	150	BALL	MANUAL	NA	1	ASTM A105	PLAIN END	9	40	Q1HA1PPP1C-d	59	②	N2 SEALING TO UNIT 5 DEAERATOR LINE VALVE	
19	50QJA10AA035	25	150	BALL	MANUAL	NA	1	ASTM A105	PLAIN END	9	40	Q1HA1PPP1C-d	59	②	N2 SEALING TO UNIT 5 HP HEATER 8A LINE VALVE	
20	50QJA10AA040	25	150	BALL	MANUAL	NA	1	ASTM A105	PLAIN END	9	40	Q1HA1PPP1C-d	59	②	N2 SEALING TO UNIT 5 HP HEATER 8B LINE VALVE	
21	50QJA10AA045	25	150	BALL	MANUAL	NA	1	ASTM A105	PLAIN END	9	40	Q1HA1PPP1C-d	59	②	N2 SEALING TO UNIT 5 HP HEATER 6A LINE VALVE	
22	50QJA10AA050	25	150	BALL	MANUAL	NA	1	ASTM A105	PLAIN END	9	40	Q1HA1PPP1C-d	59	②	N2 SEALING TO UNIT 5 HP HEATER 6B LINE VALVE	
23	50QJA10AA055	25	150	BALL	MANUAL	NA	1	ASTM A105	PLAIN END	9	40	Q1HA1PPP1C-d	59	②	N2 SEALING TO UNIT 5 HP HEATER 7A LINE VALVE	
24	50QJA10AA060	25	150	BALL	MANUAL	NA	1	ASTM A105	PLAIN END	9	40	Q1HA1PPP1C-d	59	②	N2 SEALING TO UNIT 5 HP HEATER 7B LINE VALVE	
25	50QJA10AA067	25	150	BALL	MANUAL	NA	1	ASTM A105	PLAIN END	9	40	Q1HA1PPP1C-d	59	②	N2 SEALING TO UNIT 5 CONDENSATE WATER LINE AFTER LP HEATER 4 VALVE	
26	50QJA10AA082	25	150	BALL	MANUAL	NA	1	ASTM A105	PLAIN END	9	40	Q1HA1PPP1C-d	59	②	N2 SEALING TO UNIT 5 FEED WATER LINE BEFORE DESUPERHEATER B VALVE	
27	50QJA10AA083	25	150	BALL	MANUAL	NA	1	ASTM A105	PLAIN END	9	40	Q1HA1PPP1C-d	59	②	N2 SEALING TO UNIT 5 FEED WATER LINE BEFORE DESUPERHEATER A VALVE	
28	60QFB01AA010	50	150	BALL	MANUAL	NA	1	A182 Gr. F304	PLAIN END	12	55	Q1HA1PPP1P-d	60	①	UNIT 6 IA TURBINE RING MAIN HEADER VALVE	
29	60QFB02AA005	15	150	BALL	MANUAL	NA	1	A182 Gr. F304	PLAIN END	12	55	Q1HA1PPP1P-d	60	①	UNIT 6 IA TO LOT2 EQUIPMENT FOR OXYGEN INJECTION (B) LINE VALVE	

No.	TAG No.	Nominal Size (DN)	Rating	Type	Operation	Seal	Q'ty	Material of Body	Connection	Design Press (bar.g)	Design Temp (deg.C)	Drawing		Reference Drawing	Description	Remarks
												No.	Page			
30	60QFB03AA005	15	150	BALL	MANUAL	NA	1	A182 Gr. F304	PLAIN END	12	55	Q1HA1PPP1P-d	60	①	UNIT 6 IA TO LOT2 EQUIPMENT FOR OXYGEN INJECTION (C) LINE VALVE	
31	60QFB04AA005	25	150	BALL	MANUAL	NA	1	A182 Gr. F304	PLAIN END	12	55	Q1HA1PPP1P-d	60	①	UNIT 6 IA TO CPP POLISHING SYSTEM AREA LINE VALVE	
32	60QFB05AA005	50	150	BALL	MANUAL	NA	1	A182 Gr. F304	PLAIN END	12	55	Q1HA1PPP1P-d	60	①	UNIT 6 IA TO CONDENSER VACUUM PUMP AREA LINE VALVE	
33	60QFB07AA005	50	150	BALL	MANUAL	NA	1	A182 Gr. F304	PLAIN END	12	55	Q1HA1PPP1P-d	60	①	UNIT 6 IA TO MAIN OIL TANK AREA LINE VALVE	
34	60QFB09AA005	50	150	BALL	MANUAL	NA	1	A182 Gr. F304	PLAIN END	12	55	Q1HA1PPP1P-d	60	①	UNIT 6 IA TO TURBINE AREA LINE VALVE	
35	60QFB10AA005	15	150	BALL	MANUAL	NA	1	A182 Gr. F304	PLAIN END	12	55	Q1HA1PPP1P-d	60	①	UNIT 6 IA TO LOT2 EQUIPMENT FOR CHEMICAL INJECTION LINE VALVE	
36	60QFB11AA005	50	150	BALL	MANUAL	NA	1	A182 Gr. F304	PLAIN END	12	55	Q1HA1PPP1P-d	60	①	UNIT 6 IA TO CCCWP AREA LINE VALVE	
37	60QFB12AA005	50	150	BALL	MANUAL	NA	1	A182 Gr. F304	PLAIN END	12	55	Q1HA1PPP1P-d	60	①	UNIT 6 IA TO BFP & HEATER AREA LINE VALVE	
38	60QFB13AA005	15	150	BALL	MANUAL	NA	1	A182 Gr. F304	PLAIN END	12	55	Q1HA1PPP1P-d	60	①	UNIT 6 IA TO LOT2 EQUIPMENT FOR OXYGEN INJECTION (A) LINE VALVE	
39	60QFB14AA005	50	150	BALL	MANUAL	NA	1	A182 Gr. F304	PLAIN END	12	55	Q1HA1PPP1P-d	60	①	UNIT 6 IA TO GENERATOR AUX. AREA LINE VALVE	
40	60QJA10AA005	25	150	BALL	MANUAL	NA	1	ASTM A105	PLAIN END	9	40	Q1HA1PPP1C-d	59	②	N2 SEALING TO UNIT 6 DESUPERHEATER A LINE VALVE	
41	60QJA10AA010	25	150	BALL	MANUAL	NA	1	ASTM A105	PLAIN END	9	40	Q1HA1PPP1C-d	59	②	N2 SEALING TO UNIT 6 DESUPERHEATER B LINE VALVE	
42	60QJA10AA015	25	150	BALL	MANUAL	NA	1	ASTM A105	PLAIN END	9	40	Q1HA1PPP1C-d	59	②	N2 SEALING TO UNIT 6 LP HEATER 2 LINE VALVE	
43	60QJA10AA020	25	150	BALL	MANUAL	NA	1	ASTM A105	PLAIN END	9	40	Q1HA1PPP1C-d	59	②	N2 SEALING TO UNIT 6 LP HEATER 4 LINE VALVE	
44	60QJA10AA025	25	150	BALL	MANUAL	NA	1	ASTM A105	PLAIN END	9	40	Q1HA1PPP1C-d	59	②	N2 SEALING TO UNIT 6 LP HEATER 3 LINE VALVE	
45	60QJA10AA030	50	150	BALL	MANUAL	NA	1	ASTM A105	PLAIN END	9	40	Q1HA1PPP1C-d	59	②	N2 SEALING TO UNIT 6 DEAERATOR LINE VALVE	
46	60QJA10AA035	25	150	BALL	MANUAL	NA	1	ASTM A105	PLAIN END	9	40	Q1HA1PPP1C-d	59	②	N2 SEALING TO UNIT 6 HP HEATER 8A LINE VALVE	
47	60QJA10AA040	25	150	BALL	MANUAL	NA	1	ASTM A105	PLAIN END	9	40	Q1HA1PPP1C-d	59	②	N2 SEALING TO UNIT 6 HP HEATER 8B LINE VALVE	
48	60QJA10AA045	25	150	BALL	MANUAL	NA	1	ASTM A105	PLAIN END	9	40	Q1HA1PPP1C-d	59	②	N2 SEALING TO UNIT 6 HP HEATER 6A LINE VALVE	
49	60QJA10AA050	25	150	BALL	MANUAL	NA	1	ASTM A105	PLAIN END	9	40	Q1HA1PPP1C-d	59	②	N2 SEALING TO UNIT 6 HP HEATER 6B LINE VALVE	
50	60QJA10AA055	25	150	BALL	MANUAL	NA	1	ASTM A105	PLAIN END	9	40	Q1HA1PPP1C-d	59	②	N2 SEALING TO UNIT 6 HP HEATER 7A LINE VALVE	
51	60QJA10AA060	25	150	BALL	MANUAL	NA	1	ASTM A105	PLAIN END	9	40	Q1HA1PPP1C-d	59	②	N2 SEALING TO UNIT 6 HP HEATER 7B LINE VALVE	
52	60QJA10AA067	25	150	BALL	MANUAL	NA	1	ASTM A105	PLAIN END	9	40	Q1HA1PPP1C-d	59	②	N2 SEALING TO UNIT 6 CONDENSATE WATER LINE AFTER LP HEATER 4 VALVE	
53	60QJA10AA082	25	150	BALL	MANUAL	NA	1	ASTM A105	PLAIN END	9	40	Q1HA1PPP1C-d	59	②	N2 SEALING TO UNIT 6 FEED WATER LINE BEFORE DESUPERHEATER B VALVE	
54	60QJA10AA083	25	150	BALL	MANUAL	NA	1	ASTM A105	PLAIN END	9	40	Q1HA1PPP1C-d	59	②	N2 SEALING TO UNIT 6 FEED WATER LINE BEFORE DESUPERHEATER A VALVE	

<Reference Drawing>

① PIPING AND INSTRUMENT DIAGRAM FOR INSTRUMENT AIR DISTRIBUTION SYSTEM

/ TJB56-L1-OFF-C-QFB-M-PID-2112

② PIPING AND INSTRUMENT DIAGRAM LUBE OIL CONDITIONING SYSTEM

/ TJB56-L1-OFF-C-QJA-M-PID-2119

(京浜) 図面管理室 2019/09/13 電子承認システム適用

50QJA10AA005	50QJA10AA045	60QJA10AA005	60QJA10AA045
50QJA10AA010	50QJA10AA050	60QJA10AA010	60QJA10AA050
50QJA10AA015	50QJA10AA055	60QJA10AA015	60QJA10AA055
50QJA10AA020	50QJA10AA060	60QJA10AA020	60QJA10AA060
50QJA10AA025	50QJA10AA067	60QJA10AA025	60QJA10AA067
50QJA10AA030	50QJA10AA082	60QJA10AA030	60QJA10AA082
50QJA10AA035	50QJA10AA083	60QJA10AA035	60QJA10AA083
50QJA10AA040		60QJA10AA040	

Technical performance	
Nominal pressure	150lb
Test pressure of shell	30bar
Test pressure of leakage	22bar
Test Pressure of air leakage	6bar

DESIGN STANDARD	ASME B16.34
FACE TO FACE	Mainfature standard
CONNECTION TYPE	ASME B16.11
INSPECTION & TESTING	API 598

150LB	SIZE		L	H	d	W	D	D1
	DN	in	315	99	25	190	33.4	26.6
	50	2"	360	138	49	300	60.3	52.5

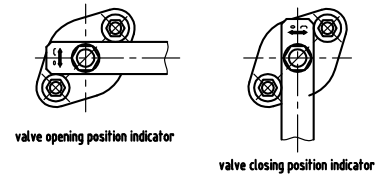
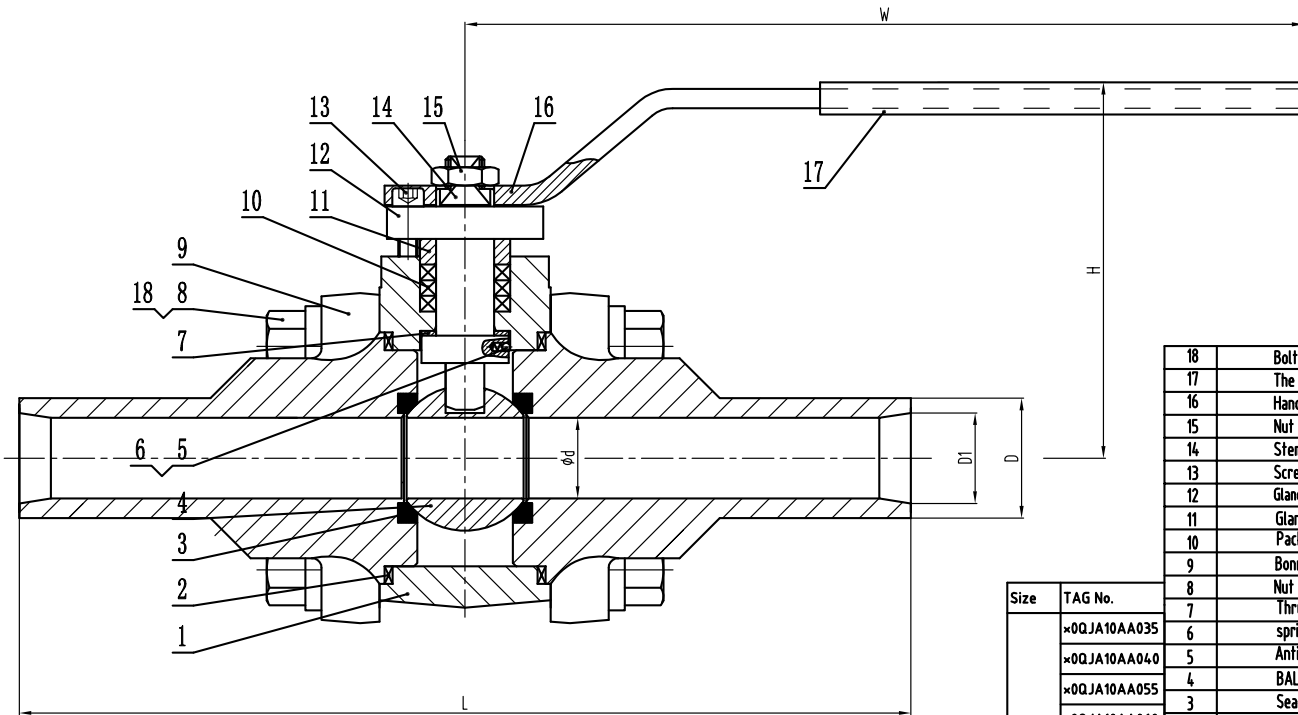

18	Bolt	A193-B7	
17	The handle sleeve	PVC	
16	Hand shank	C.S	
15	Nut	A194-2H	
14	Stem	ASTM A182 F304	
13	Screw	A193-B7	
12	Gland Flange	ASTM A105	
11	Gland	ASTM A182 F304	
10	Packing	FLEXIBLE GRAPHITE	
9	Bonnet	ASTM A105	
8	Nut	A194-2H	
7	Thrust	PTFE	
6	spring	SS316	
5	Anti-static Ball	F316	
4	BALL	ASTM A182 F304	
3	Seaf	PTFE	
2	Bonnet Gasket	SPIRL WOUNDED GRAPHIE+304	
1	Body	ASTM A105	

Size	TAG No.
DN25	×0QJA10AA035
	×0QJA10AA040
	×0QJA10AA055
	×0QJA10AA060
	×0QJA10AA045
	×0QJA10AA050
	×0QJA10AA020
	×0QJA10AA025
	×0QJA10AA015
	×0QJA10AA005
DN50	×0QJA10AA010
	×0QJA10AA030

No.	Name	Material	Remark
02	MYK		2018.12.28
01	MYK		2018.12.18
Rev.	DESIGNER	CHECKER	DATE
Change description			
NOMINAL PRESSURE		150LB	NOMINAL SIZE
BALL VALVE			1"~2"
DRAWING NO.			Q1HA1PPP1C-d

× shall be "5" for unit5 and "6" for unit6

SUFA TECHNOLOGY INDUSTRY Co.,LTD.CNCC

校核	
審圖	
田島昭志	
尾野隆幸	
日期	簽字
RA10A	