

1/2" DR. HAND SOCKET 6 PT / 12 PT

1/2" DR. KUNCI SOCK 6 PT / 12 PT

ITEM CODE		SIZE	1 (mm)	2 (mm)	3 (mm)	4 (mm)	5 (mm)	6 (mm)	WEIGHT (gr)	QTY / BOX INNER/MASTER
6 PT	12 PT									
SC-SC0374	SC-SC0398	8 mm	37	22	13	21	12	8	47	10 / 320 pcs
SC-SC0375	SC-SC0399	9 mm	38	21	13	22	15	9	53	10 / 320 pcs
SC-SC0376	SC-SC0400	10 mm	38	21	13	22	15	10	53	10 / 320 pcs
SC-SC0377	SC-SC0401	11 mm	38	20	13	22	17	11	50	10 / 320 pcs
SC-SC0378	SC-SC0402	12 mm	38	21	13	21	18	12	52	10 / 320 pcs
SC-SC0379	SC-SC0403	13 mm	37	22	13	21	18	13	53	10 / 320 pcs
SC-SC0380	SC-SC0404	14 mm	38	22	13	23	25	14	53	10 / 320 pcs
SC-SC0381	SC-SC0405	15 mm	38	22	13	20	21	15	53	10 / 320 pcs
SC-SC0382	SC-SC0406	16 mm	37	22	13	20	21	16	54	10 / 320 pcs
SC-SC0383	SC-SC0407	17 mm	37	22	13	21	23	17	63	10 / 320 pcs
SC-SC0384	SC-SC0408	18 mm	37	22	13	22	25	18	76	10 / 200 pcs
SC-SC0385	SC-SC0409	19 mm	38	22	13	22	25	19	77	10 / 200 pcs
SC-SC0386	SC-SC0410	20 mm	37	22	13	23	27	20	77	10 / 200 pcs
SC-SC0387	SC-SC0411	21 mm	37	22	13	23	27	21	74	10 / 200 pcs
SC-SC0388	SC-SC0412	22 mm	40	22	13	25	29	22	99	10 / 200 pcs
SC-SC0389	SC-SC0413	23 mm	40	23	13	28	32	23	114	10 / 200 pcs
SC-SC0390	SC-SC0414	24 mm	40	23	13	27	31	24	118	5 / 160 pcs
SC-SC0391	SC-SC0415	25 mm	40	23	13	28	30	25	129	5 / 100 pcs
SC-SC0392	SC-SC0416	26 mm	42	25	13	29	35	26	154	5 / 100 pcs
SC-SC0393	SC-SC0417	27 mm	42	26	13	29	35	27	166	12 / 120 pcs
SC-SC0394	SC-SC0418	28 mm	43	28	13	33	37	28	170	5 / 100 pcs
SC-SC0395	SC-SC0419	29 mm	42	27	13	33	37	29	189	5 / 100 pcs
SC-SC0396	SC-SC0420	30 mm	44	30	13	33	39	30	198	5 / 80 pcs
SC-SC0397	SC-SC0421	32 mm	44	29	13	35	41	32	223	5 / 80 pcs

- Chrome vanadium material
- Drop Forged for greater strength
- Anti-rust finishing, greater strength and with knurling design for extra grip
- Silver matt finish
- Stress relief design

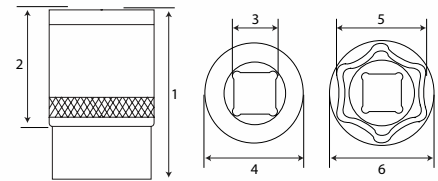

3/4" DR. HAND SOCKET 6 PT / 12 PT

3/4" DR. KUNCI SOCK 6 PT / 12 PT

ITEM CODE		SIZE	1 (mm)	2 (mm)	3 (mm)	4 (mm)	5 (mm)	6 (mm)	WEIGHT (gr)	QTY / BOX INNER/MASTER
6 PT	12 PT									
SC-SC0422	SC-SC0442	19 mm	49	29	19	35	29	19	213	5 / 75 pcs
SC-SC0423	SC-SC0443	21 mm	49	30	19	36	32	21	218	5 / 75 pcs
SC-SC0424	SC-SC0444	22 mm	49	30	19	36	32	22	213	5 / 75 pcs
SC-SC0425	SC-SC0445	23 mm	49	30	19	35	33	23	220	5 / 75 pcs
SC-SC0426	SC-SC0446	24 mm	49	30	19	36	34	24	221	5 / 75 pcs
SC-SC0427	SC-SC0447	26 mm	50	30	19	35	36	26	227	5 / 75 pcs
SC-SC0428	SC-SC0448	27 mm	51	32	19	35	37	27	227	5 / 75 pcs
SC-SC0429	SC-SC0449	28 mm	51	32	19	37	38	28	240	4 / 60 pcs
SC-SC0430	SC-SC0450	29 mm	51	31	19	37	39	29	244	4 / 60 pcs
SC-SC0431	SC-SC0451	30 mm	53	53	19	37	41	30	284	4 / 60 pcs
SC-SC0432	SC-SC0452	32 mm	56	36	19	38	43	32	307	4 / 60 pcs
SC-SC0433	SC-SC0453	33 mm	55	34	19	38	46	33	337	4 / 60 pcs
SC-SC0434	SC-SC0454	34 mm	57	37	19	38	47	34	357	4 / 60 pcs
SC-SC0435	SC-SC0455	36 mm	58	34	19	42	50	36	439	3 / 36 pcs
SC-SC0436	SC-SC0456	38 mm	59	39	19	45	52	38	486	3 / 36 pcs
SC-SC0437	SC-SC0457	41 mm	63	39	19	45	56	41	576	3 / 36 pcs
SC-SC0438	SC-SC0458	46 mm	67	44	19	48	61	46	712	2 / 20 pcs
SC-SC0439	SC-SC0459	50 mm	72	46	19	47	67	50	863	2 / 20 pcs
SC-SC0440	SC-SC0460	55 mm	72	47	19	48	67	55	1,034	1 / 20 pcs
SC-SC0441	SC-SC0461	60 mm	78	52	19	48	81	60	1,245	1 / 20 pcs

- Chrome vanadium material
- Drop Forged for greater strength
- Anti-rust finishing, greater strength and with knurling design for extra grip
- Silver matt finish
- Stress relief design

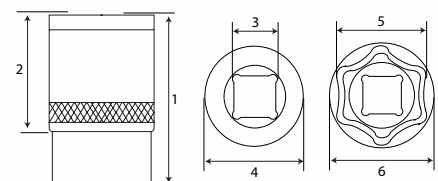

WRENCH

TORQUE

SOCKET

IMPACT SOCKET

PLIER

SCREWDRIVER