

FEATURES PICTORIALLY TYPICAL ORIENTATION MAY DIFFER

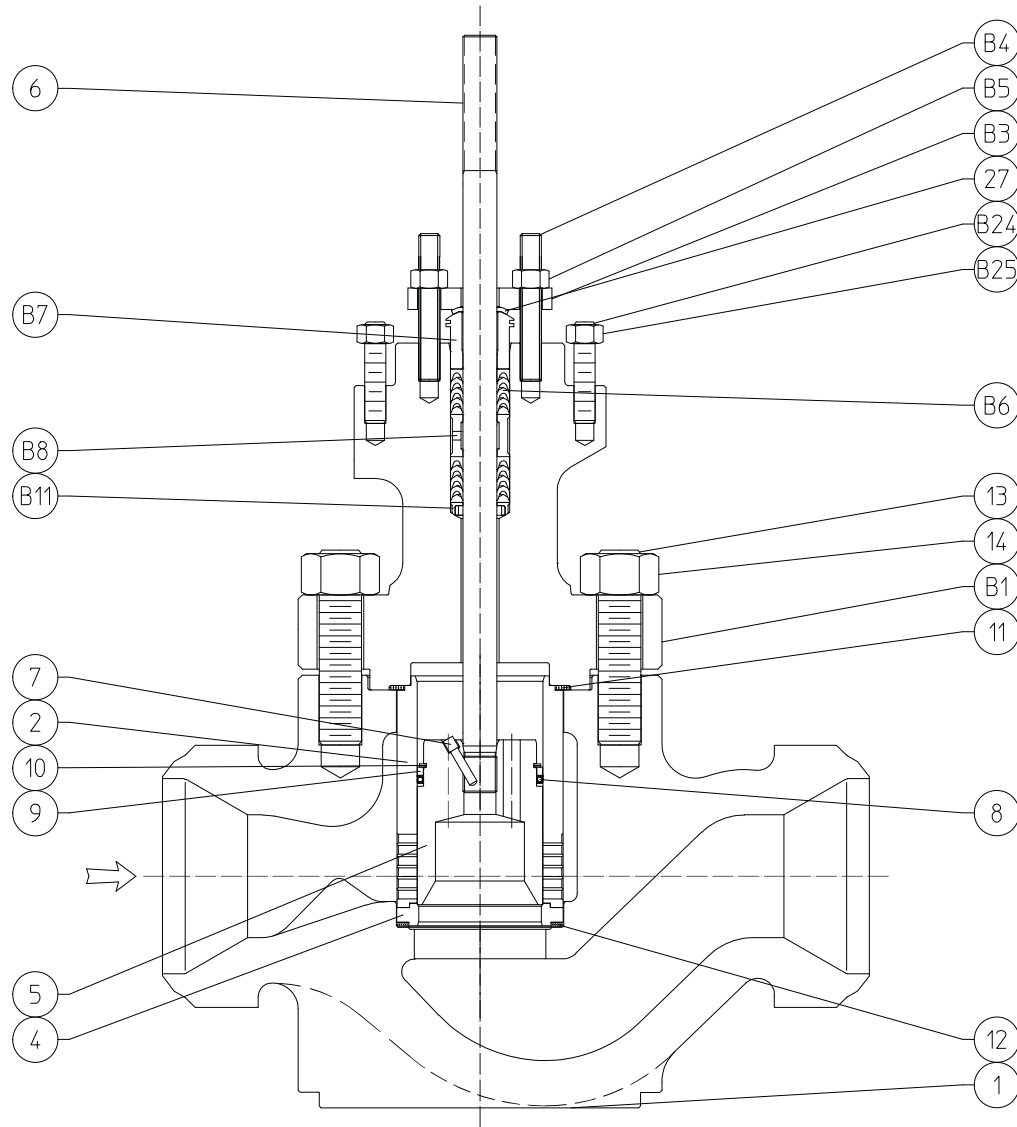

KEY	PART NAME	QTY	MATERIAL	COMMENT
1	BODY	1	ASTM A217M GR WC9	
2	CAGE	1	ASTM A564M S17400	
4	SEAT RING	1	ASTM A582M S41600	
5	PLUG	1	ASTM A582M S41600	
6	STEM	1	ASME SA479 S20910	
7	GROOVE PIN	1	ASTM A479M S31600	
8	SEAL RING	1	N10276/PTFE, G, M	
9	BACK-UP RING	1	ASTM A582M S41600	
10	RETAINING RING	1	18-8 SST	
11	BONNET GASKET	1	N06600/GRAPHITE	
12	SEAT RING GASKET	1	N06600/GRAPHITE	
13	BONNET STUD	8	ASME SA193 B7/NCF2	
14	BONNET NUT	8	ASME SA194 2H/NCF2	
27	WIPER	1	FELT	
B1	BONNET	1	ASTM A217M WC9	
B3	PACKING FLANGE	1	316 SST	
B4	PACKING STUD	2	ASTM A193M B8M CL2	
B5	PACKING NUT	2	S31600	
B6	PACKING SET	2	PTFE	
B7	PACKING FOLLOWER	1	316 SST	
B8	LANTERN RING	1	316 SST	
B11	PACKING BOX RING	1	316 SST	
B24	YOKE STUD	8	ASME SA193 B7/NCF2	
B25	YOKE NUT	8	ASTM A563 B/ZN PL	

		FISHER DATE 8/2/18	
CUST: Mitsubishi Hitachi Power Systems, Ltd./Kure CUST REF NO.: (XTJB)5:13127328 FISHER REF NO.: 171873-01 TAG NO.: 50LAF03AA201		HPT VALVE BODY ASSEMBLY NPS 4 CL1500 BWE STD BONNET Linear 1 in Stem PTFE Double Assy-1 PACKING FLOW DIRECTION : DOWN	
SERIAL NO.: J229033 CUST ITEM: 9			
		DWN. ADS 6/20/18	ITEM 009
		CHKD. DHI 6/20/18	DWG. NO.
		APVD. TAK 6/20/18	171873-01-009
		SCALE: NONE	REV. 01
Nippon Fisher Co., Ltd. 2018			