

[図面管理登録済 (MC)]

REFERENCE DRAWING
 (1) SECTION DRAWING FOR MBFP FLUID COUPLING
 TJB56-L1-OFF-C-LAC-M-DRD-2709

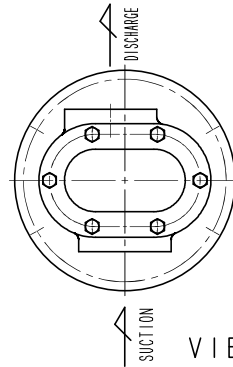
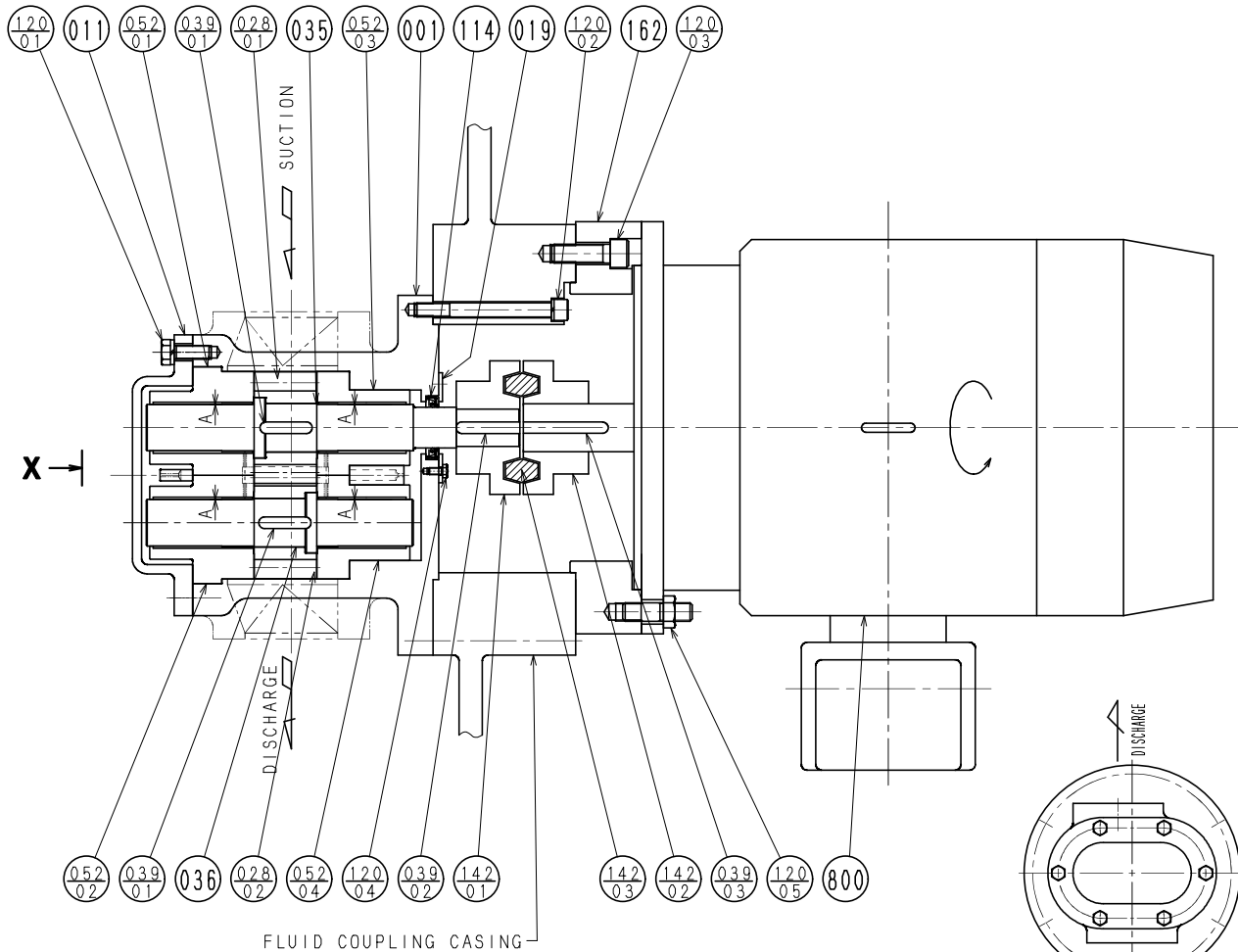

CLEARANCE TABLE		
No.	PART	DESIGN DIAMETRAL CLEARANCE (mm)
A	SHAFT-BEARING	0.080-0.116

MBFP AUXILIARY OIL PUMP KKS CODE	
50LAV50	AP020
60LAV50	AP020

REVISIONS				
No.	DESCRIPTION	DATE	BY	APP.
△	REVISED	Apr. 5.16	Y. K.	Y. K.
△	ISSUED FOR USE	Apr. 6.16	Y. K.	Y. K.

NO.	NAME OF PART	MATERIAL (JIS)	MATERIAL (ASTM equiv.)	Q'TY FOR 1 SET	REMARKS
800	ELECTRIC MOTOR	-	-	1	
162	MOTOR BRACKET	SS400	A283 Gr. D	1	
142-03	COUPLING RUBBER	RUBBER	RUBBER	1	
142-02	COUPLING	FC200	A48 CL. 30	1	MH-130
142-01	COUPLING	FC200	A48 CL. 30	1	
114	OIL SEAL	VITON	VITON	1	D55Xd35XT11
120-05	BOLT (M16X40)	SS400	A283 Gr. D	4	HEX
120-04	BOLT (M6X12)	SS400	A283 Gr. D	8	HEX
120-03	BOLT (M16X40)	SCM435	A322 4140	6	ALLEN
120-02	BOLT (M12X45)	SCM435	A322 4140	6	ALLEN
120-01	BOLT (M12X35)	SS400	A283 Gr. D	6	HEX
052-04	PUMP BEARING	S25C+WJ2	A576 1025+B23 (NO. 3)	1	
052-03	PUMP BEARING	S25C+WJ2	A576 1025+B23 (NO. 3)	1	
052-02	PUMP BEARING	S25C+WJ2	A576 1025+B23 (NO. 3)	1	
052-01	PUMP BEARING	S25C+WJ2	A576 1025+B23 (NO. 3)	1	
039-03	KEY	S50C	A576 1050	1	
039-02	KEY	S50C	A576 1050	1	
039-01	KEY	S50C	A576 1050	2	
036	PUMP DRIVEN SHAFT	S45C	A576 1045	1	
035	PUMP DRIVE SHAFT	S45C	A576 1045	1	
028-02	PUMP GEAR	S45C	A576 1045	1	
028-01	PUMP GEAR	S45C	A576 1045	1	
019	OIL SEAL COVER	SS400	A283 Gr. D	1	
011	CASING COVER	FC200	A48 CL. 30	1	
001	GEAR PUMP CASING	FC300	A48 CL. 40	1	

DESIGN DATA

FLOWRATE	590L/min
DIS. PRESSURE	4 barg
SUC. PRESSURE	-0.5 barg
SPEED	1470 rpm
TEMPERATURE	0-80 deg C

APPROX. MASS (kg)

AUX. OIL PUMP	75
MOTOR	171

EBARA SER. No. R170411906. R170411912		CUSTOMER Toshiba Energy Systems & Solutions Corporation	
MODEL GCH105A-60DL		SET 1+1	
APP'D BY Y. KATAYA Oct.12.17		FINAL USER PT. Bhumi Jati Power	
DSN'D BY Y. KATAYA Oct.12.17		TITLE SECTIONAL DRAWING FOR MBFP AUXILIARY OIL PUMP	
CHK'D BY		SCALE 1:100	
DRAWN BY Y. KATAYA Oct.12.17		DWG. No. PR170411906/922	
EBARA CORPORATION		REV. 0	