

## NRT14系列

有填料封闭管式圆筒形帽熔断器

执行标准:GB13539.2;IEC60269-2

## NRT14 series

Closed Cartridge Cylinder form cap fuse with stuffing

Execution Standard: Gb13539.2;IEC60269-2



### ■ 特征与用途 Characteristics and Application

NRT14有填料封闭管式圆筒形帽熔断器（以下简称熔断器）主要由熔断体及底座组成。熔断器置于交流50Hz、额定电压为380V、额定电流至63A的交流电路,主要适用于配电设备中作为线路的过载及短路保护之用。

NRT14 closed cartridge cylinder form cap fuse with stuffing (hereinafter referred to as fuse) is mainly consisted of fuse link and seat, fuse is installed in AC 50Hz, rated voltage 380V, rated current up to 63A AC circuit, mainly used as line overload and short circuit protection for power distribution equipment.

### ■ 型号及含义 Type and Definition

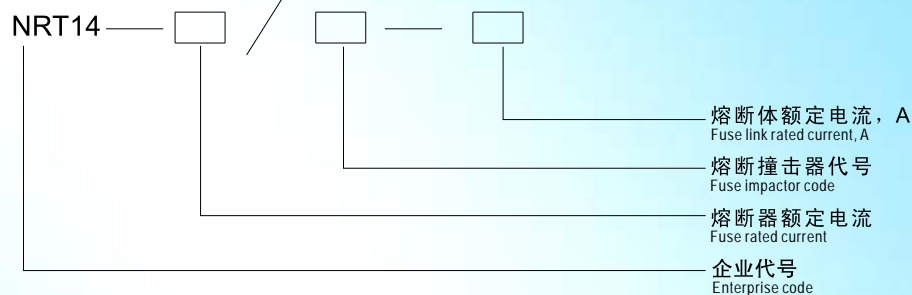

■ 基本参数 Basic Data

额定电压 Rated Voltage V	额定电流 Rated current A		额定分断能力 Rated breaking capacity		额定功率 Rated Power W	
	支持件(座) Support (seat)	熔断体(芯) Fuse link (core)	I <sub>1</sub> kA	cosφ	支持件额定接受功率 Support piece rated receiving power	熔断体额定耗散功率 Fuse link rated consuming power
380	20	2,4,6,10、16,20	100	0.1-0.2	≥3	≤3
	32	2,4,6,10,16、20,25,32			≥5	≤5
	63	10,16,20,25、32,40,50,63			≥9.5	≤9.5

■ 外形尺寸安装尺寸 Appearance dimension installation dimension

NRT14系列熔断体外形尺寸  
NRT14 series Fuse link appearance dimension

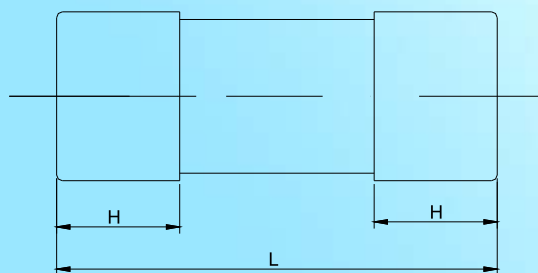

尺码 Size	额定电流 Rated current A	L	H <sub>max</sub>	∅	型号 Type	名称 Name
10x38	20	38±0.6	10.5	10.3±0.1	NRT 14-20	芯 core
14x51	32	51 <sup>+0.6</sup> <sub>-1.0</sub>	13.8	14.3±0.1	NRT 14-32	芯 core
22x58	63	58 <sup>+0.1</sup> <sub>-2.0</sub>	16.2	22.2±0.1	NRT 14-63	芯 core

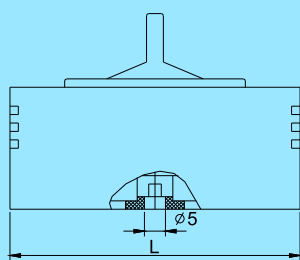

● NRT14-20螺钉固定式支持件  
NRT14-20 screw fixing type support piece

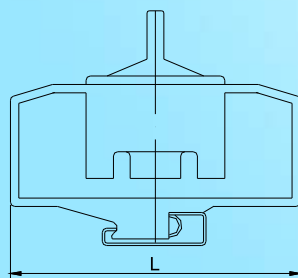
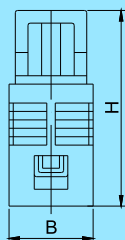

● NRT14-20安装轨固定式支持件  
NRT14-20 Installing rail fixing type support piece

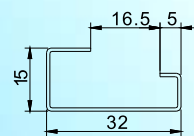
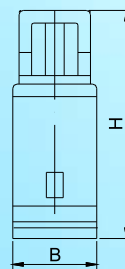

● 20A安装轨尺寸  
20A Installing rail dimensions

- NRT14-32、63螺钉固定式支持件  
NRT14-32, 63 screw fixed type support piece

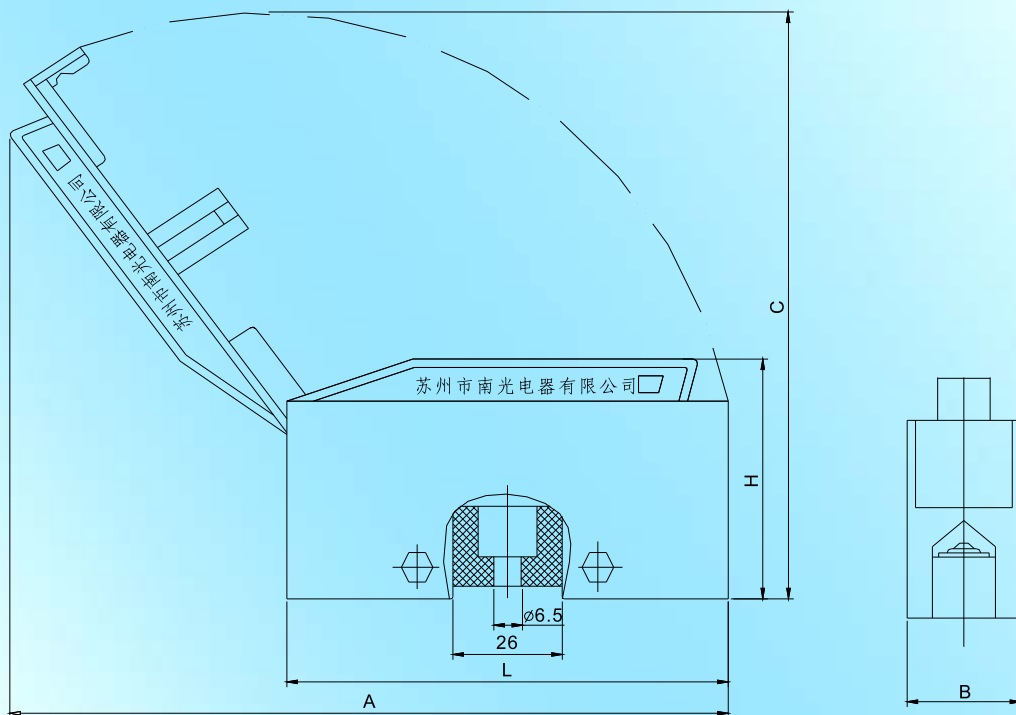

NRT14(RT14)-20多种安装轨固定式支持件  
NRT14(RT14)-20 multi-installing rail fixed type support piece

本结构形式已获国家专利：ZL200630127968.7  
This structure form has obtained national patent

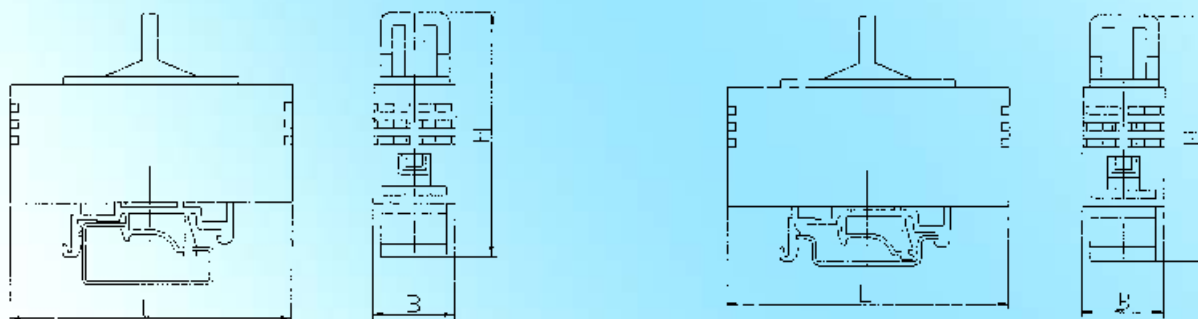

NRT14系列支持件(座)外形安装尺寸

NRT14 series support piece(seat) appearance installation dimensions

mm

型号名称 Type Name 座 Seat	支持件规格 Support piece Specification A	外形尺寸及安装尺寸 Appearance dimension and Installation dimension					安装方式 Installation method	
		Amax	Bmax	Cmax	Lmax	Hmax		
NRT14(RT14)-20	20		22		75	50	螺钉固定式 Screw fixed	
					85	70		安装轨固定式 Installing rails
					75	60		
NRT14(RT14)-32	32	170	30	138	107	60	螺钉固定式 Screw fixed	
NRT14(RT14)-63	63	200	37	160	127	70		

■ 订货须知：用户须提供下列信息：

- 产品型号、规格；
- 对支持件（座）须注明安装方式；例螺钉固定或安装轨固定；
- 对熔断体（芯）须注明电流等级；

■ Ordering note: clients have to provide information as in the following:

- Product type, specification
- For support piece(seat), installation method should be noted, such as screw fixed or installation rails fixed
- For fuse link(core), current grade should be noted

■ 外形安装尺寸 Appearance installation dimensions

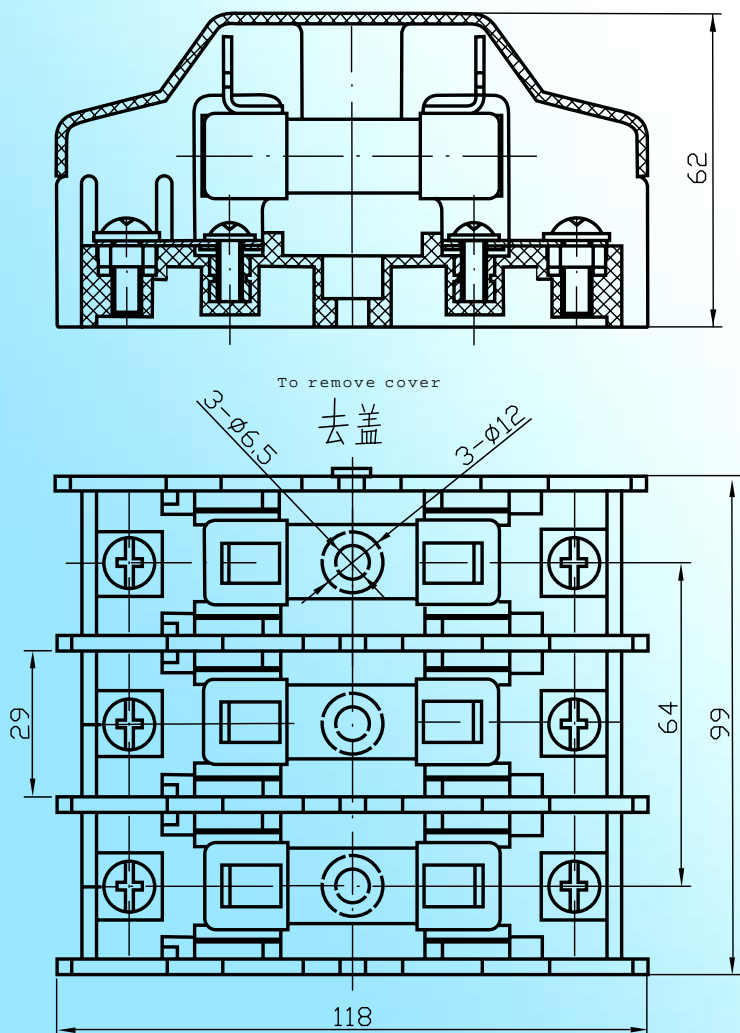

说明

NRT14(RT14)-63(125)J型三极联体固定式安装底座是本公司根据用户需要新开发的产品，并已获得国家受理二项专利；

外观设计专利，受理号为：200830184421.X

实用新型专利，受理号为：200820185409.5

该底座采用DMC材料，不但可安装尺码为22x58、电流为10-63A(gG型)熔断体(熔芯)而且还可以安装尺码为22x58、电流为10-125A(aM gF型)熔断体(熔芯)。

Description

NRT14(RT14)-63(125) J Type Three Pole Compact Fixed Installation Seat is a newly developed product of our company according to client's needs, and had been accepted by national patent for two items;

Appearance design patent, acceptance No: 200830184421.X

Practical new type patent, acceptance No: 200820185409.5

The seat adopts DMC material, not only for installation of size 22x58, current 10-63A (gG Type) fuse link (fusing core) but also for installation of size 22x58, current 10-125A (aM gF Type) fuse link (fusing core).