

(※1) WORK NO. BK1BA88
Wide range of mountain.

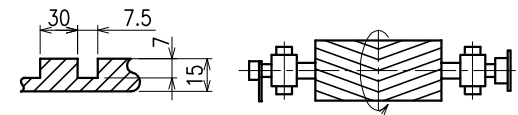

DETAIL of LAGGING

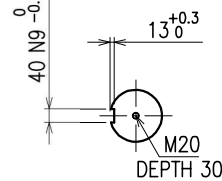

(※2) Labyrinth seal
(※3) IUUK SUPPLY

14	BOLT, WASHER	SS400	2	M16× 40L
13	END PLATE	SS400	1	t9
12	PARALLEL KEY	S45C	1	28× 16× 104
※3 11	BACK-STOP CAM CLUTCH	—	1	BS110/BS110TA
10	PARALLEL KEY	S45C	1	40× 22× 190
※3 9	COUPLINGS	—	1	NSS-315
※3 8	PLUMMER BLOCK	—	1	SD3038+23038K;H3038(※2)
※3 7	PLUMMER BLOCK	—	1	SD3038G+23038K;H3038(※2)
6	PARALLEL KEY	S45C	2	
5	LAGGING	NR	1	t15 DOUBLE HELICAL(※1)
4	SHAFT	S45C	1	φ 190
3	BOSS	S25C	2	
2	WEB	SS400	2	
1	SHELL	STK400	1	φ 609.6

PARTS No.	NAME OF PARTS	MATERIAL	UNIT	SIZE
番号	品名	材料	数量	寸法
APPR 承認 Y.Ezoe	OWNER 発注先 IHI Transport Machinery Co.,Ltd.			
CHK'D 確認 T.Sonda	NAME 名称 Tanjung Jati B			
DRAWN 製図 N.Sugimoto	2500t/h CSU			
DATE 作成日 Oct/3/2018	Boom Conveyor (BW1600)			
SCALE 尺 1:15	DRIVE PULLEY			
製 作 数 SET(S)	JOB No.	DWG. NO. 図番		
2		B-PD18A25-01		B

JRC CO., LTD. 株式会社 JRC

Uncontrolled when printed or downloaded. Verify that this is the correct version before use.

Reproduction of part or all the contents of the document is prohibited without written permission from PT. Bhumi Jebara Service