

- 1.- AIR FILTER
- 2.- BLOWER
- 3.- BASE SILENCER
- 4.- RUBBER SLEEVE
- 5.- NON-RETURN VALVE DN-100
- 6.- RELIEF VALVE DN-80
- 7.- PROTECTION GUARD
- 8.- ELECTRIC MOTOR
- 9.- FLEXIBLE MACHINE FEET
- 10.- ACOUSTIC ENCLOSURE
- 11.- ELECTRIC FAN SODECA HEP-31-2T
- 12.- CONNECTING PIPE WITH FLANGE
- 13.- PRESSURE GAUGE
- 14.- VACUUM GAUGE
- 15.- OIL TANK
- 16.- FLANGE PIPE DN-4" ANSI 150lbs RF

Weight group without Motor: 420Kg  
 Weight Enclosure: 250Kg  
 Weight motor: 225Kg  
 Total: 895Kg

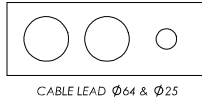
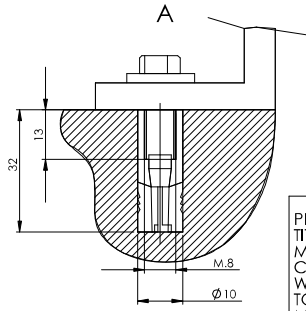

**NOTE:**  
 • Dimensions are in mm  
 • General tolerance ±10mm  
 Free space for maintenance work at front side of unit 800mm min.

	PACKAGE	ENCLOSURE	MOTOR
COLOUR	RAL 5012	RAL 7039/7044	RAL 5014
THICKNESS	320 microns	40 microns	90 microns

OF-104.095 TAG N°: 50 LDC 10 AN010 / 50 LDC 20 AN010  
 SERIAL N°- 39235 / 39236  
 OF-104.097 TAG N°: 60 LDC 10 AN010 / 60 LDC 20 AN010  
 SERIAL N°- 39239 / 39240

PROJECT - N° 162.039  
 TITLE - Condensate Polishing Blower  
 MODEL - Compact Group PG-30 F1 RNT-32.20 pressure DN-100  
 CAPACITY - 19.6 m³/min  
 WEIGHT - 895 Kg  
 TOTAL HEAD - 1.550 Kg  
 MOTORS - 3000/min 37kw IE3 380-660V 50Hz IP55 B3

Rev	Descripción	Nombre	Fecha	Material
E	-	-	-	-
D	General Update	V.R.L.	24/05/19	
C	General Update	V.R.L.	24/01/19	
B	General Update	V.R.L.	23/01/19	
A	Updated drawing	V.R.L.	16/03/18	

Rev	Descripción	Nombre	Fecha	Material

Rev	Nombre	Fecha	Escala:	Hoja	N° Plano
Dibujado	V.R.L.	21/02/18	Scale:	1 de 1	G-026.020
Drawn			1:9	Sheet	
Revisado	-	-	DIN A2	1 of 1	

