

4-Bolt Flange Units

UCF

Cylindrical bore (with set screws)
d (45) ~ (75) mm

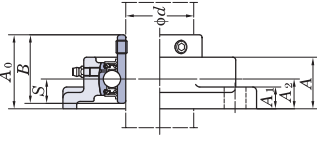
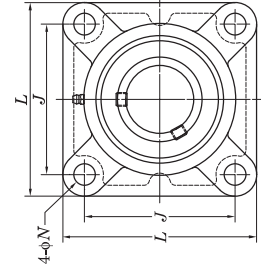

With Pressed Steel Cover

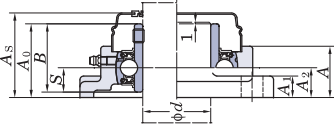

With Cast Iron Cover

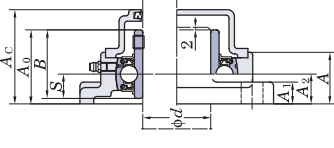

Variations of tolerance of distance from mounting surface to center of spherical bore (Δ_{hs}) and tolerance of position of bolt hole (Δ)

Housing No.	Δ_{hs}	Δ	Unit
F204~F210	FX05~FX10	F305~F310	±0.5
F211~F218	FX11~FX20	F311~F328	±0.8
			1

Variations of tolerance of bolt hole diameter (Δ_{hs})

Housing No.	Δ_{hs}	Unit	
F204~F218	FX05~FX18	F305~F315	±0.2
	FX20	F316~F328	±0.3

Shaft Dia. mm inch	Dimensions inch mm										Bolt Size inch mm	Standard Housing No.		Bearing No.	Basic Load Ratings kN		Factor	With Pressed Steel Cover		With Cast Iron Cover		Mass kg
	L	A	J	N	A ₁	A ₂	A ₀	B	S	Unit No.		Housing No.	Mass kg		C _r	C _{br}		Open Type	Closed Type	Unit No.	Open Type	
45	1 3/4	6 5/16	1 23/32	4 59/64	3/4	23/32	63/64	2 3/8	2.244	0.866	5/8	F309	UCF309-28	UC309-28	48.9	29.5	13.3	UCF309C	UCF309D	76	3	4.6
	1 7/8	5 7/8	1 9/16	4 3/8	5/8	55/64	2 5/32	2.031	0.748	1/2	F210	UCF210-30	UC210-30	2.5	2.5	14.4	UCF210C	UCF210D	59	2 5/16	2.5	
	1 15/16	143	40	111	16	22	54.6	51.6	19	M14		UCF210	UC210	2.5	2.5	14.4	UCF210C	UCF210D	70.5	2 25/32	3.0	
	2	162	44	130	19	20	59.4	55.6	22.2	M16		UCF210-32	UC210-32	2.5	2.5	14.4	UCF210C	UCF210D	70.5	2 25/32	3.0	
50	1 15/16	6 3/8	1 23/32	5 1/8	3/4	25/32	1 1/32	2.189	0.874	5/8	FX10	UCFX10-31	UCX10-31	3.7	43.4	29.4	14.4	UCFX10C	UCFX10D	64	2 17/32	3.7
	2	162	44	130	19	20	59.4	55.6	22.2	M16		UCFX10	UCX10	3.7	43.4	29.4	14.4	UCFX10C	UCFX10D	64	2 17/32	3.7
	2	175	48	132	23	19	28	61	22	M20		UCFX10-32	UCX10-32	5.1	62.0	38.3	13.2	UCFX10C	UCFX10D	83	3 9/32	5.9
	2	162	43	130	19	18	25	58.4	55.6	22.2	M16		UCFX10-31	UCX10-31	3.4	43.4	29.4	14.4	UCFX10C	UCFX10D	74.5	2 15/16
55	2 3/16	6 7/8	1 15/16	5 5/8	3/4	25/32	1 9/64	2.563	1.000	5/8	FX11	UCFX11	UCX11	4.9	52.4	36.2	14.4	UCFX11C	UCFX11D	73.5	2 29/32	4.9
	2 1/8	175	49	143	19	20	68.7	65.1	25.4	M16		UCFX11-35	UCX11-35	4.9	52.4	36.2	14.4	UCFX11C	UCFX11D	73.5	2 29/32	4.9
	2 1/4	185	52	140	23	20	71	66	25	M20		UCFX11-36	UCX11-36	5.6	71.6	45.0	13.2	UCFX11C	UCFX11D	87	3 7/16	6.5
	2 3/16	175	49	143	19	20	68.7	65.1	25.4	M16		UCFX11-35	UCX11-35	5.6	71.6	45.0	13.2	UCFX11C	UCFX11D	87	3 7/16	6.5
60	2 1/4	6 7/8	1 7/8	5 5/8	3/4	23/32	1 9/64	2.563	1.000	5/8	F212	UCF212	UC212	4.2	52.4	36.2	14.4	UCF212C	UCF212D	73.5	2 29/32	4.2
	2 3/8	175	48	143	19	18	29	68.7	65.1	M16		UCF212	UC212	4.2	52.4	36.2	14.4	UCF212C	UCF212D	73.5	2 29/32	4.2
	2 7/16	185	52	140	23	20	71	66	25	M20		UCF212-38	UC212-38	4.2	52.4	36.2	14.4	UCF212C	UCF212D	73.5	2 29/32	4.2
	2 1/4	185	52	140	23	20	71	66	25	M20		UCF212-39	UC212-39	4.2	52.4	36.2	14.4	UCF212C	UCF212D	73.5	2 29/32	4.2
65	2 7/16	7 7/8	2 5/16	5 59/64	3/4	13/16	1 11/32	2.563	1.000	5/8	FX12	UCFX12	UCX12	5.7	57.2	40.1	14.4	UCFX12C	UCFX12D	78.5	3 3/32	5.7
	2 7/8	187	59	149	19	21	34	73.7	65.1	M16		UCFX12	UCX12	5.7	57.2	40.1	14.4	UCFX12C	UCFX12D	78.5	3 3/32	5.7
	2 7/16	187	59	149	19	21	34	73.7	65.1	M16		UCFX12-39	UCX12-39	6.9	81.9	52.2	13.2	UCFX12C	UCFX12D	95	3 3/4	8.1
	2 7/16	195	56	150	23	22	33	78	71	M20		UCFX12-39	UCX12-39	6.9	81.9	52.2	13.2	UCFX12C	UCFX12D	95	3 3/4	8.1
70	2 1/2	7 7/8	1 31/32	5 59/64	3/4	7/8	1 3/16	2.563	1.000	5/8	F213	UCF213	UC213	5.2	57.2	40.1	14.4	UCF213C	UCF213D	74.5	2 15/16	5.2
	2 1/2	187	59	149	19	21	34	73.7	65.1	M16		UCF213	UC213	5.2	57.2	40.1	14.4	UCF213C	UCF213D	74.5	2 15/16	5.2
	2 1/2	187	59	149	19	21	34	73.7	65.1	M16		UCF213-40	UC213-40	6.3	62.2	44.1	14.5	UCF213C	UCF213D	83.5	3 9/32	6.3
	2 1/2	187	59	149	19	21	34	73.7	65.1	M16		UCF213-40	UC213-40	6.3	62.2	44.1	14.5	UCF213C	UCF213D	83.5	3 9/32	6.3
75	2 3/4	7 19/32	2 1/8	5 63/64	3/4	7/8	1 7/32	2.937	1.189	5/8	F214	UCF214	UC214	7.8	92.7	59.9	13.2	UCF214C	UCF214D	80.5	3 5/32	7.8
	2 3/4	193	54	152	19	22	31	75.4	74.6	M16		UCF214	UC214	7.8	92.7	59.9	13.2	UCF214C	UCF214D	80.5	3 5/32	7.8
	2 3/4	197	60	152	23	22	37	81.5	77.8	M20		UCF214-44	UCX14-44	7.0	67.4	48.3	14.5	UCF214C	UCF214D	93	3 21/32	6.8
	2 3/4	197	60	152	23	22	37	81.5	77.8	M20		UCF214-44	UCX14-44	7.0	67.4	48.3	14.5	UCF214C	UCF214D	93	3 21/32	6.8
75	2 3/4	8 29/32	2 13/32	7 1/64	63/64	31/32	1 27/64	3.071	1.299	7/8	F314	UCFX14	UCX14	10.1	104	68.2	13.2	UCFX14C	UCFX14D	86.5	3 13/32	7.0
	2 15/16	226	61	178	25	25	36	81	78	M22		UCFX14	UCX14	10.1	104	68.2	13.2	UCFX14C	UCFX14D	86.5	3 13/32	7.0
	2 15/16	200	56	159	19	22	34	78.5	77.8	M16		UCFX14-47	UCX14-47	6.4	67.4	48.3	14.5	UCFX14C	UCFX14D	98	3 27/32	11.2
	2 15/16	197	68	152	23	24	40	89.3	82.6	M20		UCFX14-48	UCX14-48	6.4	67.4	48.3	14.5	UCFX14C	UCFX14D	98	3 27/32	11.2

Remarks 1. In Part No. of unit and units with covers, fitting codes follow bore diameter numbers. (See Table 10.5 in P62.)

2. Part No. of applicable grease fittings are shown below.

A-1/4-28UNF 201~210, X05~X09, 305~308

A-R1/8 211~218, X10~X20, 309~328

3. As for the triple seal type product (from 201 to 205 are the double seal type products), suffix code L3 (L2) follows the Part No. of unit or bearing.

(Example of Part No.: UCF206JL3, UC206L3)

4. For the dimensions and forms of applicable bearings, see the dimensional tables of ball bearing for unit.

5. Housings of nodular graphite cast iron are also available.

Appendix Table 17 Ball Bearing Units Interchange Guide

17.1 Pillow Block Units

	FYH · JTEKT	ASAHI	NTN
With pressed steel cover	UCP2·C UCP2·CD	UCP2·C UCP2·E	S-UCP2·D1 SM-UCP2·D1
With cast iron cover	UCP2·FC UCP2·FCD UCP3·C UCP3·CD	CUCP2·C CUCP2·CE CUCP3·C CUCP3·CE	C-UCP2·D1 CM-UCP2·D1 C-UCP3·D1 CM-UCP3·D1
Thick Pillow Block Units	UCIP2· UCIP3·	UCIP2· UCIP3·	UCIP2· UCIP3·
Tapped-Base Pillow Block Units	UCPA2·	UCPA2·	UCUP2·D1
High-Base Pillow Block Units	UCPH2·	UCPH2·	UCHP2·D1
Light Pillow Block Units	BLP2· ALP2·	BLLP·	ASPB2· AELPB2·
Compact Pillow Block Units	UP0·	UP0·	
Corrosion resistant series Pillow Block Units	UCSP2·H1S6 UCSPA2·H1S6 USP0·S6	MUCP2· MUCPA2	
Stamped Steel Pillow Block Units	SBPP2· SAPP2·	BPP·	ASPP2· AELPP2·

17.2 Flange Units

	FYH · JTEKT	ASAHI	NTN
With pressed steel cover	UCF2·C UCF2·D UCFC2·C UCFC2·D UCFL2·C UCFL2·D	UCF2·C UCF2·E UCFC2·C UCFC2·E UCFL2·C UCFL2·E	S-UCF2·D1 SM-UCF2·D1 S-UCFC2·D1 SM-UCFC2·D1 S-UCFL2·D1 SM-UCFL2·D1
With cast iron cover	UCF2·FC UCF2·FD UCF3·C UCF3·D UCFC2·FC UCFC2·FD UCFS3·C UCFS3·D UCFL2·FC UCFL2·FD UCFL3·C UCFL3·D	CUCF2·C CUCF2·CE CUCF3·C CUCF3·CE CUCFC2·C CUCFC2·CE CUCFS3·C CUCFS3·CE CUCFL2·C CUCFL2·CE CUCFL3·C CUCFL3·CE	C-UCF2·D1 CM-UCF2·D1 C-UCF3·D1 CM-UCF3·D1 C-UCFC2·D1 CM-UCFC2·D1 C-UCFS3·D1 CM-UCFS3·D1 C-UCFL2·D1 CM-UCFL2·D1 C-UCFL3·D1 CM-UCFL3·D1
Adjustable 2-Bolt Flange Units	UCFA2·	UCFA2·	UCFA2·D1
3-Bolt Flange Units	UCFB2·	UCFK2·	UCFH2·D1
Light 2-Bolt Flange Units	BLF2· ALF2·	BLFL·	ASFB2· AELFB2·
Compact 2-Bolt Flange Units	UFL0·	UFL0·	
Corrosion resistant series 4-Bolt Flange Units	UCSF2·H1S6	MUCF2	
Corrosion resistant series 2-Bolt Flange Units	UCSFL2·H1S6	MUCFL2·	
Stamped steel plate Flange	SBPF2· SAPF2· SBPFL2· SAPFL2·	BPF· BPFL·	ASPF2· AELPF2· ASPFL2· AELPFL2·