

FEATURES PICTORIALLY TYPICAL ORIENTATION MAY DIFFER

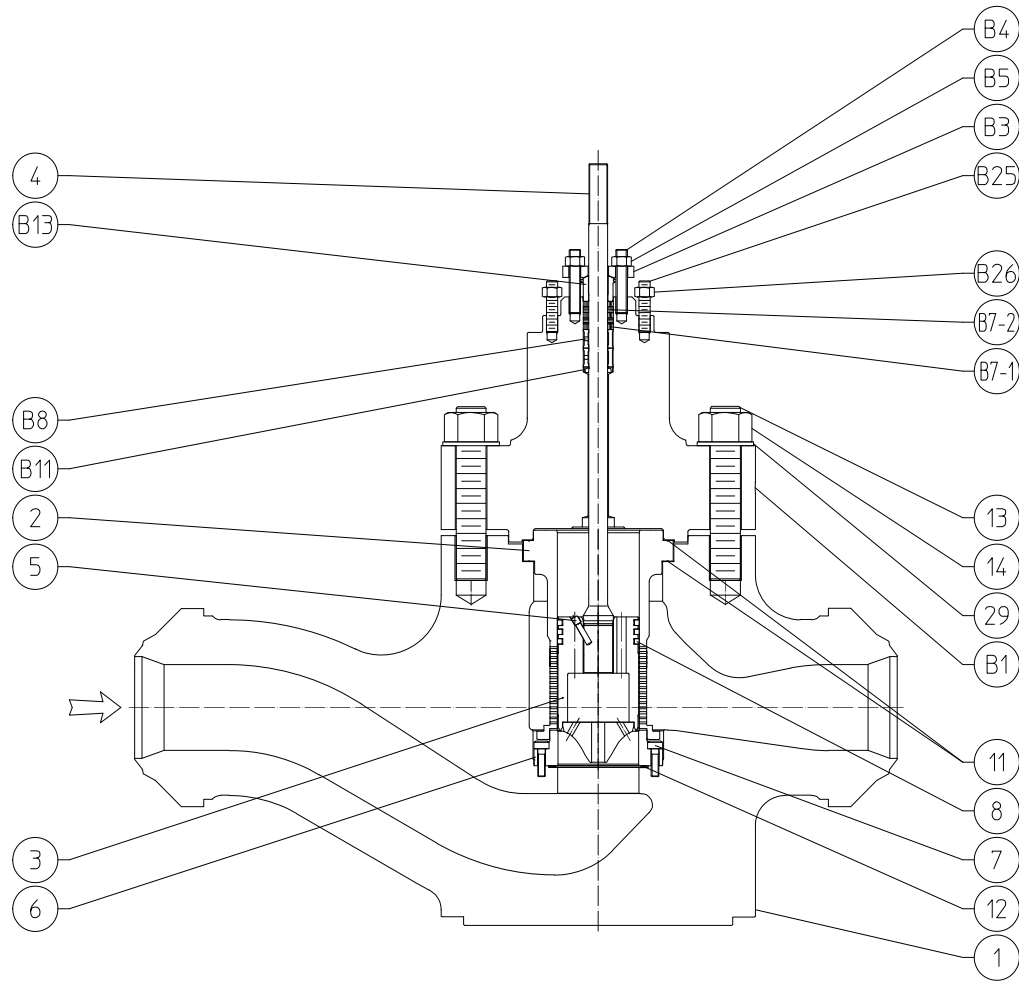

KEY	PART NAME	QTY	MATERIAL	COMMENT
1	BODY	1	ASTM A217M GR WC9	
2	CAGE	1	225 CHROMIUM 1 MOLY 40 YS	
3	PLUG/DIVERTER ASSY	1	ASTM A182M F22/COCR-A	
4	STEM	1	ASTM A565 S42200, COND H	
5	GROOVE PIN	1	ASTM A479M S31600	
6	SEAT RING	1	ASTM A182M F22/COCR-A	
7	SEAT RING CAP SCREW	22	ASTM B637 N07718	
8	PISTON RING	3	CARBON-GRAPHITE	
11	CAGE GASKET	2	S31600/GRAPHITE	
12	SEAT RING GASKET	1	N06600/GRAPHITE	
13	BONNET STUD	12	ASTM A193 B16	
14	BONNET NUT	12	ASTM A194M GR 7	
29	BONNET WASHER	12	AISI G10180	
B1	BONNET	1	ASTM A217M WC9	
B3	PACKING FLANGE	1	ASTM A479M S31600	
B4	PACKING STUD	2	ASTM A193M B8M CL2	
B5	PACKING NUT	2	ASTM A194M 8M	
B7-1	PACKING RING	3	GRAPHITE	
B7-2	PACKING RING	2	GRAPHITE RIBBON/ZN	
B8	LANTERN RING	2	ASTM A479M S31600	
B11	PACKING BOX RING	1	316 SST	
B13	PACKING FOLLOWER	1	316 SST	
B25	YOKE STUD	8	ASME SA193 B7/NCF2	
B26	YOKE NUT	8	ASTM A194 2H/ZN PL	

		<b>FISHER</b> DATE 8/2/18	
CUST: Mitsubishi Hitachi Power Systems, Ltd./Kure		EHD VALVE BODY ASSEMBLY NPS 8	
CUST REF NO.: (XTJB)5:13127328		CL2943 BWE STD BONNET	
FISHER REF NO.: 171873-01		Linear / Whisper III A1	
TAG NO.: 50LBG21AA201		1-1/4 in Stem Graphite Single PACKING	
SERIAL NO.: J229034		FLOW DIRECTION : UP	
CUST ITEM: 10			
		DWN. ADS 6/20/18	ITEM 010
		CHKD. DHI 6/20/18	DWG. NO.
		APVD. TAK 6/20/18	171873-01-010
		SCALE: NONE	REV. 01
Nippon Fisher Co., Ltd. 2018		<b>EMERSON</b>	