

841T/842T

841T/842T Actuator selection chart

841T/842T

Model	Category	Size <small>(mm / inch)</small>				
		350	400	450	500	600
		14	16	18	20	24
2S	Standard	MGH-3			MGH-4	
	Heavy duty	MGH-3			MGH-4	
3A	Standard	TGA-125	TGA-140	TGA-160		TGA-200
	Heavy duty	TGA-140	TGA-160	TGA-180		
3U,3K	Standard	TG-14S		TG-20S		
	Heavy duty	TG-14S		TG-20S		
4 I	ON-OFF	4 I-4				
	Control					
4L	Standard	LTKD-01 0.4kW/MGH-3		LTKD-02 0.75kW/ MGH-3	LTKD-05 0.75kW/ MGH-4	
	Heavy duty	LTKD-01 0.4kW/MGH-3		LTKD-02 0.75kW/ MGH-3	LTKD-05 0.75kW/ MGH-4	

Selection criteria	Standard	Select when none of the following heavy duty items apply.
	Heavy duty	Select when any of the following items apply. ① Powder or high viscosity fluid (crude oil, etc.) ② Control specification (with positioner) ③ Emergency open valve or pipe dead end valve

841T/842T Pressure-temperature rating

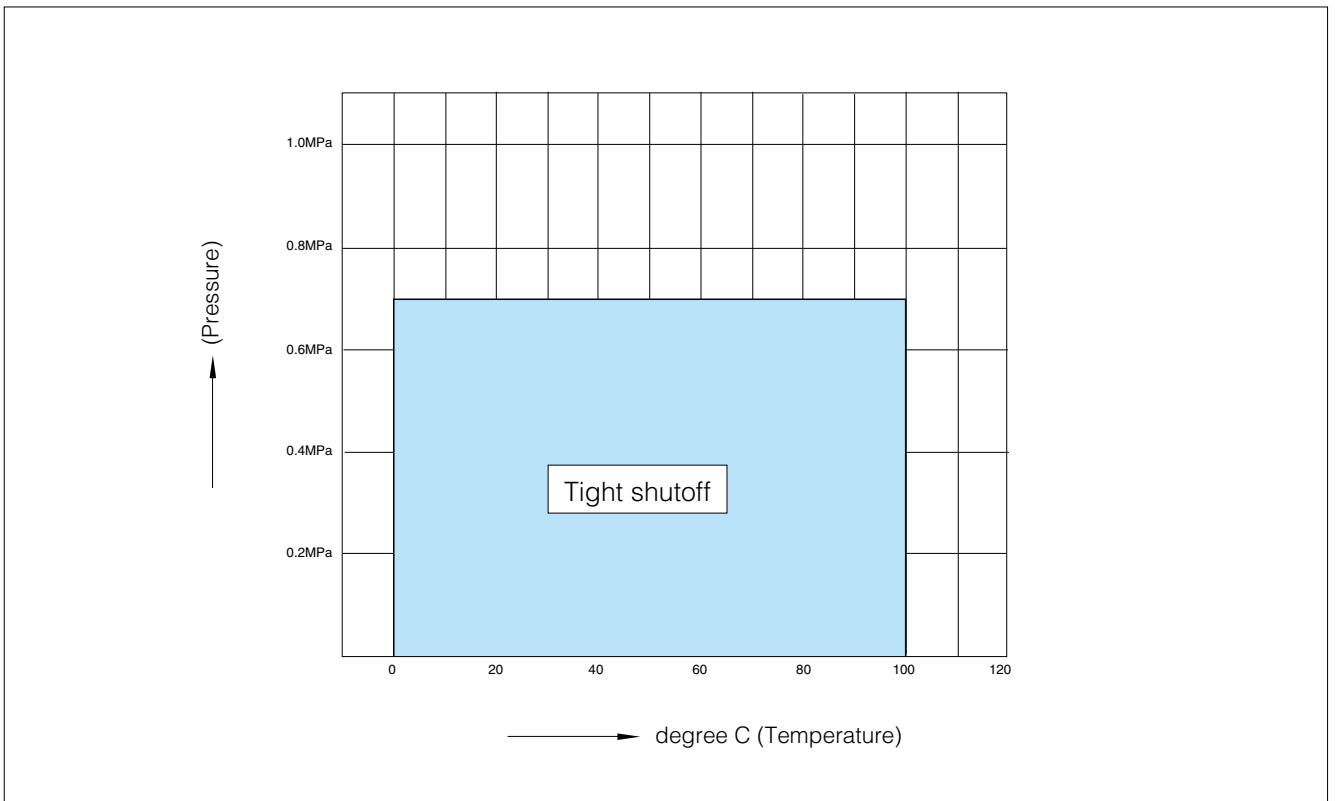

841T/842T

Worm gear type 841T-2S (350mm to 600mm) / 842T-2S (350mm to 600mm)

841T/842T

Nominal size		Dimension (mm)										Gear type	Approx. Mass (kg)
mm	inch	ϕd	ϕD	L	H ₁	H ₂	H ₃	E	K	F	W		
350	14	332	428	100	293	320	55	117	164	325	280	MGH-3	93
400	16	383	491	110	323	360	55	117	164	325	280	MGH-3	113
450	18	435	540	120	367	390	55	117	164	335	355	MGH-3	155
500	20	482	595	140	383	420	55	117	164	335	355	MGH-3	220
600	24	581	700	160	478	490	65	140	198	400	450	MGH-4	320

841T/842T-2S

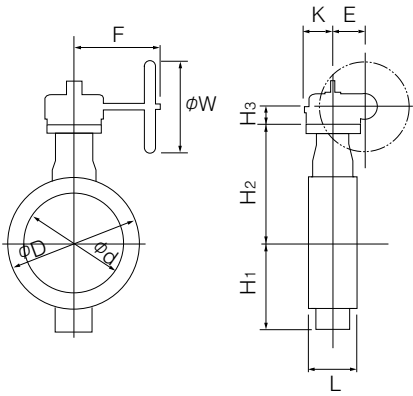

2S Installation direction

2SA (standard)	2SAR	2SB	2SBR