



## IFL 15-30-10/01YG

- 1 Cable entry PG9 x 1.5
- Metal enclosure
- AC 2-wire
- Double-insulated
- Wiring compartment
- Design M30

## Data

### Ordering data

Product type description	IFL 15-30-10/01YG
Article number (order number)	101056906
EAN (European Article Number)	4030661022413
eCl@ss number, version 12.0	27-27-40-01
eCl@ss number, version 11.0	27-27-01-01
eCl@ss number, version 9.0	27-27-01-01
ETIM number, version 7.0	EC002714
ETIM number, version 6.0	EC002714

### Approvals - Standards

Certificates	CCC
--------------	-----

### General data

Standards	DIN VDE 0660-208 EN IEC 60947-5-2
Housing construction form	Cylinder, thread
Installation conditions (mechanical)	not flush

Housing material	Brass
Housing coating material	nickel-plated
Active area	Plastic
Material of the nuts	Brass
Gross weight	151 g

### General data - Features

Integral system diagnostics, status	Yes
Number of cable wires	2

### Mechanical data

Tightening torque of nuts, maximum	30 Nm
------------------------------------	-------

### Mechanical data - Switching distances according EN IEC 60947-5-3

Nominal switching distance $S_n$	15 mm
----------------------------------	-------

### Mechanical data - Connection technique

Termination	Screw connection
Cable section, maximum	1 x 1.5 mm <sup>2</sup>

### Mechanical data - Dimensions

ISO thread of the sensor	M30
width across flats	36 BK
Length of sensor	126 mm

### Ambient conditions

Degree of protection	IP65
Ambient temperature	-25 ... +70 °C
Protection class	II

## Ambient conditions - Insulation values

Rated impulse withstand voltage  $U_{imp}$  4 kV

## Electrical data

Rated supply frequency, minimum 45 Hz  
Rated supply frequency, maximum 65 Hz  
Type of voltage range AC  
Operating current, minimum 10 mA  
Rated operating voltage 15 ... 250 VAC  
Operating current 500 mA  
Switching element NO contact or NC contact  
Protection circuit integrated inductive interference protection  
Switching frequency, approx. 10 Hz

## Electrical data - Digital Output

Voltage drop  $U_d$ , maximum 4.5 V  
Current at Voltage drop  $U_d$  0.2 A  
Design of control elements Two-wire  
Current leakage  $I_r$ , maximum 1 mA

## Status indication

Note (Integral System Diagnostics, status ) yellow LED

## Note

Note (General) Instead of nuts, a mounting clamp can be provided.  
Programmable by repositioning the plug-in jumper at the terminal screws

## Ordering code

Product type description:  
IFL (1)-(2)(3)-(4)(5)(6)(7)-(8)

(1)	
<b>10</b>	Switching distance 10 mm
<b>15</b>	Switching distance 15 mm
(2)	
<b>30</b>	Cylinder, thread M30, metal
<b>300</b>	Cylinder, thread M30, plastic
(3)	
<b>without</b>	Standard body
<b>M</b>	Miniature body
<b>L</b>	Long design
(4)	
<b>01</b>	Opener (NC)
<b>10</b>	Normally open contact (NO)
<b>10/01</b>	NO contact / NC contact with wiring compartment
<b>11</b>	1 NO contact / 1 NC contact antivalent
(5)	
<b>without</b>	Cable
<b>ST</b>	Male connector
<b>T</b>	Conductor with strain relief
<b>D</b>	DC 2-wire
(6)	
<b>without</b>	Standard connector version
<b>2</b>	Alternative connector version
(7)	
<b>N</b>	n-type
<b>P</b>	p-type

(8)

<b>1310</b>	Can be used up to +110 C (for alternating current (AC) only)
<b>2130</b>	Can be used up to +130 C, without LED switching conditions display
<b>1766</b>	Can be used up to +110 C (for p-type or n-type only)

## Pictures

### Product picture (catalogue individual photo)



ID: kifl1f19

| 689.0 kB | .jpg | 352.778 x 529.167 mm - 1000 x 1500 px - 72 dpi

| 64.5 kB | .png | 74.083 x 111.125 mm - 210 x 315 px - 72 dpi

| 45.4 kB | .jpg | 82.197 x 123.472 mm - 233 x 350 px - 72 dpi

### Dimensional drawing basic component

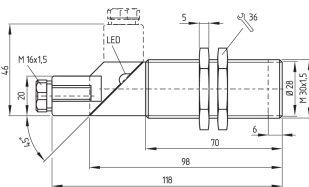

ID: lifl1g10

| 26.7 kB | .cdr |

| 7.9 kB | .png | 74.083 x 51.153 mm - 210 x 145 px - 72 dpi

| 105.8 kB | .jpg | 352.778 x 243.769 mm - 1000 x 691 px - 72 dpi

### Diagram

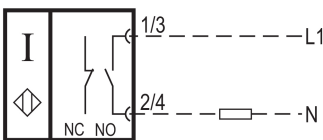

ID: ia2ak06

| 30.9 kB | .cdr |

| 45.9 kB | .jpg | 352.778 x 148.167 mm - 1000 x 420 px - 72 dpi

| 2.4 kB | .png | 74.083 x 31.044 mm - 210 x 88 px - 72 dpi

### Operating principle



ID: sifl1dd01

| 53.6 kB | .ai | 297 x 210.002 mm - 841 x 595 px - 72 dpi

| 50.1 kB | .jpg | 352.778 x 149.578 mm - 1000 x 424 px - 72 dpi

| 1.4 kB | .png | 74.083 x 31.397 mm - 210 x 89 px - 72 dpi

The details and data referred to have been carefully checked. Images may diverge from original. Further technical data can be found in the manual. Technical amendments and errors possible.

Generated on: 04/07/2024, 06:57