

FAG

16006-A

Deep groove ball bearing

Schaeffler ID:
0604615000000Deep groove ball bearing 160..-A, single
row, steel sheet metal cage

Technical information

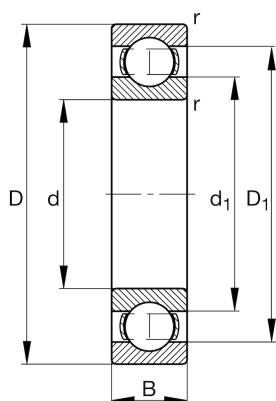
**Main Dimensions & Performance Data**

d	30 mm	Bore diameter
D	55 mm	Outside diameter
B	9 mm	Width
C_r	11,220 N	Basic dynamic load rating, radial
C_{0r}	7,390 N	Basic static load rating, radial
C_{ur}	300 N	Fatigue load limit, radial
n_G	15,700 1/min	Limiting speed
n_{gr}	10,000 1/min	Reference speed
	0.081 kg	Weight

Dimensions

r_{min}	0.3 mm	Minimum chamfer dimension
D_1	47.9 mm	Shoulder diameter outer ring
d_1	39.2 mm	Shoulder diameter inner ring

Mounting dimensions

$d_{a min}$	32 mm	Minimum diameter shaft shoulder
$D_{a max}$	53 mm	Maximum diameter of housing shoulder
$r_{a max}$	0.3 mm	Maximum fillet radius

Calculation factors

f_0	15.3	Calculation factor
-------	------	--------------------

Temperature range

T_{min}	-30 °C	Operating temperature min.
T_{max}	120 °C	Operating temperature max.