

W.I.C.C. Ltd  
 119 MULLER RD  
 PO Box 252  
 WASHINGTON IL 61571  
 (309)-444-4125  
 FAX (309)-444-3313

# CURRENT TRANSFORMER MODEL C

2.88" I.D.

PAGE No 1-8

REV 14DEC00

## TERMINAL OPTION

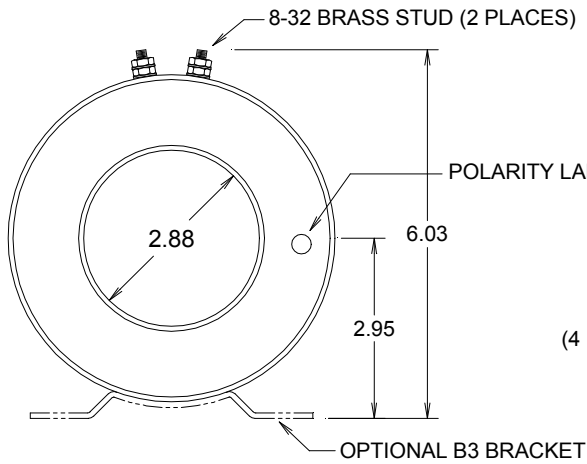
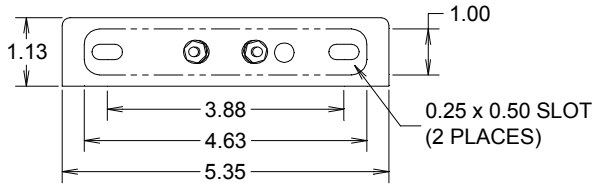

## LEAD WIRE OPTION

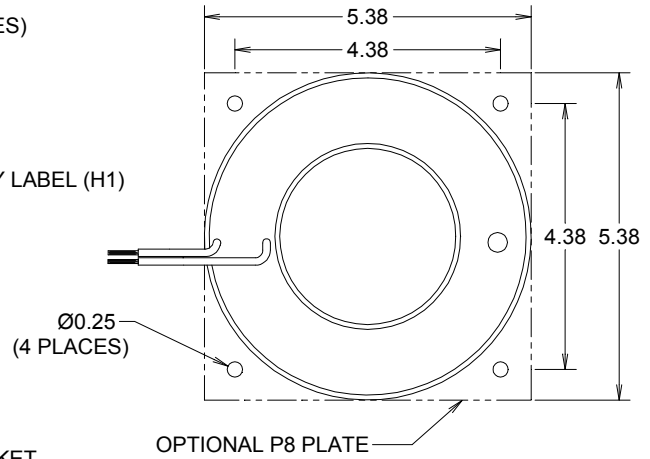
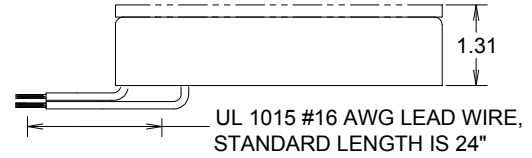

- NOTES  
 1). ALL DIMENSIONS IN INCHES  
 2). ALL DIMENSIONS REF ONLY

## Specifications

- Secondary sources 5 amps AC at rated F.S. primary current
- Nominal operating frequency range is 50-400HZ
- Thermal rating factor is 1.33 @ 30C for ratios up to 1600:5A, 1.15 @ 30C for ratios above 1600:5A
- Insulation voltage class is 0.6KV BIL 10KV
- For indoor applications only
- Reference documents IEEE C57.13, UL1244, and IEC 44-1
- Enclosure is glass-filled nylon, color is black
- Optional plate is XX phenolic, optional bracket is aluminum

## Options, contact Factory for information

- UL and Canadian UL Recognized Component. File E100575
- 2.0, 5.0, and 10 VAC output at F.S. primary amperage. Other non-standard ratings also available.
- 1, 0.2, and 0.1 A output at F.S. primary amperage. Other non-standard ratings also available
- 8-32 Brass Stud Terminals or #16 AWG UL 1015 Lead Wires
- Custom lead wire lengths and types
- Thermal ratings above 1.33 for selected ratios.
- Available with B1 and B31 brackets. See Bracket Data Section for dimensions.
- Available with B54 bracket when ratio is above 500:5A. See Bracket Data Section for dimensions.
- Center tap and custom multi tap winding arrangements

2.88" I.D.

CURRENT TRANSFORMER  
**MODEL C**

PAGE No 1-9

REV 14DEC00

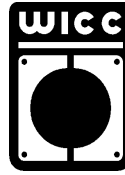

W.I.C.C. Ltd  
 119 MULLER RD  
 PO Box 252  
 WASHINGTON IL 61571  
 (309)-444-4125  
 FAX (309)-444-3313

TYPICAL EXCITATION CURVE for WICC MODEL C at 60HZ

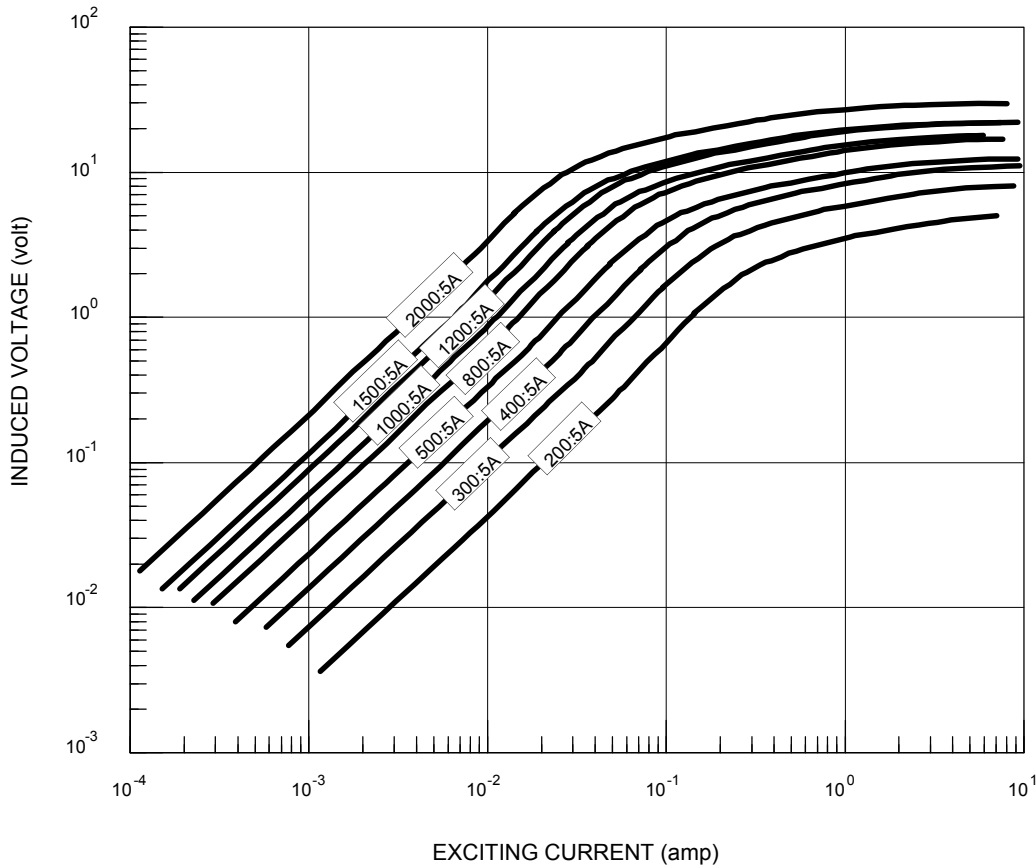

W.I.C.C. PART NUMBER *	RATIO	ACCURACY @ 60HZ, pf = 0.95		NOMINAL WINDING RESISTANCE (ohm)
		± %	BURDEN (VA)	
C-200-00-xxx	200:5A	1.5	2.0	0.06
C-250-00-xxx	250:5A	1.0	2.0	0.08
C-300-00-xxx	300:5A	1.0	3.0	0.09
C-400-00-xxx	400:5A	1.0	7.0	0.12
C-500-00-xxx	500:5A	1.0	10	0.14
C-600-00-xxx	600:5A	1.0	12	0.15
C-800-00-xxx	800:5A	1.0	20	0.20
C-1000-00-xxx	1000:5A	1.0	25	0.25
C-1200-00-xxx	1200:5A	1.0	30	0.30
C-1500-00-xxx	1500:5A	1.0	35	0.40
C-1600-00-xxx	1600:5A	1.0	30	0.43
C-1800-00-xxx	1800:5A	1.0	30	0.50
C-2000-00-xxx	2000:5A	1.0	35	0.60

\* "xxx" describes termination: "T" FOR BRASS STUDS, "Lyyy" FOR LEAD WIRES (Where "yyy" is the lead length in inches. For example, "L24" represents 24 inch long lead wires.)

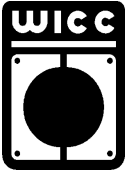

W.I.C.C. Ltd  
 119 MULLER RD  
 PO Box 252  
 WASHINGTON IL 61571  
 (309)-444-4125  
 FAX (309)-444-3313

# CURRENT TRANSFORMER MODEL CX

2.88" I.D.

PAGE No 1-10

REV 14DEC00

## TERMINAL OPTION

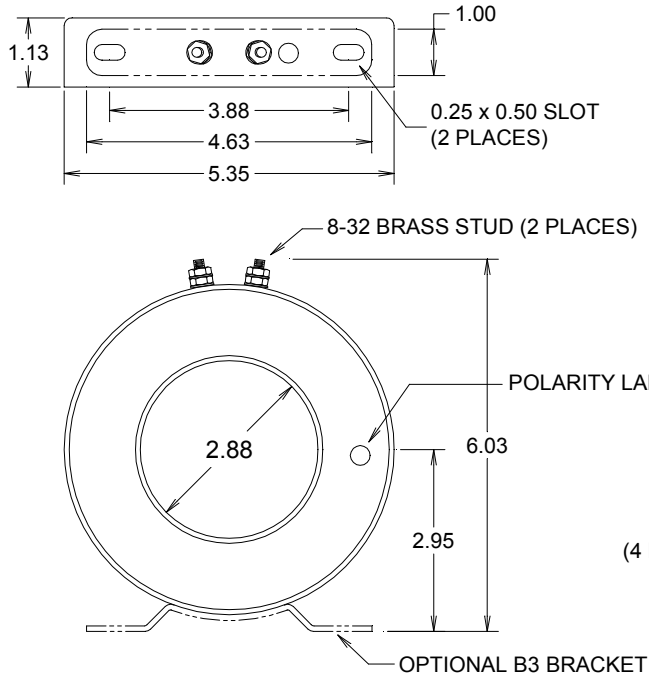

## LEAD WIRE OPTION

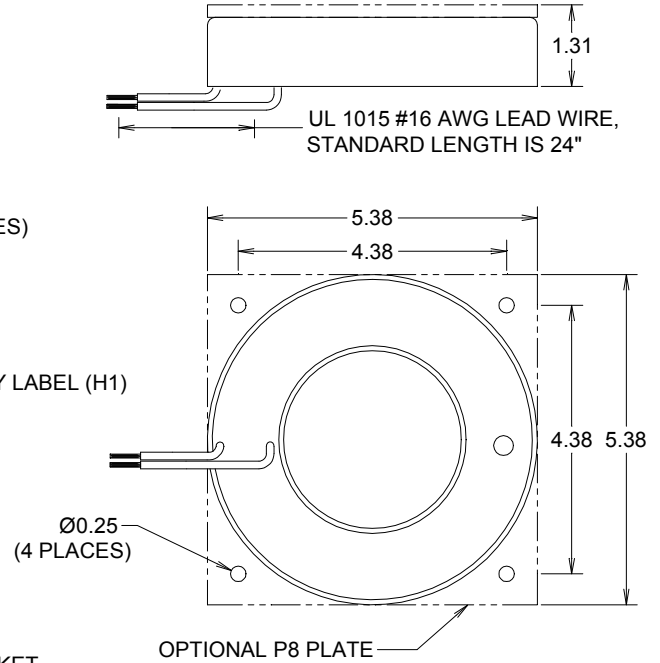

### NOTES

- 1). ALL DIMENSIONS IN INCHES
- 2). ALL DIMENSIONS REF ONLY

## Specifications

- Secondary sources 5 amps AC at rated F.S. primary current
- Nominal operating frequency range is 50-400HZ
- Thermal rating factor is 1.33 @ 30C for all ratios
- Insulation voltage class is 0.6KV BIL 10KV
- For indoor applications only
- Reference documents IEEE C57.13, UL1244, and IEC 44-1
- Enclosure is glass-filled nylon, color is black
- Optional plate is XX phenolic, optional bracket is aluminum

## Options, contact Factory for information

- UL and Canadian UL Recognized Component. File E100575
- 2.0, 5.0, and 10 VAC output at F.S. primary amperage. Other non-standard ratings also available.
- 1, 0.2, and 0.1 A output at F.S. primary amperage. Other non-standard ratings also available
- 8-32 Brass Stud Terminals or #16 AWG UL 1015 Lead Wires
- Custom lead wire lengths and types
- Thermal ratings above 1.33 for selected ratios.
- Available with B1 and B31 brackets. See Bracket Data Section for dimensions.
- Available with B54 bracket when ratio is above 500:5A. See Bracket Data Section for dimensions.
- Center tap and custom multi tap winding arrangements

2.88" I.D.

# CURRENT TRANSFORMER MODEL CX

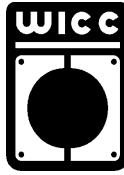

W.I.C.C. Ltd  
119 MULLER RD  
PO Box 252  
WASHINGTON IL 61571  
(309)-444-4125  
FAX (309)-444-3313

PAGE No 1-11

REV 14DEC00

TYPICAL EXCITATION CURVE for WICC MODEL CX at 60HZ

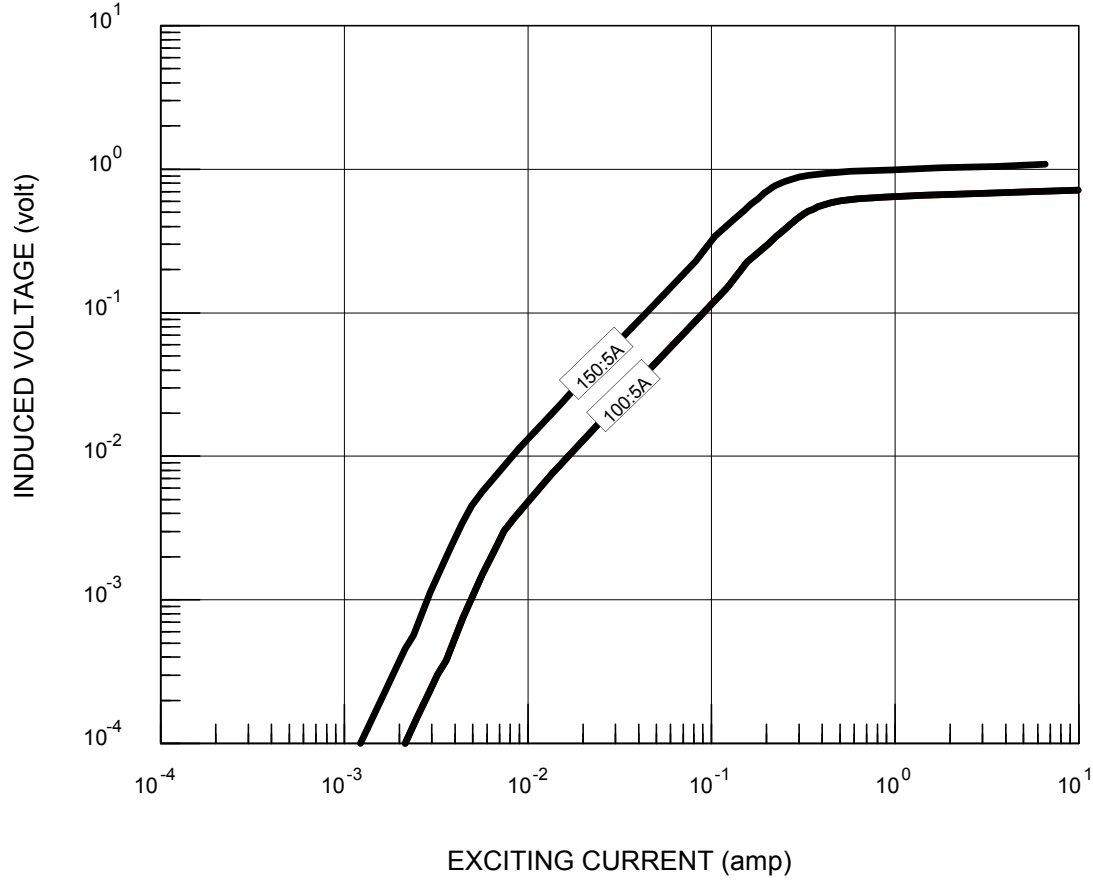

W.I.C.C. PART NUMBER *	RATIO	ACCURACY @ 60HZ, pf = 0.95		NOMINAL WINDING RESISTANCE (ohm)
		± %	BURDEN (VA)	
CX-100-00-xxx	100:5A	5.0	2.0	0.01
CX-150-00-xxx	150:5A	2.5	2.0	0.02

\* "xxx" describes termination: "T" FOR BRASS STUDS, "Lyyy" FOR LEAD WIRES (Where "yyy" is the lead length in inches. For example, "L24" represents 24 inch long lead wires.)