

CLASS 150 BRONZE GATE VALVE

Screwed bonnet, Non-rising stem,
Threaded ends to BS21 (JIS B0203) or NPT

W.O.G. non-shock 2.07 MPa (300 psi), Saturated steam pressure 1.03 MPa (150 psi)

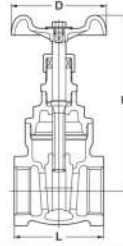

Fig. E

- Threaded end to BS21 (JIS B0203)

Fig. AKE

- Threaded end to ASME B1.20.1



Materials

| Parts | Material |
|---------------|---------------------------------|
| Body | Bronze |
| Bonnet | Brass/Bronze* |
| Stem | Dezincification Resistant Brass |
| Disc | Bronze |
| Gland packing | Aramid Fibers Graphite |

*Size 2 1/2 & 3

⚠ Do not use for flammable gas or toxic gas.

Dimensions

| Nominal Size | mm | | | | | | | | | |
|--------------|------|-----|-----|-----|-----|-------|-------|-----|-------|-----|
| | inch | 3/8 | 1/2 | 3/4 | 1 | 1 1/4 | 1 1/2 | 2 | 2 1/2 | 3 |
| L | 43 | 48 | 53 | 62 | 69 | 75 | 86 | 105 | 116 | 116 |
| H | 86 | 96 | 111 | 122 | 141 | 164 | 197 | 225 | 261 | 261 |
| D | 50 | 55 | 60 | 70 | 80 | 90 | 100 | 115 | 135 | 135 |

CLASS 150 BRONZE GATE VALVE

Screwed bonnet, Non-rising stem,
Flanged ends drilled or undrilled optionally

W.O.G. non-shock 2.07 MPa (300 psi), Saturated steam pressure 1.03 MPa (150 psi)

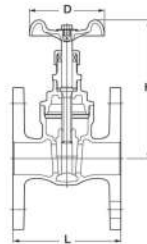

Fig. EB

- Undrilled unless drilling is specified as an option

Fig. EBH

- Drilled according to JIS 10K



Materials

| Parts | Material |
|---------------|---------------------------------|
| Body | Bronze |
| Bonnet | Brass/Bronze* |
| Stem | Dezincification Resistant Brass |
| Disc | Bronze |
| Gland packing | Aramid Fibers Graphite |

*Size 2 1/2 & larger

⚠ Do not use for flammable gas or toxic gas.

Dimensions

| Nominal Size | mm | | | | | | | | | | | |
|--------------|------|-----|-----|-----|-------|-------|-----|-------|-----|-----|-----|-----|
| | inch | 1/2 | 3/4 | 1 | 1 1/4 | 1 1/2 | 2 | 2 1/2 | 3 | 4 | 5 | 6 |
| L | 75 | 80 | 95 | 110 | 120 | 140 | 165 | 190 | 230 | 190 | 210 | 210 |
| H | 96 | 111 | 122 | 142 | 165 | 197 | 225 | 264 | 309 | 381 | 427 | 427 |
| D | 55 | 60 | 70 | 80 | 90 | 100 | 115 | 155 | 225 | 225 | 250 | 250 |

*Shall not be in accordance with JIS B 2240

CLASS 150 BRONZE LIFT CHECK VALVE

Screwed cap, Lift type disc
Threaded ends to BS21 (JIS B0203) or NPT

W.O.G. non-shock 2.07 MPa (300 psi), Saturated steam pressure 1.03 MPa (150 psi)

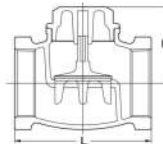

Fig. F

- Threaded end to BS21 (JIS B0203)

Fig. AKF

- Threaded end to ASME B1.20.1



Materials

| Parts | Material |
|-------|---------------|
| Body | Bronze |
| Cap | Brass/Bronze* |
| Disc | Bronze |

*Size 2 1/2 & 3

⚠ Do not use for flammable gas or toxic gas.

Dimensions

| Nominal Size | mm | | | | | | | | | |
|--------------|------|-----|-----|-----|----|-------|-------|-----|-------|-----|
| | inch | 3/8 | 1/2 | 3/4 | 1 | 1 1/4 | 1 1/2 | 2 | 2 1/2 | 3 |
| L | 44 | 53 | 65 | 77 | 85 | 100 | 119 | 139 | 158 | 158 |
| H | 26 | 28 | 34 | 42 | 50 | 56 | 67 | 79 | 91 | 91 |

CLASS 125 BRONZE SWING CHECK VALVE

Screwed cap, Swing type disc,
Threaded ends to BS21 (JIS B0203) or NPT,
or solder joint ends

W.O.G. non-shock 1.38 MPa (200 psi), Saturated steam pressure 0.86 MPa (125 psi)



Fig. R

- Threaded end to BS21 (JIS B0203)

Fig. AKR

- Threaded end to ASME B1.20.1



Fig. CR

- Solder joint ends to JIS B2011 / ASME B16.18 (2 1/2 & 3)

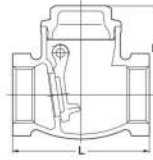

Materials

| Parts | Material |
|-----------|---------------|
| Body | Bronze |
| Cap | Brass/Bronze* |
| Hinge pin | Brass |
| Disc | Brass/Bronze* |

*Size 4 only

⚠ Solder joint end valves should not be used in service where the temperature of the line fluid is higher than the softening point of the solder.

⚠ Do not use for flammable gas or toxic gas.

Dimensions

| Nominal Size | inch | 3/8 | 1/2 | 3/4 | 1 | 1 1/4 | 1 1/2 | 2 | 2 1/2 | 3 | 4 | mm |
|--------------|------|-----|-----|-----|----|-------|-------|-----|-------|-----|-----|----|
| L | mm | 10 | 15 | 20 | 25 | 32 | 40 | 50 | 65 | 80 | 100 | |
| L1 Solder | | 53 | 60 | 70 | 80 | 92 | 102 | 122 | 150 | 165 | 195 | |
| H | | 39 | 39 | 45 | 52 | 62 | 67 | 79 | 91 | 102 | 119 | |

CLASS 125 BRONZE Y-PATTERN SWING CHECK VALVE

Screwed cap, Swing type disc,
Threaded ends to BS21 (JIS B0203)

W.O.G. non-shock 1.38 MPa (200 psi), Saturated steam pressure 0.86 MPa (125 psi)



Fig. YR

- Threaded end to BS21 (JIS B0203)

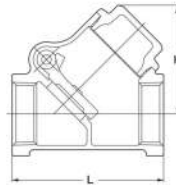

Materials

| Parts | Material |
|-----------|----------|
| Body | Bronze |
| Cap | Brass |
| Hinge pin | Copper |
| Disc | Bronze |

⚠ Do not use for flammable gas or toxic gas.

Dimensions

| Nominal Size | inch | 3/8 | 1/2 | 3/4 | 1 | 1 1/4 | 1 1/2 | 2 | mm |
|--------------|------|-----|-----|-----|----|-------|-------|-----|----|
| L | mm | 10 | 15 | 20 | 25 | 32 | 40 | 50 | |
| H | | 54 | 56 | 70 | 80 | 95 | 110 | 128 | |
| | | 40 | 40 | 49 | 58 | 71 | 80 | 95 | |

CLASS 150 BRONZE LIFT CHECK VALVE

Screwed cap, Lift type disc,
Threaded ends to BS21 (JIS B0203) or NPT,
or solder joint ends

W.O.G. non-shock 1.72 MPa (250 psi)



Fig. RF

- Threaded end to BS21 (JIS B0203)
- NBR Disc

Fig. AKAF

- Threaded end to ASME B1.20.1
- FKM Disc



Fig. CAF

- Solder joint ends to ASME B16.18
- FKM Disc

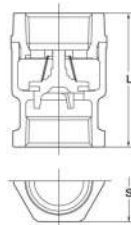

Materials

| Parts | Material |
|-------|----------|
| Body | Bronze |
| Cap | Bronze |
| Disc | NBR/FKM* |

*AKAF & CAF

⚠ Solder joint end valves should not be used in service where the temperature of the line fluid is higher than the softening point of the solder.

⚠ Do not use for flammable gas or toxic gas.

Dimensions

| Nominal Size | inch | 1/2 | 3/4 | 1 | 1 1/4 | 1 1/2 | 2 | mm |
|--------------|------|-----|-----|----|-------|-------|----|----|
| L | mm | 15 | 20 | 25 | 32 | 40 | 50 | |
| L1 Solder | | 53 | 59 | 67 | 78 | 84 | 98 | |
| S (AKAF) | | 26 | 32 | 39 | 48 | 54 | 67 | |
| S (RF) | | 28 | 34 | 41 | 50 | 57 | 70 | |

5K

BRONZE LIFT CHECK VALVE

Screwed cap, Lift type disc,
Threaded ends to BS21 (JIS B0203)

W.O.G. non-shock 120°C (0.5 MPa)



Fig. VF

• Threaded end to BS21 (JIS B0203)

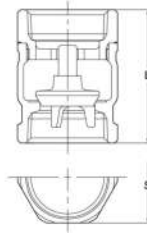

Materials

| Parts | Material |
|-------|---|
| Body | Bronze |
| Cap | Brass (Size 1/2 & 3/4) Bronze (Size 1 to 2) |
| Disc | Dezincification Resistant Brass (Size 1/2 & 3/4) Bronze (Size 1 to 2) |

⚠ Do not use for flammable gas or toxic gas.

Dimensions

| Nominal Size | inch | 1/2 | 3/4 | 1 | 1 1/4 | 1 1/2 | 2 | mm |
|--------------|------|-----|-----|----|-------|-------|----|----|
| | mm | 15 | 20 | 25 | 32 | 40 | 50 | |
| L | | 37 | 44 | 51 | 62 | 69 | 82 | |
| S | | 24 | 30 | 36 | 45 | 52 | 63 | |

5K

BRONZE LIFT CHECK VALVE

Screwed cap, Lift type disc,
Threaded ends to BS21 (JIS B0203) and parallel

Water 80°C (0.5 MPa)



Fig. FT

• Threaded end to BS21 (JIS B0203)
and parallel



Fig. FTS

(Screen)
Threaded end to parallel

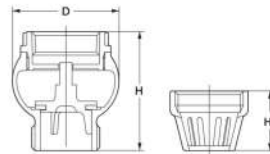

Materials

| Parts | Material |
|-------|----------|
| Body | Bronze |
| Cap | Bronze |
| Disc | NBR |

⚠ Do not use for flammable gas or toxic gas.

Dimensions

| Nominal Size | inch | 3/4 | 1 | 1 1/4 | 1 1/2 | 2 | 2 1/2 | 3 | mm |
|--------------|------|-----|----|-------|-------|----|-------|-----|----|
| | mm | 20 | 25 | 32 | 40 | 50 | 65 | 80 | |
| H | | 48 | 58 | 62 | 70 | 80 | 90 | 100 | |
| D | | 41 | 52 | 62 | 70 | 83 | 102 | 116 | |
| H1 | | 25 | 29 | 32 | 35 | 43 | 50 | 51 | |

CLASS 150

Y-PATTERN STRAINER

Y-pattern body, Screwed cap, 304 stainless steel screen,
Threaded ends to BS21 (JIS B0203) or NPT,
or solder joint ends

W.O.G. non-shock 2.07 MPa (300 psi), Saturated steam pressure 1.03 MPa (150 psi) up to size 2*

*Contact KITZ for larger sizes



Fig. Y

• Threaded end to BS21 (JIS B0203)



Fig. CY

• Solder joint ends
to JIS B2011 /
ASME B16.18 (2 1/2 & 3)

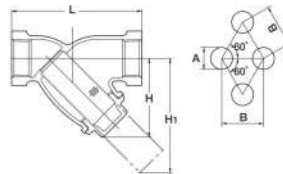

Materials

| Parts | Material |
|----------|-------------------------|
| Body | Bronze |
| Body cap | Brass |
| Screen | Type304 Stainless Steel |

| | A | B |
|------------|-----|-----|
| 3/8 to 2 | 1.4 | 2.4 |
| 2 1/2 to 3 | 1.5 | 2.5 |

⚠ Solder joint end valves should not be used in service where the temperature of the line fluid is higher than the softening point of the solder.

⚠ Do not use for flammable gas or toxic gas.

Dimensions

| Nominal Size | inch | 3/8 | 1/2 | 3/4 | 1 | 1 1/4 | 1 1/2 | 2 | 2 1/2 | 3 | mm |
|--------------|------|-----|-----|-----|-----|-------|-------|-----|-------|-----|----|
| | mm | 10 | 15 | 20 | 25 | 32 | 40 | 50 | 65 | 80 | |
| L | | 70 | 80 | 100 | 115 | 135 | 160 | 195 | 230 | 240 | |
| L1 Solder | | | 80 | 105 | 125 | 145 | 170 | 210 | 250 | 280 | |
| H | | 44 | 49 | 57 | 70 | 82 | 98 | 121 | 148 | 180 | |
| H1 | | 61 | 68 | 83 | 105 | 124 | 149 | 188 | 216 | 267 | |

Fig. AKY

• Threaded end to ASME B1.20.1