

VELAN FORGED STEEL INCLINED PISTON CHECK VALVES

FOR HORIZONTAL AND VERTICAL LINES

NPS ¼–4 (DN 8–100), THREADED, SOCKET WELD OR BUTT WELD
ASME CLASSES 1690, 2680, 4500

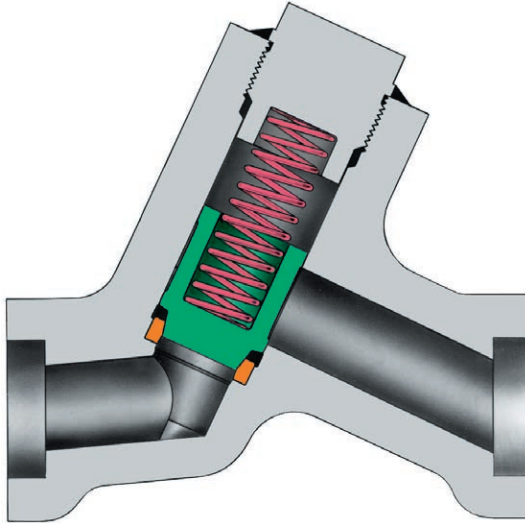

PART	STANDARD MATERIALS			
Body	A105	A182 Gr. F22	A182 Gr. F316	A 182 Gr. F91
Cover	A105	A182 Gr. F22	A182 Gr. F316	A 182 Gr. F91
Disc	CoCr alloy			
Seat, integral	CoCr alloy			
Spring ⁽¹⁾	Gr. 302 (stainless)	Inconel X750	Gr. 302 (stainless)	Inconel X750

DESIGN FEATURES

- Complies to ASME B16.34 standards.
- Solid CoCr alloy disc, fully guided for fast and full seating, even without spring.
- High Cv.
- Self-draining waterways.

For other materials, trims, and engineering data, see pages 23–35.

CLASS	1690	2680	4500
Figure number	8036W	9036W	5036W

DIMENSIONS, WEIGHTS AND CV

Size NPS DN	Port opening		End-to-end		Center-to-top		Socket weld bore	Socket weld depth	Approximate weight lb/kg		C _v Flow coefficient	
	1690 & 2680	4500	1690 & 2680	4500	1690 & 2680	4500			1690 & 2680	4500	1690 & 2680	4500
¼	0.559	–	4.88	–	3.61	–	0.555	0.38	6.5	–	1.0	–
8	14.2	–	124	–	92	–	14.1	9.5	3.0	–	–	–
¾	0.559	0.375	4.88	5.75	3.61	4.26	0.690	0.38	6.3	5	1.8	1.5
10	14.2	9.5	124	146	92	108	17.5	9.5	2.9	2.3	–	–
½	0.559	0.559	4.88	7.00	3.61	5.5	0.855	0.38	6.1	25	2.1	2.1
15	14.2	14.2	124	178	92	140	21.7	9.5	3	11	–	–
¾	0.559	0.559	4.88	7.00	3.61	5.5	1.065	0.50	5.7	25	4.3	4.3
20	14.2	14.2	124	178	92	140	27.1	12.7	2.6	11	–	–
1	0.833	0.559	5.75	7.00	4.88	5.5	1.330	0.50	10.5	25	8.4	4.3
25	21.2	14.2	146	178	124	140	33.8	12.7	4.8	11	–	–
1¼	1.125	–	7.25	–	5.88	–	1.675	0.50	18.5	–	17	–
32	28.6	–	184	–	150	–	42.5	12.7	8.4	–	–	–
1½	1.125	1.125	7.25	10.13	5.88	6.88	1.915	0.50	18.5	42	19	18
40	28.6	28.6	184	257	150	175	48.6	12.7	8.4	19	–	–
2	1.688	1.50	10.13	12.00	7.19	8.44	2.406	0.63	37	87	45	36
50	42.9	38.1	257	305	183	214	61.1	15.9	16.8	40	–	–
2½ ⁽¹⁾	1.688	1.50	12.00	12.00	8.06	8.44	2.906	0.63	94	87	45	36
65	42.9	38.1	305	305	205	214	73.8	15.9	43	40	–	–
3 ⁽¹⁾	1.688	1.50	12.00	12.00	8.06	8.44	(2)	(2)	94	110 ⁽³⁾	45	36
80	42.9	38.1	305	305	205	214	(2)	(2)	43	50	–	–
4	1.688	1.50	12.00	12.00	8.06	8.44	(2)	(2)	94	110 ⁽³⁾	45	36
100	42.9	38.1	305	305	205	214	(2)	(2)	43	50	–	–

(1) For Classes 1690 and 2680, dimensions are as shown, or same as for NPS 2 (DN 50) valve, depending on end connection.

(2) Butt weld or flanged connection only in these sizes.

(3) For butt weld weight is 87 lbs. (40 kg).