

Tube Support Systems

Cushioned Clamp Tube Supports

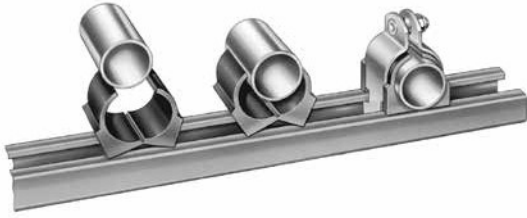

- Provide channel-mounted tube support
- Dampen shock and vibration
- Resist galvanic corrosion.

Technical Data

Component	Material	Temperature Rating
Clamp	Electro-dichromate-finished carbon steel or 316 stainless steel	-50 to 275°F (-45 to 135°C)
Cushion	Thermoplastic polypropylene-based elastomer	

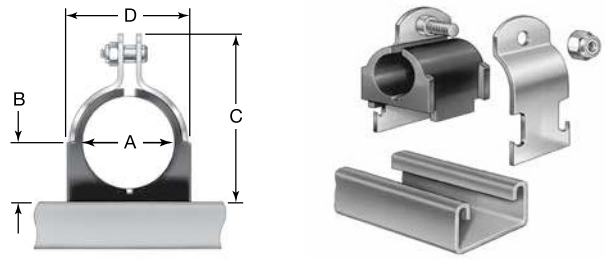

Ordering Information and Dimensions

Dimensions are for reference only and are subject to change.

A, Tube Size		Basic Ordering Number	Dimensions, in. (mm)		
in.	mm		B	C	D
1/4	—	TBC4	0.27 (6.9)	0.98 (24.9)	0.62 (15.7)
3/8	10	TBC6	0.33 (8.4)	1.13 (28.7)	0.82 (20.8)
1/2	—	TBC8	0.40 (10.2)	1.34 (34.0)	0.94 (23.9)
3/4	20	TBC12	0.52 (13.2)	1.68 (42.7)	1.20 (30.5)
1	25	TBC16	0.65 (16.5)	1.95 (49.5)	1.44 (36.6)

Contact your authorized Swagelok representative for additional sizes.
Clamp fits any 1 5/8 in. mounting channel.

To order, select a basic ordering number and add a clamp material designator.

Example: **S**-TBC4

Clamp Material	Designator
Electro-dichromate-finished carbon steel	S-
316 stainless steel	SS-

Tube Support Systems

P Clamp Supports

- Are an economical way to support tube or hose runs in a variety of sizes
- Install easily to a wall or equipment frame using a single screw or bolt.



Technical Data

Component	Material	Temperature Rating
Clamp	316 SS/AMS 5524	-40 to 212°F (-40 to 100°C)
Cushion	Black EPDM/ SAE J200BC715 C12, C20	

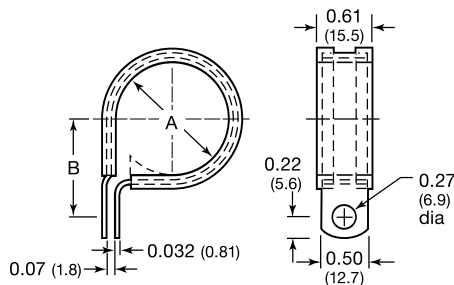

Ordering Information and Dimensions

Dimensions, in inches (millimeters), are for reference only and are subject to change.

A, Tube Size		Ordering Number	B in. (mm)
in.	mm		
1/4	6	SS-TBP4	0.52 (13.2)
3/8	10	SS-TBP6	0.59 (15.0)
1/2	12	SS-TBP8	0.65 (16.5)
3/4	20	SS-TBP12	0.84 (21.3)
1	25	SS-TBP16	0.95 (24.1)

Contact your authorized Swagelok representative for additional sizes.