

## PN16

## BRASS GATE VALVE

Screwed-in Bonnet, Non-rising Stem  
Threaded ends to BS21 (JIS B0203)

16 bar at 100°C, 7 bar at 170°C, P-T rating : See page 01



Fig. PN16FH

• Threaded ends to BS21(JIS B0203)

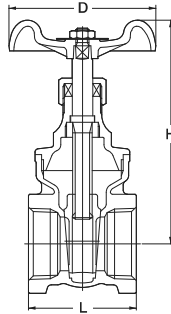

### Materials

Parts	Material
Body	Brass
Bonnet	Brass
Stem	Dezincification Resistant Brass
Disc	Brass
Gland Packing	Aramid Fibers Graphite

### Dimensions

Nominal Size	mm						
	NPS DN	1/2 15	3/4 20	1 25	1 1/4 32	1 1/2 40	2 50
L Threaded end to end		42	47	50	60	63	72
H Height		73	87	97	118	126	154
D Handwheel diameter		50	55	60	70	80	90

## PN16

## BRONZE GATE VALVE

Screwed-in Bonnet, Non-rising Stem  
Threaded ends to BS21(JIS B0203)

16 bar at 100°C, 7 bar at 170°C, P-T rating : See page 01

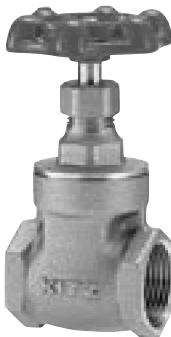
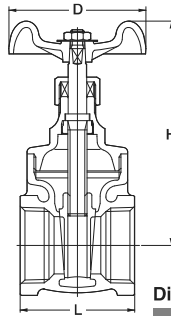

Fig. PN16S

• Threaded ends to BS21(JIS B0203)



### Materials

Parts	Material
Body	Bronze
Bonnet	Brass
Stem	Dezincification Resistant Brass
Disc	Brass
Gland Packing	Aramid Fibers Graphite

### Dimensions

Nominal Size	mm						
	NPS DN	1/2 15	3/4 20	1 25	1 1/4 32	1 1/2 40	2 50
L Threaded end to end		42	47	50	60	63	72
H Height		75	86	97	117	126	154
D Handwheel diameter		50	55	60	70	80	90

## PN20

## BRONZE GATE VALVE

Screwed-in Bonnet, Non-rising Stem  
Threaded ends to BS21(JIS B0203)

20 bar at 100°C, 9 bar at 180°C, P-T rating : See page 01



Fig. PN20E

• Threaded ends to BS21(JIS B0203)

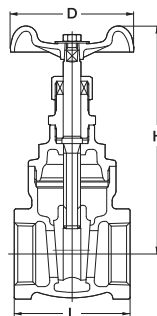

### Materials

Parts	Material
Body	Bronze
Bonnet	Brass
Stem	Dezincification Resistant Brass
Disc	Bronze
Gland Packing	Aramid Fibers Graphite

### Dimensions

Nominal Size	mm						
	NPS DN	1/2 15	3/4 20	1 25	1 1/4 32	1 1/2 40	2 50
L Threaded end to end		48	53	62	69	75	86
H Height		96	111	122	141	164	197
D Handwheel diameter		55	60	70	80	90	100

## PN25

## BRONZE GATE VALVE

Screwed-over Bonnet, Non-rising Stem  
Threaded ends to BS21 (JIS B0203)

25 bar at 100°C, 10.5 bar at 186°C, P-T rating : See page 01



Fig. PN25H

• Threaded ends to BS21(JIS B0203)

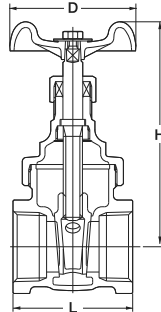

### Materials

Parts	Material
Body	Bronze
Bonnet	Bronze
Stem	Dezincification Resistant Brass
Disc	Dezincification Resistant Brass/Bronze
Gland Packing	Aramid Fibers Graphite

\*Size 1/2 only

### Dimensions

Nominal Size	mm						
	NPS DN	1/2 15	3/4 20	1 25	1 1/4 32	1 1/2 40	2 50
L Threaded end to end		45	50	57	61	67	74
H Height		80	90	105	118	135	159
D Handwheel diameter		50	55	60	70	80	90

## PN25

## BRONZE GATE VALVE

Screwed-over Bonnet, Non-rising Stem  
Solder joint ends to BS 864

25 bar at 100°C, 10.5 bar at 186°C, P-T rating : See page 01



Fig. PN25CH

• Solder joint ends to BS864

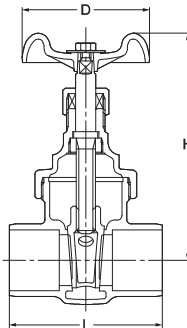

### Materials

Parts	Material
Body	Bronze
Bonnet	Bronze
Stem	Dezincification Resistant Brass
Disc	Dezincification Resistant Brass/Bronze
Gland Packing	Aramid Fibers Graphite

\*Size 1/2 only

**Caution** Solder joint end valves should not be used in service where the temperature of line fluid is higher than the softening point of solder.

### Dimensions

Nominal Size	mm						
	NPS DN	1/2 15	3/4 20	1 25	1 1/4 32	1 1/2 40	2 50
L		46	61	72	78	87	102
H Height		80	90	105	118	135	159
D Handwheel diameter		50	55	60	70	80	90