

Section 7  
**ILLUSTRATIONS AND PARTS LIST**

**7.13 COMPRESSOR DISCHARGE SYSTEM (LS-12 AND LS-16 SERIES)**

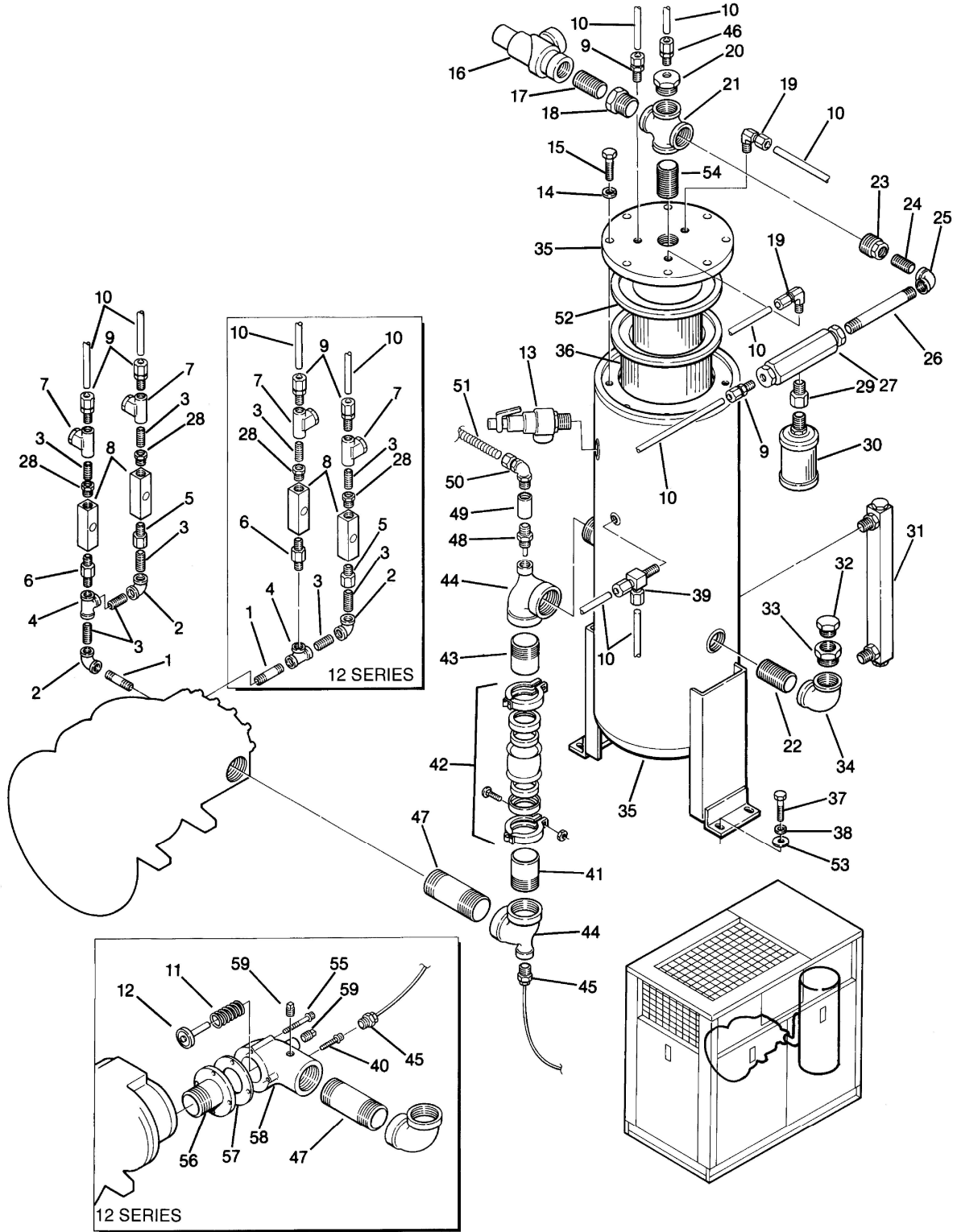

## Section 7

# ILLUSTRATIONS AND PARTS LIST

### 7.13 COMPRESSOR DISCHARGE SYSTEM (LS-12 AND LS-16 SERIES) (CONTINUED)

<i>key number</i>	<i>description</i>	<i>part number</i>	<i>quantity</i>
29	orifice, 1/2"m x 1/2"f x .156	234125-156	1
30	silencer, air 1/2"	041006	1
31	gauge, fluid level without ball check	046558	1
32	plug, o-ring boss sae 1 1/4"	040029	1
33	adapter, filler	020044	1
34	elbow, pipe 1 1/2"	801515-060	1
35	tank, receiver separator	250015-284	1
36	element, separator (primary) (V)	250034-115	1
37	capscrew, 1/2 hex "-13 x 1 1/2"	828608-150	4
38	washer, springlock regular 1/2 "	837508-125	4
39	tee, tube-m 1/4" x 1/4"	810904-025	1
40	capscrew, ferry 3/8" -16 x 1"	828406-100	1
41	nipple, half 2 1/2" x 3"	822840-030	1
42	coupling, flexible 2 1/2" (STD) (VI)	040648	1
	Scoupling, flexible 2 1/2" (KT) (VII)	250007-563	1
43	nipple, half 2 1/2" x 4"	822840-040	1
44	tee, reducing 2 1/2" x 1/2" x 2 1/2" (12 Series)	802210-020	2
	Stee, reducing 2 1/2" x 1/2" x 2 1/2" (16 Series)	802210-020	2
45	gauge, temperature 2"	042582	1
46	connector, flex 1/4"t x 1/4"p	020169	1
47	nipple, pipe 2 1/2" x 6" (12 Series)	822140-060	1
	Snipple, pipe 2 1/2" x 5 1/2" (16 Series)	822140-055	1
48	switch, temperature 240_F nc	040588	1
49	coupling, conduit rigid 1/2"	250007-179	1
50	elbow, 90_ lg-tite 1/2"	846600-050	1
51	conduit, csa flex 1/2"	846315-050	2 ft.
52	element, separator (secondary) (VIII)	250042-861	1
53	washer, pl-b regular unfinished 1/2"	837208-112	4
54	nipple, pipe 1 1/2" x 3"	822124-030	1
55	capscrew, ferry 3/8"-16 x 3 1/4"	828406-325	3
56	adapter, discharge (12 Series only)	012883	1
57	gasket, discharge valve (12 Series only)	040541	1
58	body, discharge valve assembly (12 Series only)	013605	1
59	plug, pipe 1/2"	807800-020	2

(V) For maintenance primary separator element no. 250034-115, order repair kit no. 250034-116.

(VI) For maintenance on flexible coupling no. 040648, order repair kit no. 040649 (2 required).

(VII) For maintenance on flexible coupling no. 250007-563, order repair kit no. 250007-564 (2 required).

(VIII) For maintenance on secondary separator element no. 250042-861, order repair kit no. 250042-862.

---

PLEASE NOTE: WHEN ORDERING PARTS, ALWAYS INDICATE SERIAL NUMBER OF COMPRESSOR.