

7.13 COMPRESSOR DISCHARGE SYSTEM (LS-12 AND LS-16 SERIES)

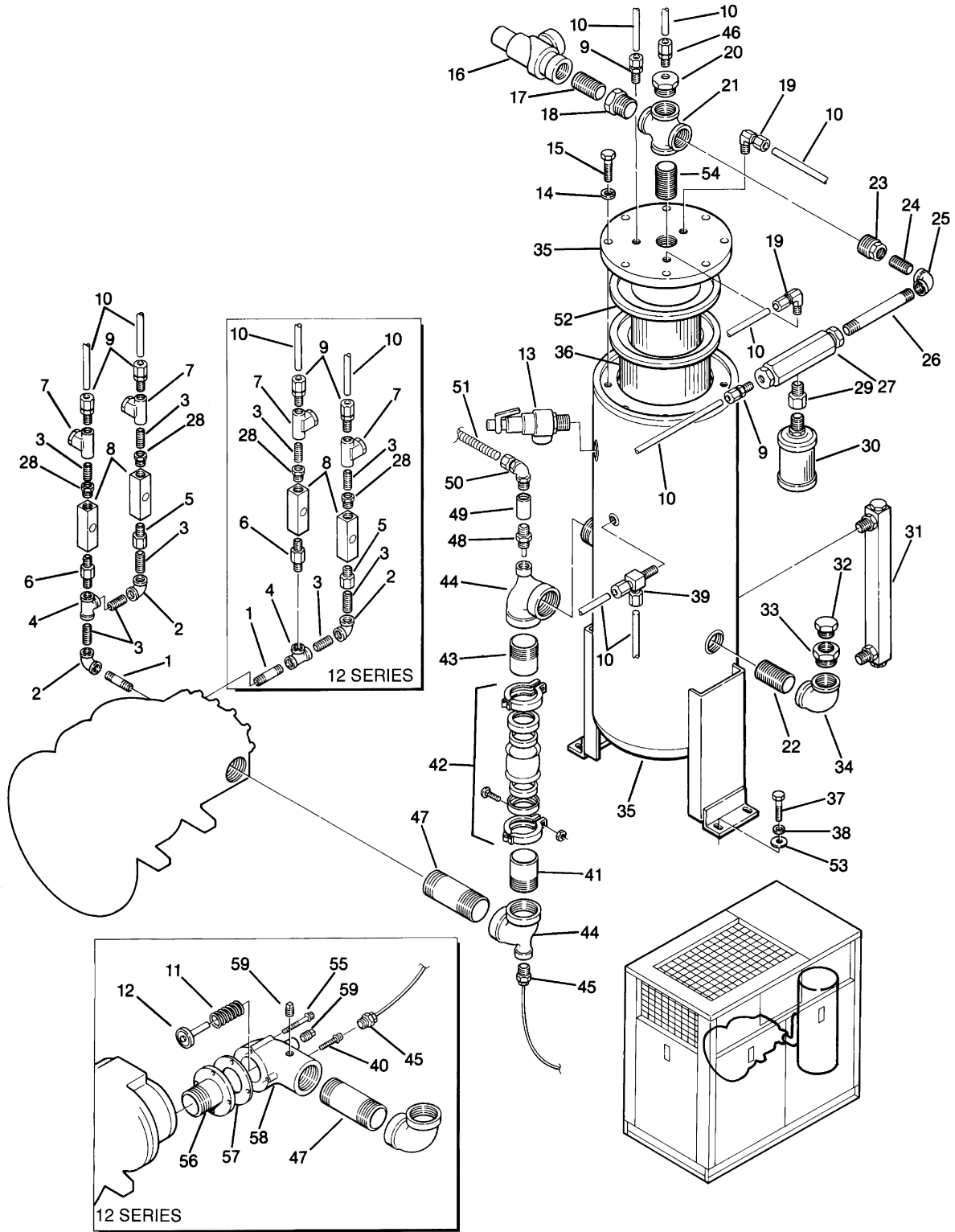

ILLUSTRATIONS AND PARTS LIST

7.13 COMPRESSOR DISCHARGE SYSTEM (LS-12 AND LS-16 SERIES)

<i>key number</i>	<i>description</i>	<i>part number</i>	<i>quantity</i>
1	nipple, pipe 1/4" x 2" (12 Series)	823104-020	1
	Snipple, pipe 1/4" x 1 1/2" (16 Series)	823104-015	1
2	elbow, pipe 90_ 1/4"	801515-010	2
3	nipple, pipe xs 1/4" x close	823204-000	5
4	tee, pipe galvanized 1/4"	804415-010	1
5	orifice, secondary 1/32"	040381	1
6	orifice, primary 3/32"	022033	1
7	strainer, v-type (I)	241771	2
8	glass, sight	046559	2
9	connector, tube 1/4" x 1/4"	810204-025	3
10	tube, 1/4"	841015-004	10.5 ft.
11	spring, discharge valve	233615	1
12	disc, discharge valve	013549	1
13	valve, relief 175 psig (12.1 bar)	248344	1
14	washer, springlock regular 5/8"	837510-156	8
15	capscrew, hex 5/8"-11 x 2" gr8	828210-200	8
16	valve, minimum pressure/check (12 Series) (II)	241581	1
	Svalve, minimum pressure/check (16 Series) (III)	250016-618	1
17	nipple, pipe xs 1 1/4" x close (12 Series)	822220-000	1
	Snipple pipe xs 1 1/2" x close (16 Series)	822224-000	1
18	bushing, reducing hex 1 1/2" x 1 1/4" (12 Series only)	802106-050	1
19	elbow, tube-m 1/4" x 1/4"	810504-025	3
20	bushing, reducing hex 1 1/2" x 1/4"	802106-010	1
21	cross, pipe 1 1/2"	801315-060	1
22	nipple, pipe 1 1/2" x close	822224-000	1
23	bushing, reducing hex 1 1/2" x 1/2"	802106-020	1
24	nipple, pipe 1/2" x close	822208-000	1
25	elbow, pipe 90_ 1/2"	801515-020	2
26	nipple, pipe 1/2" x 7"	822108-070	1
27	valve, blowdown 1/2" npt (IV)	250030-276	1
28	bushing, reducing 1/2" x 1/4"	802102-010	2

(Continued on page 75)

(I) For maintenance on v-type strainer no. 241771, order repair kit no. 241772.

(II) For maintenance on minimum pressure/check valve no. 241581, order repair kit no. 250026-758.

(III) For maintenance on minimum pressure/check valve no. 250016-618, order repair kit no. 250019-444.

(IV) For maintenance on blowdown valve no. 250030-276, order repair kit no. 02250045-132.

PLEASE NOTE: WHEN ORDERING PARTS, ALWAYS INDICATE SERIAL NUMBER OF COMPRESSOR.