

## THROUGH CONNECTORS

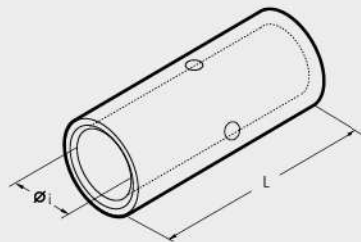

Conductor Size sqmm		Ref.	Dimensions mm		Quantity Box/Bag	Mechanical Tools	Hydraulic Tools
low stranded	Flexible		Øi	L			
0,25+1,5	0,25+1,5	L 03-M*	1,8	15	6.000/100	HN 1	B 15MDE
1,5+2,5	1,5+2,5	L 06-M*	2,4	15	4.000/100		
4+6	4+6	L 1-M*	3,6	22	2.000/100	HN 5	B 35-45MDE B 35-50MDE
10	10	L 2-M	4,6	25	1.000/100		
16	16	L 3-M	5,8	27	1.000/100	HN-A25	HT 45-E
25	25	L 5-M	7,0	29	500/100	TN 70 SE	
35	25+35	L 7-M	8,9	33	400/100	TN 120 SE*	HT 51 B 550E RH 50 B 500E
50	35+50	L 10-M	10,0	37	200/50		
70	50+70	L 14-M	11,3	39	200/50		HT 81-J RHU 81
95	70+95	L 19-M	13,5	43	100/25		
120	95+120	L 24-M	15,2	47	100/25		ECM-H30 RHU 520
150	120+150	L 30-M	16,7	58	50/25		
185	150+185	L 37-M	19,2	64	50/25		HT 120 and tools and heads with 130 kN crimping force
240	185+240	L 48-M	21,1	75	30/15		
300	240+300	L 60-M	23,7	90	20/10		
400	300+400	L 80-M	27,0	94	20/5		
500	400+500	L 100-M	30,3	98	12/1		
630	500+630	L 120-M*	33,4	105	12/1		
800	600	L 160-M*	38,0	112	9/1		
1000	800	L 200-M*	44,0	120	6/1		

\*See page 111

\*Not UL approved

### L-M



L-M range of connectors are designed for jointing low voltage conductors.

Made of electrolytic Copper tube having the same dimension as A-M series lugs: L-M connectors are annealed and electrolytically Tin plated.

They feature an internal taper at both ends to ease the introduction of the conductor and a central stop to ensure correct positioning.

Details of the appropriate crimping tools and dies are shown on pages 178 to 179.

## PARALLEL CONNECTORS

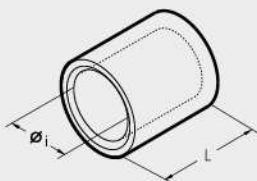

Total Conductor Size sqmm		Ref.	Dimensions mm		Quantity Box/Bag	Mechanical Tools	Hydraulic Tools
low stranded	Flexible		Øi	L			
0,25+1,5	0,25+1,5	L 03-P	1,8	6,0	10.000/100	HN 1	B 15MDE
1,5+2,5	1,5+2,5	L 06-P	2,4	6,0	5.000/100		
4+6	4+6	L 1-P	3,6	9,0	3.000/100	HN 5	B 35-45MDE B 35-50MDE
10	10	L 2-P	4,6	10,5	3.000/100		
16	16	L 3-P	5,8	11,5	2.000/100	HN-A25	HT 45-E
25	25	L 5-P	7,0	13,0	1.500/100	TN 70 SE	
35	25+35	L 7-P	8,9	14,0	500/100	TN 120 SE*	HT 51 B 550E RH 50 B 500E
50	35+50	L 10-P	10,0	16,0	500/100		
70	50+70	L 14-P	11,3	18,0	500/100		HT 81-J RHU 81
95	70+95	L 19-P	13,5	19,0	300/50		
120	95+120	L 24-P	15,2	22,0	200/50		ECM-H30 RHU 520
150	120+150	L 30-P	16,7	26,5	100/50		
185	150+185	L 37-P	19,2	26,5	100/50		HT 120 and tools and heads with 130 kN crimping force
240	185+240	L 48-P	21,1	34,0	60/15		
300	240+300	L 60-P	23,7	43,0	50/25		

\*See page 111

### L-P



Made of electrolytic Copper tube, having the same dimensions as A-M series lugs, L-P connectors are annealed and electrolytically Tin plated.

They feature an internal taper to ease the introduction of the conductor.

Details of the appropriate crimping tools and dies are shown on pages 178 to 179.